



SOLD

LIFE IS PEACHY ON BEECHWOOD!

Don't delay booking your viewing for this fabulous home offering 4 Bedrooms, 2 bathrooms, new kitchen, covered 2 car accommodation, Pool, plus plenty of room for a big caravan or trailer. With all it has to offer and its highly sort after location this family home will sell before you know it!

This home is loaded with all the extras that make a true family home. The layout will suit a family looking for 4 bedrooms and multiple living zones.

3 of the bedrooms have built-ins plus the air-conditioned master.

All rooms have ceiling fans and there are downlights throughout the home.

The front lounge room is generous in size and great spot for TV nights. With so many people either having their own business or the option to work from home, this is the perfect home for either situation.

The stunning brand new kitchen offers plenty of cupboards with 2pac painted cabinetry, electric cooktop, marble looking benchtops, electric oven & dishwasher. This zone services the separate air-conditioned & spacious dining room big enough for those family get togethers. Polished floor boards throughout the home to give it a warm character.

The true bonus is waiting to be discovered outside under the covered outdoor entertaining area that overlooks the low maintenance pool area. Imagine all the entertaining and family fun that you could have in this fantastic area. Dad & the kids won't be disappointed either, with plenty of room for a big caravan or trailer as well as the fenced play area for the kids.

All this plus more on an elevated and very impressive 708sqm block and surrounded by other proud homeowners. Easy walking distance Amberley District State School and local childcare centre as well as Stallard park where you can really kick a ball or just exercise. If nothing else has been good enough, this could be the one. So don't delay, with is highly sort after location and list of features this home won't last long!!

Key Points:

- Big home impressive inside and out back.
- 4 bedrooms plus study area, master has A/C
- Formal front lounge area
- Brand new kitchen
- Security screens to doors

4 BED | 2 BATH | 3 CAR

PRICE:
\$700,001

OPEN FOR INSPECTION:
N/A



Mitchell Wakeham

0400297141

newvoguerealty@atrealty.com.au

www.atrealty.com.au

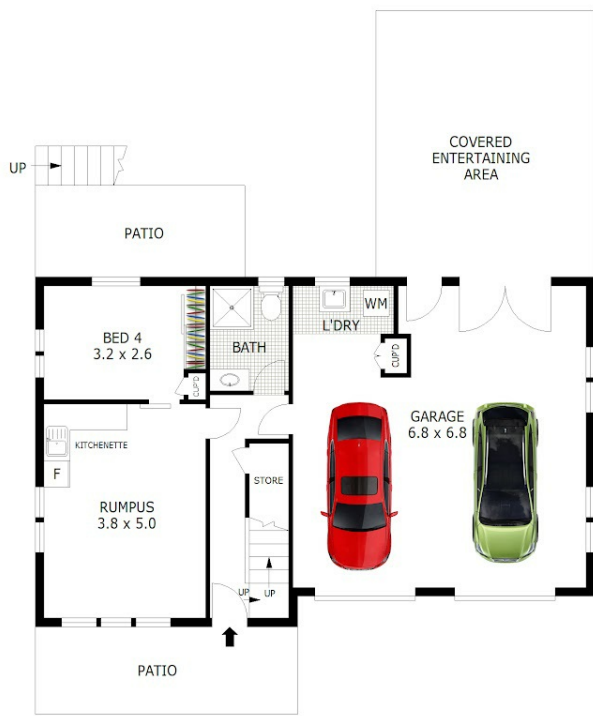

GROUND LEVEL



UPPER LEVEL



Scale in metres. Indicative only. Dimensions are approximate. All information contained herein is gathered from sources we believe to be reliable. However we cannot guarantee its accuracy and interested parties should rely on their own enquiries.

Ground Level	- 43 m ²
Upper Level	- 99 m ²
Garage	- 46 m ²
Entertaining Area	- 31 m ²
Patio	- 22 m ²
Balcony	- 11 m ²
Shed	- 6 m ²
Total	- 258 m²



30 Beechwood Drive, Yamanto

Disclaimer: Please note this floor plan is for marketing purposes and is to be used as a guide only. All dimensions are estimates only and may not be exact measurements.