



**SOLD**

## WINNING LOCATION, EMBRACE THE VIEW...

Offering an outstanding location in Gordonvale, this Wyreema Terrace easy care and low maintenance home enjoys cool breezes and show stopping views...This contemporary design features open plan living, there is A MEDIA ROOM / 4th bedroom and a seamless indoor / outdoor flow to a generous undercover patio. The well-appointed kitchen offers an abundance of workspace and storage, quality appliances and is perfectly situated to interact with family during meal times or when entertaining friends..

Positioned at the rear of the home is the master bedroom with stylish ensuite and walk in robe. The remaining bedrooms with built-ins are positioned at the front of the home with easy access to the family bathroom.

- Bath + Separate Shower To Family Bathroom - Separate Toilet - Split System Air Conditioning  
- Internal Laundry- Double Garage / Vehicle Access To Rear Yard - Fully fenced, Established Gardens & Garden Shed

This home is fitted with 6.6kw of Solar Power ( 25 Panels ) to reduce rising electricity costs and is Wired For A Generator

Located within a 5 minute drive to schools, shops and sporting facilities and only a 25 minute drive to Cairns CBD with a further 10 minutes to Cairns Domestic & International airport.

**3 BED | 2 BATH | 2 CAR**

**PRICE:**  
\$550,000

**OPEN FOR INSPECTION:**  
N/A



**Brian Bolton**  
**0402440098**  
brianbolton@atrealty.com.au  
[www.atrealty.com.au](http://www.atrealty.com.au)

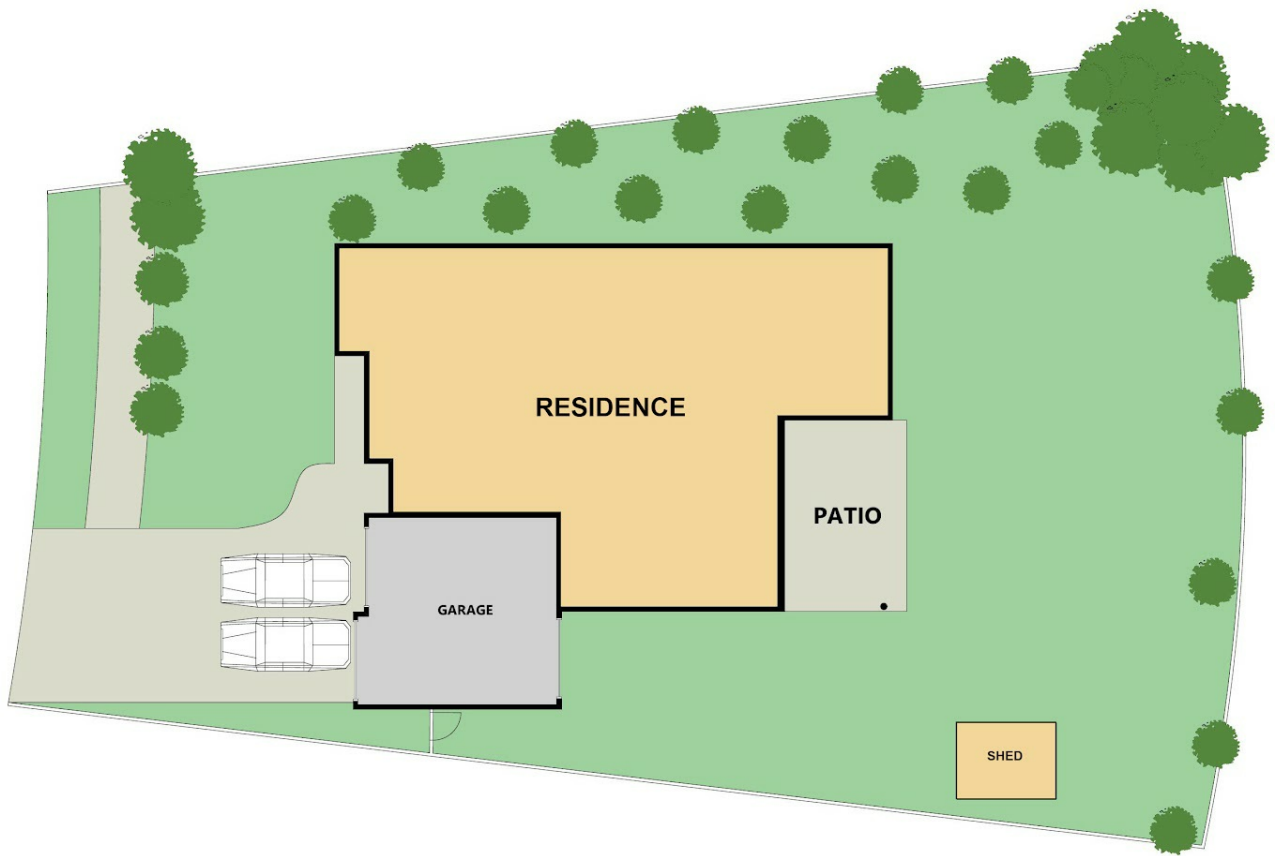

SITE PLAN

Disclaimer: Please note this floor plan is for marketing purposes and is to be used as a guide only. All dimensions are estimates only and may not be exact measurements.