



FOR SALE

MODERN FAMILY FLAIR

Freshly renovated with a flair for modern fashion and family functionality, this freestanding, single level unit is ready to impress with its cutting-edge kitchen and combination of formal and family spaces that encourage you to relax and entertain at home.

Trendy from top to toe, the home's dimensions showcase contemporary style in every room with sleek flooring flowing from the entry foyer through to a lounge and dining room that embraces an L-shaped design and draws natural light in through a beautiful bay window.

Just completed, the kitchen confirms its cutting-edge character with stone benches, 900mm appliances, dishwasher, subway tiled splashbacks, soft close cabinetry plus a breakfast bench.

Set alongside this space, a spacious family room spills out onto the alfresco entertaining deck with café blinds where you can spend time with family and friends whilst cooking up a BBQ or celebrating special occasions.

In all four bedrooms you'll find the comforts of carpet, with the master bedroom boasting a bay window, built-in-robe and renovated ensuite with black trims, accompanied by a like-styled family bathroom, separate toilet and laundry with stone benchtop.

Finished to perfection with the inclusions of ducted heating, split system air conditioning, LED downlights, garden shed plus a single carport that's preceded by space to park a second car.

This haven of style sits close to Park Ridge Primary, Rowville Secondary, Rowville Lakes Shopping Centre, Wellington Village, sporting reserves, buses and the convenience of Monash and EastLink Freeways.

Photo ID required at all open for inspections.

4 BED | 2 BATH | 1 CAR

PRICE:

\$700,000 - \$750,000

OPEN FOR INSPECTION:

N/A



Marko Ghattas

0403170130

marko@atrealty.com.au

www.lucianorealty.com.au

1/274 Dandelion Drive ROWVILLE

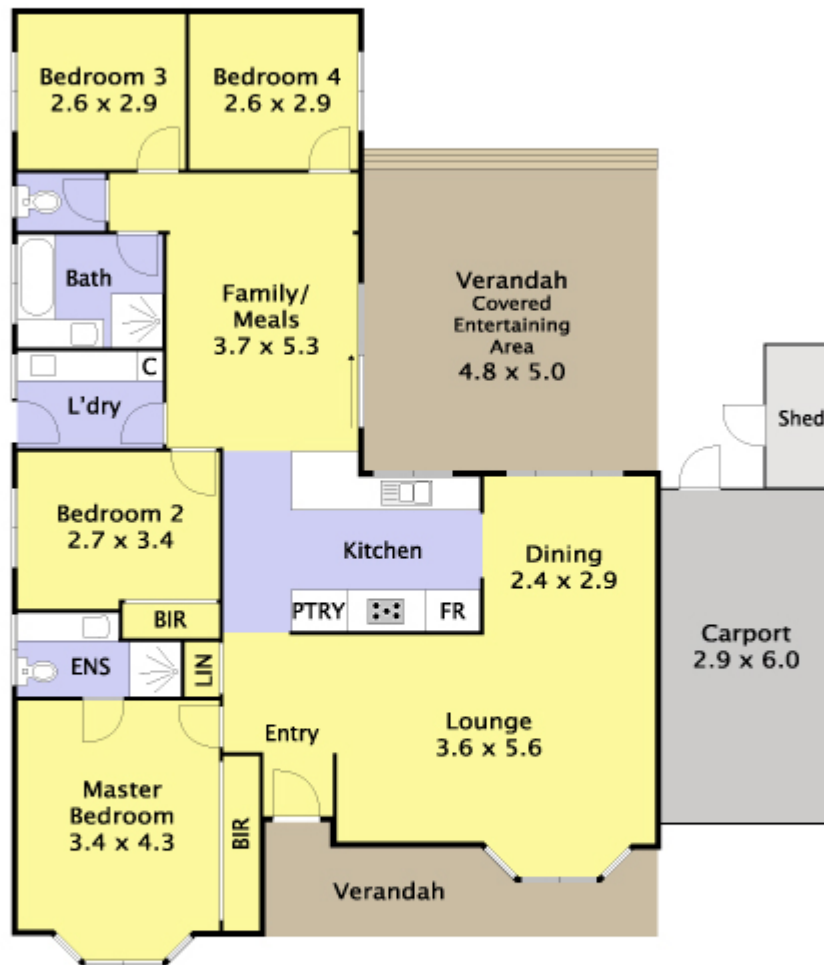

"While every precaution has been taken to verify this information, it does not constitute any representation by the agent or vendor".

Disclaimer: Please note this floor plan is for marketing purposes and is to be used as a guide only. All dimensions are estimates only and may not be exact measurements.