

SOLD

SERENE SERPENTINE

2000 built 4 Bedrooms 2 Bathroom(224m2) set on 2.46Ha
 This gorgeous 6 acres property is in a class of its own. Meander down the winding driveway to this picturesque home. Enter through the original lead light door into the welcoming entry hallway. Featuring high ornate ceilings it is decorated and finished to high standard. With formal and informal living this home is waiting for its new family. All minor bedrooms are queen size, with the master suite being extra large with a huge walk in robe and spacious en-suite bathroom with garden views. The country style kitchen is a joy to present with a large timbertop island, ample bench/cupboard space, dishwasher, large gas cooktop and walk in pantry. For those cold winter days there eis the beautiful wood heater, the home is also fitted with ducted reverse cycle air conditioning.

For those lovely summer days relax by the inground salt water pool or invite the family and friends to the outdoor bar and fire pit. There is so much more seeing is a must.

- *Freestanding double garage and carports
- *9 x 15 x 4 Shed with 3 phase power
- *Solar hot water system.
- * 3 Kw solar power
- *Large wrap around patio to the rear and side of the home.
- *Sparkling below ground pool.
- *90,000 litre concrete rain water tank.
- *3 phase Bore.
- *4 paddocks with good quality pasture and shady trees. just waiting for you to customise for your horses.
- *Tool shed.
- *Fully reticulated manicured lawns and garden areas surround the home
- *Variety of fruit trees.
- *fully fenced

4 BED | 2 BATH | 0 CAR

PRICE:
\$1,190,000

OPEN FOR INSPECTION:
 N/A



Liz Smith
0431926144
 lizsmith@atrealty.com.au
www.atrealty.com.au

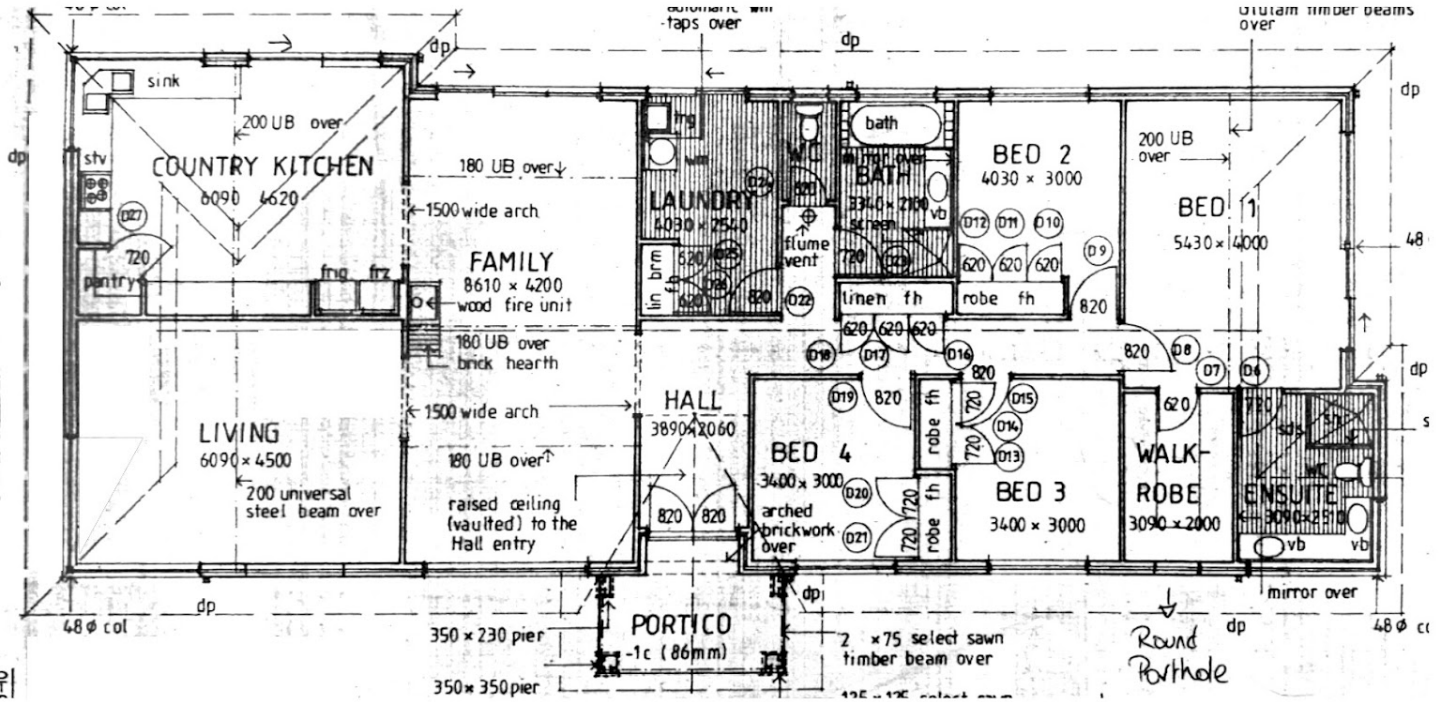

Disclaimer: Please note this floor plan is for marketing purposes and is to be used as a guide only. All dimensions are estimates only and may not be exact measurements.