



SOLD

SOLD! SUPERB HOME IN QUIET CUL-DE-SAC!

SOLD!

Ladies and gentlemen, we have a wonderful lifestyle and investment opportunity for you here! Situated on a 708m2 corner block in a quiet & elevated cul-de-sac is this quality low-set home. The home features 9-foot ceilings throughout that contribute to the sense of light, air & space. The kitchen, ensuite and main bathroom are modern and were renovated only a few years ago. There is an island + a dishwasher in the kitchen, and the home has air-con units + ceiling fans. There is also an office or study at the front of the house, in addition to the 3 built-in bedrooms. Outside, you'll enjoy the private covered outdoor entertainment area overlooking the back yard. The corner block position and the fenced side and front yards are ideal for kids and pets to play. There is a double lockup garage + a drive-through carport that provides access to the back yard. And there is a solar panel system on the roof that helps to keep the electricity bills to a minimum. In terms of position, it's a 'stone's-throw' to IGA Shopping Village + Montessori Child Care Centre. Everything is handy, with 4 shopping centres, several schools and parks and walking trails nearby. And you're only 30 mins to Brisbane CBD, 45 mins to Gold Coast and 10 mins to Bayside beaches. But you'll need to be fast to secure this home, as this price range and location are selling rapidly. So dont miss out! Call now, buy today & enjoy your future. Contact Ben for price & viewing

3 BED | 2 BATH | 3 CAR

PRICE:
\$830,000

OPEN FOR INSPECTION:
N/A



Ben Tafolo
0419260719
tafolo@atrealty.com.au
tafolorealty.com.au

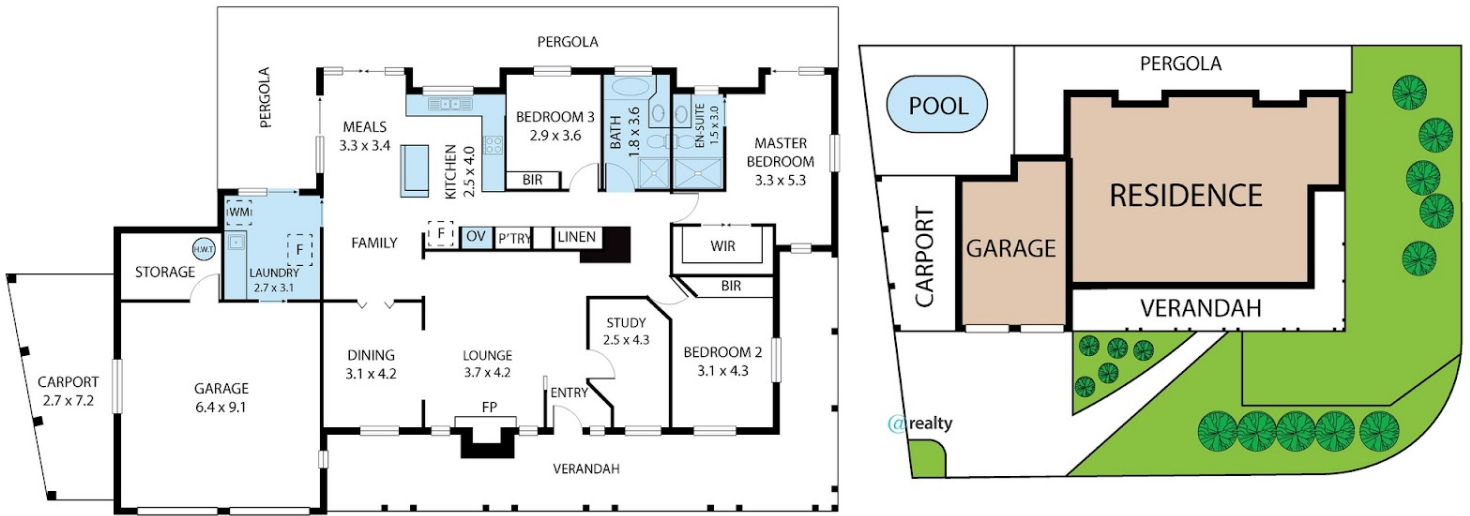

1 Kulara Court, Alexandra Hills 4161

Whilst every attempt has been made to ensure the accuracy of the floor plan contained here, measurements of doors, windows, rooms and any other items are approximate and no responsibility is taken for any error, omission, or misstatement. This plan is for illustrative purposes only and should be used as such by any prospective purchaser.

Disclaimer: Please note this floor plan is for marketing purposes and is to be used as a guide only. All dimensions are estimates only and may not be exact measurements.