



## FOR LEASE

### APPLICATION APPROVED

If you are looking for an ultra modern ground level home in a central location you've gotta see this beauty! Located on a large corner allotment this pristine property has a lot to offer!

It features :

- Ultra modern interior
- 3 bedrooms with built in robes
- Internal laundry with plenty of storage
- Tonnes of louvred windows throughout
- Modern bathroom with frameless shower screen
- Huge galley style kitchen with all the modern cons
- Glass splashback
- Huge rear verandah with loads of privacy
- Dual gate and driveway access for boat or trailer
- Gas cooktop
- Fully tiled throughout
- Fully airconditioned throughout with ceiling cassette in living room
- Built in mirrored robes in all bedrooms
- 5kW solar electricity panels on roof
- Garden shed storage
- Easy maintenance established gardens with mostly lawn and edged garden beds
- Fully fenced

3 BED | 1 BATH | 2 CAR

PRICE:

\$620

OPEN FOR INSPECTION:

N/A



**Nicole Wheeler**

**0417508800**

[nicolewheeler@atrealty.com.au](mailto:nicolewheeler@atrealty.com.au)

[www.atrealty.com.au](http://www.atrealty.com.au)

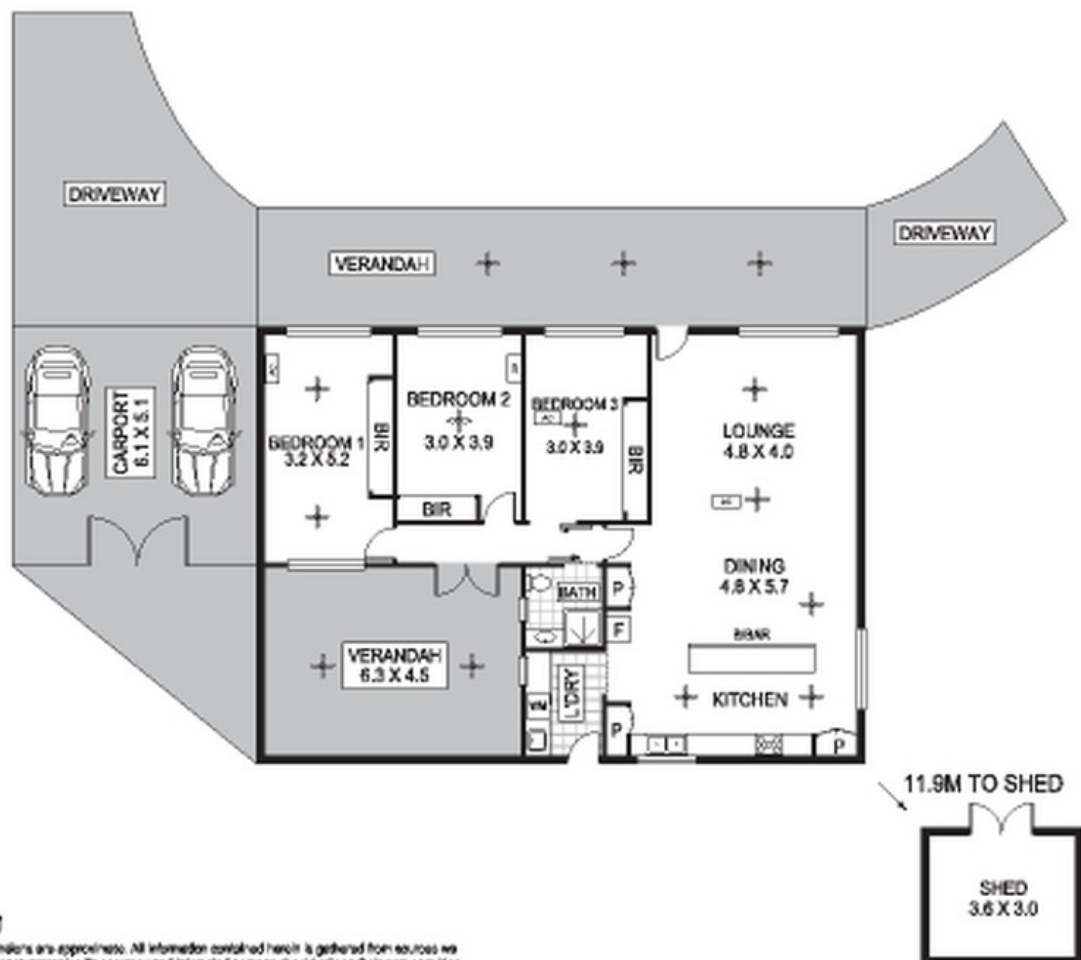

2 Newell Crescent, Jingili

Disclaimer: Please note this floor plan is for marketing purposes and is to be used as a guide only. All dimensions are estimates only and may not be exact measurements.