



**SOLD**

## VACANT POSSESSION AVAILABLE - MOVE STRAIGHT IN

ENJOY BROADWATER LIVING AT ITS BEST IN THIS 6TH LEVEL, CONTEMPORARY APARTMENT, WITH VIEWS TO THE HINTERLAND  
1BED | STUDY | 1BATH | 1CAR | POOL

- Body corp \$95pw (approx)
- Fully equipped kitchen - Stainless-steel appliances
- Master bedroom – triple built in robe & en-suite
- Floor-to-ceiling stacking doors
- Large 11m2 -balcony apartment
- Ducted air-conditioning
- Body Corp approx. \$95pw
- Rental appraisal of \$430pw - \$440pw unfurnished
- Holiday lettings approved
- Pet friendly building
- 1 secure parking
- Onsite manager + security access to building
- Rented til 15th March '22 - But Vacant Possession is offered

1 BED | 1 BATH | 1 CAR

PRICE:  
\$480,000

OPEN FOR INSPECTION:  
N/A



**Francine Setchell**  
**0408143464**  
francine@atrealty.com.au  
[www.atrealty.com.au](http://www.atrealty.com.au)

# Unit 604/430 Marine Parade, Biggera Waters



2 Bed 1 Bath 1 Car

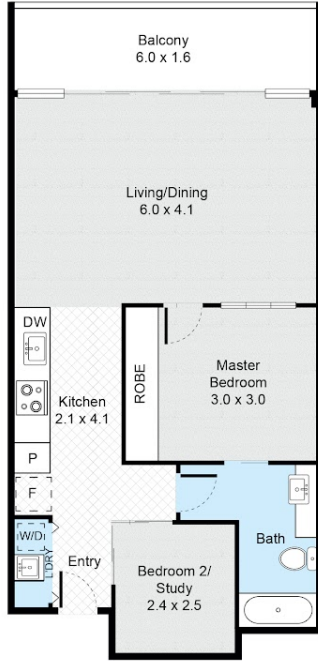

FLOOR PLAN

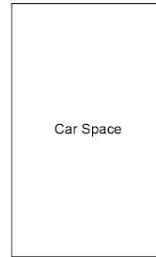

(Not In Position)

CAR SPACE

Internal : 65m<sup>2</sup>  
External : 10m<sup>2</sup>



All information contained herein is gathered from our 3D scanned tours via Matterport. Whilst the 3D scanning technology is very accurate we cannot guarantee its accuracy and interested parties should rely on their own enquiries.

Disclaimer: Please note this floor plan is for marketing purposes and is to be used as a guide only. All dimensions are estimates only and may not be exact measurements.

**Francine Setchell**  
0408143464  
francine@atrealty.com.au  
[www.atrealty.com.au](http://www.atrealty.com.au)

