

# FOR SALE

## DON'T MISS THIS ONE

Townhouse situated at the end of Palm Grove Village Complex giving privacy as soon as you open the front door. Your eyes are captured taken to the outdoor gardens that are so well-maintained through this great complex. The complex is well-designed with the pool and BBQ area in the middle for all to enjoy.

This townhouse comprises of 2 bedrooms upstairs with fans and built in, and a modern updated bathroom consisting of a bath and separate toilet. Downstairs we have open plan living with new fans and new lights that open onto a patio area overlooking this well-manicured garden. The kitchen has great storage and a new Asko dishwasher. We also have a separate powder room and laundry.

- 2 bedrooms with built-ins and fans
- Modern kitchen with new Asko dishwasher
- Modern bathroom with bath and separate toilet
- Security screens and fans
- Powder room downstairs
- Separate laundry
- Oodles of storage under the stairs and a linen cupboard at the top of the stairs
- Garage has direct access into the private courtyard.
- Switchboard has just been upgraded alongside a new hot water system

This home is ideal for the first home buyer or the savvy investor; this property has one of the best locations. Walk to the Nerang Train Station and the bus terminal, which you have only minutes access to from the M1. Also, you can walk to Metricon Stadium to watch a game of football or play a round of golf at the Emerald Lakes golf course. Conveniently located across the road is Campbell Cash and Carry for your shopping needs. Just a short walk to Coles or Woolworths which also has major banks and a post office.

So, with all this don't miss this one! Call today for your inspection or come to the open home.

Angela Hocking 0481554066

2 BED | 1 BATH | 1 CAR

**PRICE:**  
\$395,00 Plus

**OPEN FOR INSPECTION:**  
N/A



**Angela Hocking**  
**0481554066**  
angelahocking@atrealty.com.au  
[angelahockingrealestate.com.au](http://angelahockingrealestate.com.au)

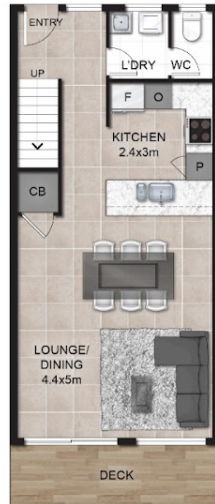

**GROUND FLOOR**

This floor plan including furniture, fixture measurements and dimensions are approximate and for illustrative purposes only.  
@Realty gives no guarantee, warranty or representation as to the accuracy and layout.  
All enquiries must be directed to the agent, vendor or party representing this floor plan.



**FIRST FLOOR**

**29/86 Lawrence Drive, Nerang**

Disclaimer: Please note this floor plan is for marketing purposes and is to be used as a guide only. All dimensions are estimates only and may not be exact measurements.