

67 BEATRIX CIRCUIT, OFFICER, VIC,  
3809



**SOLD**

**CONTEMPORARY MODERN IN THE HEART OF OFFICER!**

3 | 2 | 2

Beautifully designed to achieve low maintenance living and natural simplicity in the heart of Officer in the Arcadia Estate, only 3 years young, this home is perfectly suited to first home buyers, savvy investors and growing families.

Beyond the modern façade, and low maintenance garden, sits this contemporary modern three bedroom home, offering an inviting entry with floating laminate wooden floorboards which will lead you through to the spacious open plan kitchen living and dining zone. The well-appointed kitchen is bound to impress the chef of the household with quality appliances, fixtures and fittings that include a gas stove top & electric oven, stone benchtops, dishwasher and plenty of bench and preparation space as well as a spacious pantry.

Comprising of three great sized bedrooms, the spectacular master suite complete with a walk-in robe and ensuite, the remaining two bedrooms boast an ample amount of space with built in robes that are conveniently positioned around the deluxe bathroom, shower, bath, and separate toilet.

Doors open out to a beautiful, landscaped rear yard with artificial grass for the ultimate low maintenance living and a fantastic, decked pergola area, ready for you to entertain family and friends.

PRICE: \$610,000

OPEN FOR INSPECTION: N/A .

Emily Grainger | 0421929013 | emily@grealestate.com.au | www.grealestate.com.au

# 67 BEATRIX CIRCUIT, OFFICER, VIC, 3809

67 Beatrix Circuit, Officer

3 Bedroom 2 Bathroom 2 Car Parking

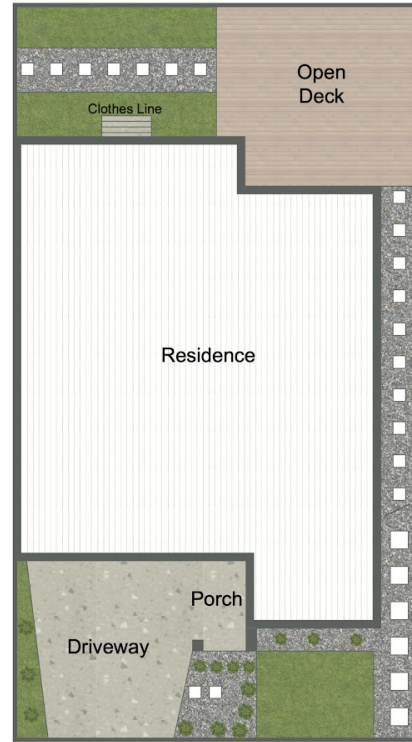

Disclaimer: Whilst every effort has been made to ensure the accuracy of these particulars, no warranty is given by the vendor or the agent as to their accuracy. Interested parties should not rely on these particulars as representations of fact but must instead satisfy themselves by inspection or otherwise.

Emily Grainger | 0421929013 | emily@grealestate.com.au | www.grealestate.com.au