



# FOR SALE

3  | 2  | 2 

169A MUDGEERABA RD, TALLAI, QLD, 4213



**SANDRA LIEBENBERG**  
PROPERTIES GOLD COAST

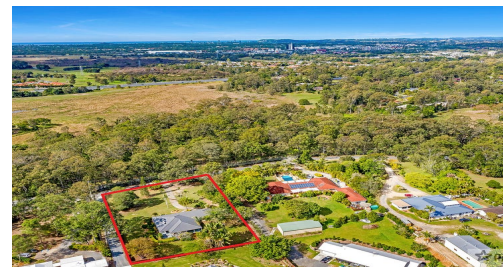

## ACREAGE LIVING SO CLOSE TO EVERYTHING!!!

Located on an amazing acre of flat usable land, this property is a haven for family living. Only minutes to everything & easy access to the M1 direct to Brisbane or Coolangatta. Nestled on a fully usable landscaped acre block with Hinterland views, lush lawns and mature trees.

Magnificent usable land for children to play, the undercover alfresco entertainment overlooks the land with leafy vistas, made for those afternoons spent with family and friends to enjoy. The property offers abundant space to build a shed and a pool.

The generous interiors are complimented by 3 large bedrooms, 2 bathrooms and formal lounge. The chef's kitchen with abundant cabinetry is open plan to the family room offering space for family living.

Be quick to inspect this amazing property, will sell fast!!!

Key features include:

320sqm home under roof offerings loads of potential for a growing family  
Desirable location surrounded by quality homes  
Formal lounge with open plan dining flowing to outdoor undercover patio  
Open plan kitchen with casual dining/family flows through to spacious outdoor alfresco area  
3 bedrooms (Master with double robe and ensuite bathroom), ideal for comfortable family living  
Extra large double garage and abundant off street parking area

**PRICE:**  
\$730,000



**OPEN FOR INSPECTION:**  
N/A

# Sandra Liebenberg // 0437081639

sandra@slpropertiesgc.com.au // [www.slpropertiesgc.com.au](http://www.slpropertiesgc.com.au)



# FOR SALE

3  | 2  | 2 

169A MUDGEERABA RD, TALLAI, QLD, 4213



**SANDRA LIEBENBERG**  
PROPERTIES GOLD COAST

## 169a Mudgeeraba Road, Tallai

Land 3902m<sup>2</sup> | Garage 2 cars | Bedroom 3 | Bathrooms 2 | Living 3  
Total approximate covered Floor Area 320m<sup>2</sup>

 **Professionals**  
Mudgeeraba

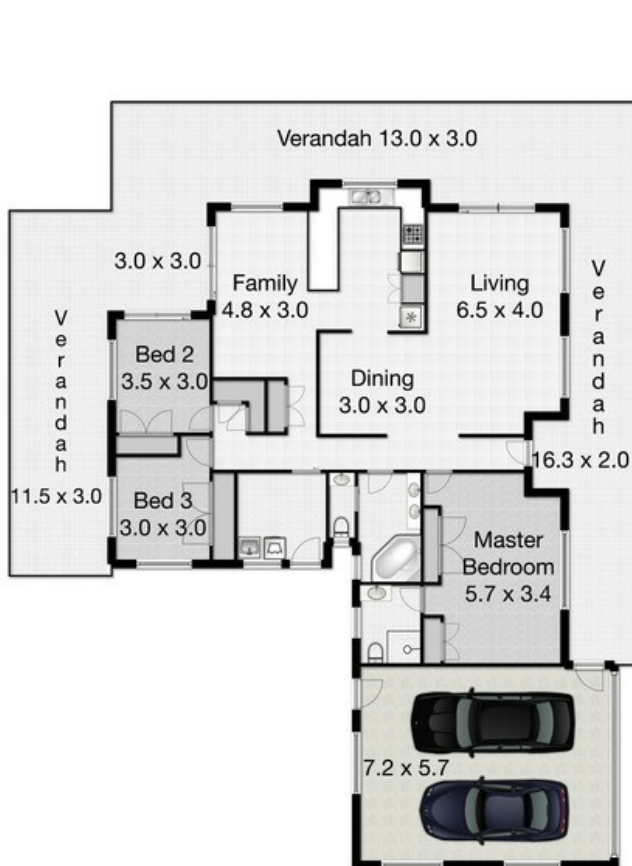

Whilst every attempt has been made to ensure the accuracy of the floor plan. Measurements of doors, windows rooms and any other items are approximate and no responsibility is taken for any error, omission or misstatement. This plan is for illustrative purposes only and should be used as such by any prospective purchaser.

**Sandra Liebenberg // 0437081639**

sandra@slpropertiesgc.com.au // [www.slpropertiesgc.com.au](http://www.slpropertiesgc.com.au)