



# FOR SALE

5  | 2  | 6 

272 WORONGARY ROAD, WORONGARY, QLD, 4213



**SANDRA LIEBENBERG**  
PROPERTIES GOLD COAST



## OWNER INSTRUCTS MUST SELL!!

With a timeless elegance of its own this impressive double story residence is designed to a superb standard and master built, offering grand scale family living in a sought-after location with multiple living areas designed to provide flexible accommodation for the extended family. Located across the road from the Tallai Golf course and positioned in a prime area for a commercial venture (STCA) this property is a winner!

Nestled on a 4007sqm fully usable block, this stunning residence will captivate you. Enjoy the privacy of the landscaped gardens contrasted with the backdrop of majestic trees and natural lush vegetation. Entertain under the enormous covered terrace with hinterland views.

The relaxed open plan family room and chef's designer kitchen with stone bench tops, an abundance of cabinets, impressive island benchtop, double gas stove and stainless steel appliances ensure grand scale entertaining. The custom built media room with built in surround sound and soundproof walls is a family winner.

The upper level of this beautiful home boasts an open plan stylish kitchen with glass top stove and stone bench tops, the spacious living area making this the perfect zone for family living. 4 Spacious double sized bedrooms and a study/5 bedroom. The main bathroom comprises a frameless shower, full bath and separate toilet.

The motor enthusiast is sure to be impressed by the double tandem garage with internal access, 4 bay carport with workshop area and abundance of off-road space to park vehicles. Caravan or

**PRICE:**  
**\$850,000**

**OPEN FOR INSPECTION:**  
**N/A**



# Sandra Liebenberg // 0437081639

sandra@slpropertiesgc.com.au // [www.slpropertiesgc.com.au](http://www.slpropertiesgc.com.au)





# FOR SALE

5  | 2  | 6 

272 WORONGARY ROAD, WORONGARY, QLD, 4213



**SANDRA LIEBENBERG**  
PROPERTIES GOLD COAST

## 272 Worongary Road, Worongary

Land 4007m<sup>2</sup> | Garage 6 cars | Bedroom 4 | Bathrooms 2 | Living 3  
Total approximate covered Floor Area 606 m<sup>2</sup>

 **Professionals**  
Mudgeeraba

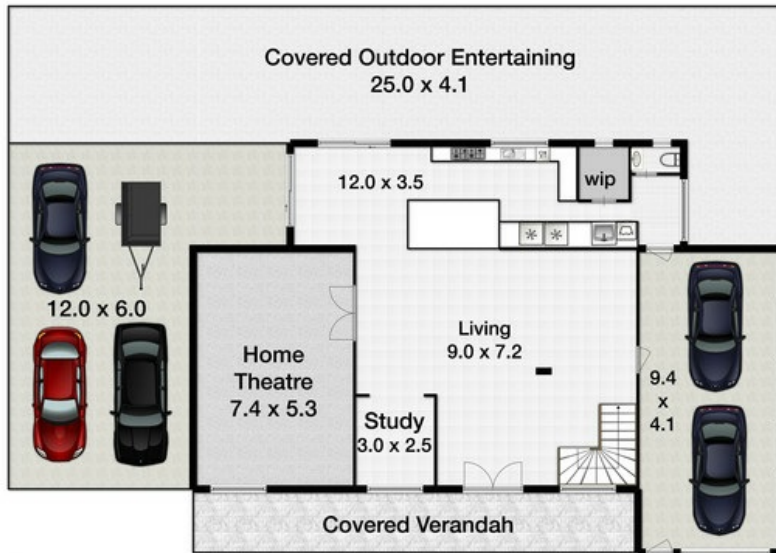

Whilst every attempt has been made to ensure the accuracy of the floor plan. Measurements of doors, windows rooms and any other items are approximate and no responsibility is taken for any error, omission or misstatement. This plan is for illustrative purposes only and should be used as such by any prospective purchaser.

**Sandra Liebenberg // 0437081639**

sandra@slpropertiesgc.com.au // [www.slpropertiesgc.com.au](http://www.slpropertiesgc.com.au)