



FOR SALE

4  | 2  | 5 

40 WALLABY DRIVE, MUDGEERABA, QLD, 4213



SANDRA LIEBENBERG
PROPERTIES GOLD COAST

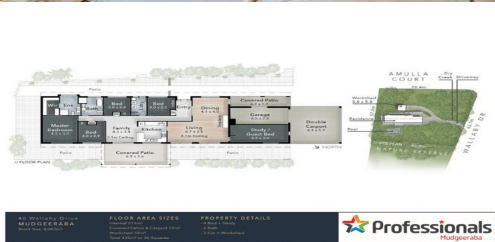

PRIVATE ACREAGE RETREAT

UNDER CONTRACT

Privately positioned and set amid a backdrop of majestic trees, natural vegetation and wildlife including wallabies and kookaburras this amazing property enjoys a tranquil setting and offers space and comfort.

Offering a retreat lifestyle this open, airy home has an easy seamless flow from outside to in. You will fall in love with the gentle natural light filling the vaulted ceilings which makes this home extraordinary. With the focus on comfort and privacy this amazing home has been impeccably maintained. .

At the centre of the home is a beautiful modern chef's kitchen with adjoining dining room. The spacious lounge with a slow combustion fireplace for those chilly winter nights, seamlessly flows out onto the outdoor entertaining space to an extensive covered alfresco area and sparkling pool for all year entertaining.

4 bedrooms, including a master with en-suite and walk in robe - gives every member in your family their own space and plenty of scope to truly make it your own.

Features:

Space and privacy on a magnificent 4003am block

PRICE:
\$730,000



OPEN FOR INSPECTION:
N/A

Sandra Liebenberg // 0437081639

sandra@slpropertiesgc.com.au // www.slpropertiesgc.com.au



FOR SALE

4  | 2  | 5 

40 WALLABY DRIVE, MUDGEERABA, QLD, 4213



SANDRA LIEBENBERG
PROPERTIES GOLD COAST

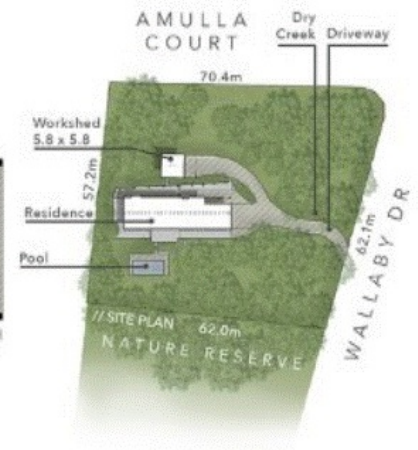

40 Wallaby Drive
MUDGEERABA

Block Size 4,003m²

FLOOR AREA SIZES

Internal 211m²
Covered Patios & Carport 72m²
Workshed 52m²
Total 335m² or 36 Squares

PROPERTY DETAILS

- 4 Bed + Study
- 2 Bath
- 3 Car + Workshed



Sandra Liebenberg // 0437081639

sandra@slpropertiesgc.com.au // www.slpropertiesgc.com.au