

# FOR SALE

4  | 2  | 2 

23 SEHMISH COURT, BONOGIN, QLD, 4213



**SANDRA LIEBENBERG**  
PROPERTIES GOLD COAST

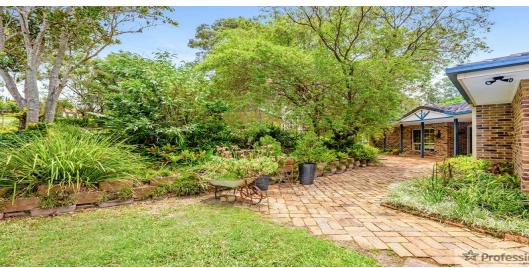

## STUNNING RENOVATED FAMILY HOME IN PRIVATE LOCATION

Designed to embrace its elevation and glorious natural views, this outstanding cherished family home with a beautiful mix of rich character of timber flooring, natural wood fireplace, creates the perfect addition to any formal lounge. The smartly updated renovated white kitchen with an abundance of natural light that sits at the heart of the home, accommodates a variety of family needs.

There is outstanding appeal that is so evident in this home including the spacious master suite offering tranquillity with a stunning en-suite, natural light and more views that are part of the decor. Plus a further three good-sized bedrooms complemented by an exceptional family bathroom that will complete this impressive lifestyle package tailor-made for young families, city professionals or young couples.

Beautifully maintained from front to back, the home is as well-designed, as it is feature-packed and once you see it for yourself, it's easy to see why!  
With wrap around decks, showcasing in-ground pool, maximises the style and space of this stunning home, with excellent entertaining options all year round.

The manicured and rear backyard is also home to massive storage opportunity (under main house) that allows super handy and convenient access.  
With only minutes to your choice of Private and Public schools, Shopping centres and all main stream amenities, blends quality, space & views to create one very special sanctuary.

**PRICE:**  
**\$650,000**



**OPEN FOR INSPECTION:**  
**N/A**

# Sandra Liebenberg // 0437081639

sandra@slpropertiesgc.com.au // [www.slpropertiesgc.com.au](http://www.slpropertiesgc.com.au)



# FOR SALE

4  | 2  | 2 

23 SEHMISH COURT, BONOGIN, QLD, 4213



**SANDRA LIEBENBERG**  
PROPERTIES GOLD COAST

## 23 Sehmish Court, Bonogin

Land 6542 m<sup>2</sup> | Garage 2 cars | Bedroom 4 | Bathrooms 2 | Living 2  
Total approximate Residence Floor Area 205m<sup>2</sup>

 **Professionals**  
Mudgeeraba

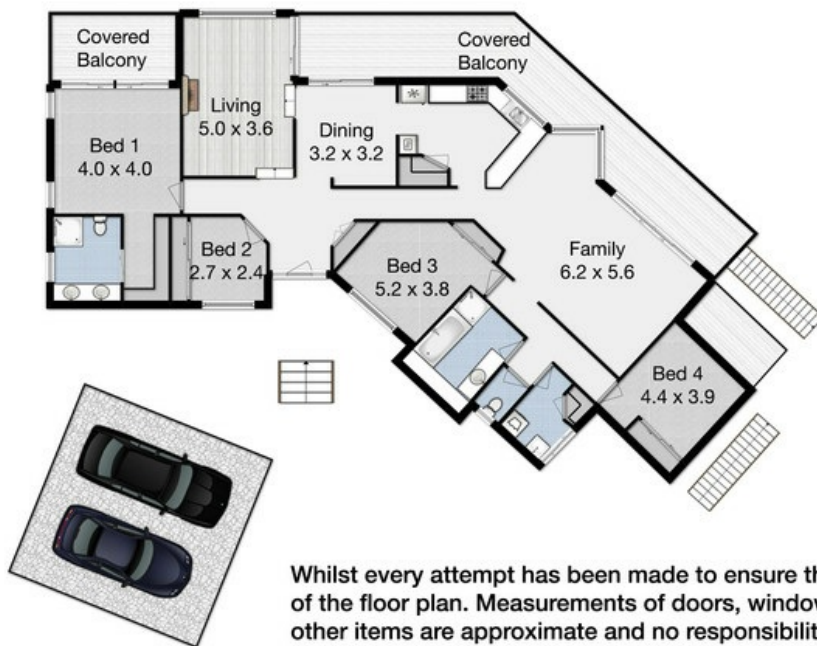
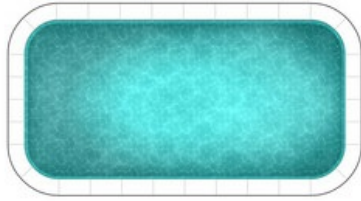

Whilst every attempt has been made to ensure the accuracy of the floor plan. Measurements of doors, windows rooms and any other items are approximate and no responsibility is taken for any error, omission or misstatement. This plan is for illustrative purposes only and should be used as such by any prospective purchaser.



**Sandra Liebenberg // 0437081639**

sandra@slpropertiesgc.com.au // [www.slpropertiesgc.com.au](http://www.slpropertiesgc.com.au)