

FOR SALE

5  | 3  | 3 

7 DALY WAY, WORONGARY, QLD, 4213



SANDRA LIEBENBERG
PROPERTIES GOLD COAST



CONVENIENCE PAIRED WITH TIMELESS ELEGANCE AND DUAL LIVING

With a timeless elegance and charm of its own, this immaculate 5 bedroom home with combined granny flat provides secondary accommodation for guests, adult children or parents and Yes, all this and more situated at the end of a cul de sac and within easy access to all amenities! And when thoughts turn to entertaining this home is an entertainer's dream. With an elegant formal lounge and natural log fire for winter warmth, casual living plus rumpus flowing out to a huge alfresco, with room for the largest of parties, highlighted by manicured rolling lawns, established gardens and in-ground pool, will excite!

You will never be short of entertainment options as family members can enjoy an amazing home perfect for indoor/outdoor entertaining!

The well-designed floor plan offers a stylish free flowing interior and choice of fabulous living spaces with open plan kitchen offering ample storage space, ideal for large families, professionals and those with a busy lifestyle seeking a convenient and private location. A self-contained granny flat merges into the family home providing comfortable secondary accommodation for guests, adult children or parents. Complete with kitchen facilities and a full bathroom, the space extends what already is a very generous home to provide the ultimate in flexibility.

Features:

- . A well thought-out, practical and engaging floor plan for Dual living
- . An ideal home for entertaining WITH vast outdoor covered entertaining area

PRICE:
\$975,000



OPEN FOR INSPECTION:
N/A

Sandra Liebenberg // 0437081639

sandra@slpropertiesgc.com.au // www.slpropertiesgc.com.au



FOR SALE

5  | 3  | 3 

7 DALY WAY, WORONGARY, QLD, 4213



SANDRA LIEBENBERG
PROPERTIES GOLD COAST

7 Daly Way, Worongary

Land 6523 m² | Garage 3 cars | Bedroom 5 | Bathrooms 3 | Living 5
Dwelling approx 380 m² | Covered Terrace approx 170 m²
Total approximate Covered Floor Area 637 m²

 **Professionals**
Mudgeeraba

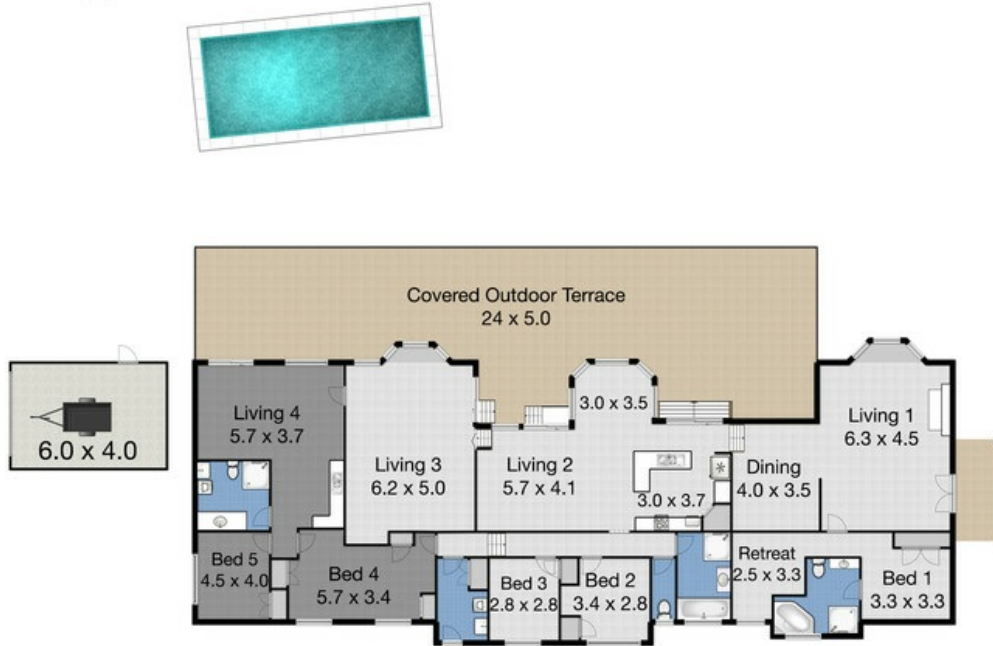

Whilst every attempt has been made to ensure the accuracy of the floor plan. Measurements of doors, windows rooms and any other items are approximate and no responsibility is taken for any error, omission or misstatement. This plan is for illustrative purposes only and should be used as such by any prospective purchaser.

Sandra Liebenberg // 0437081639

sandra@slpropertiesgc.com.au // www.slpropertiesgc.com.au