

# FOR SALE

4  | 2  | 2 

33 GROSVENOR COURT, WORONGARY, QLD, 4213



**SANDRA LIEBENBERG**  
PROPERTIES GOLD COAST

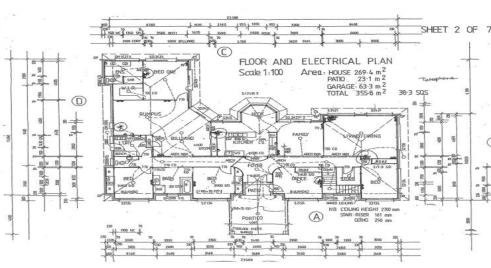
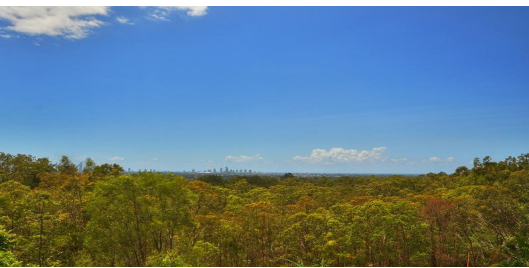

## IT'S ALL ABOUT VIEWS, LOCATION & ENDLESS POSSIBILITIES

4 BED, LARGE STUDY, 3 LIVING, IN-GROUND POOL

Upon your arrival all it takes is a moment to see what makes this ideal family home truly exceptional.

With spectacular unobstructed views over the gold coast and designed specifically to maximize both space and a magnificent panorama, sits this large home in one of the area's finest and most prized locations and only minutes to local shops and elite schools.

The impressive FLOOR PLAN offer an array of formal and casual living areas with a central gourmet kitchen and casual dining specifically designed with a superb outlook towards the Gold Coast Skyline. Perfect for a morning tea or coffee!

The formal living also enjoys impressive Gold Coast views and the separate second family living area conveniently located beside the kitchen leads to Alfresco dining and in-ground sparkling pool- ONCE AGAIN; WITH A MAGNIFICENT GOLD COAST PANORAMIC VIEW!!!!

The gallery-style entrance provides a striking entry to the home and offers the perfect space for showcasing art. There are four spacious double bedrooms, a large study with separate entrance, and two bathrooms, including master with en-suite.

The generous master suite with walk in robe features custom windows capturing the ambiance

# Sandra Liebenberg // 0437081639

sandra@slpropertiesgc.com.au // [www.slpropertiesgc.com.au](http://www.slpropertiesgc.com.au)

PRICE:  
\$750,000

OPEN FOR INSPECTION:  
N/A

