

FOR LEASE

5 🛏️ | 2 🚿 | 2 🚗

4 CREST DRIVE, ELANORA, QLD, 4221



SANDRA LIEBENBERG
PROPERTIES GOLD COAST



FANTASTIC DUAL LIVING HOME WITH OCEAN VIEWS

Elevated off the highly sorted after Crest Drive is this incredibly spacious family home capturing ocean views and pleasant sea breezes. Situated on an impressive block of approximately 862m² and boasting a total of no less than five bedrooms, two bathrooms, two kitchens and low maintenance garden this property is an ideal solution for anyone looking for a home with dual living.

Featuring upstairs:

- Spacious light filled living and dining with timber floorboards
- Adjoining conservatory leads to ocean view entertaining deck
- Neat and tidy kitchen with dishwasher and breakfast bar
- Three bedrooms with built-ins
- Family bathroom
- Sunroom off kitchen/dining

Downstairs

- Self-contained lower level featuring own entry
- Kitchen, lounge/dining with additional rumpus/family room,
- two bedrooms with built in robes
- bathroom, laundry and workshop
- Double carport with gate to drive through to backyard

Located within very close proximity to Local schools, shops and the beach with positioning

PRICE:
\$775



OPEN FOR INSPECTION:
N/A

Sandra Liebenberg // 0437081639

sandra@slpropertiesgc.com.au // www.slpropertiesgc.com.au



FOR LEASE

5  | 2  | 2 

4 CREST DRIVE, ELANORA, QLD, 4221



SANDRA LIEBENBERG
PROPERTIES GOLD COAST

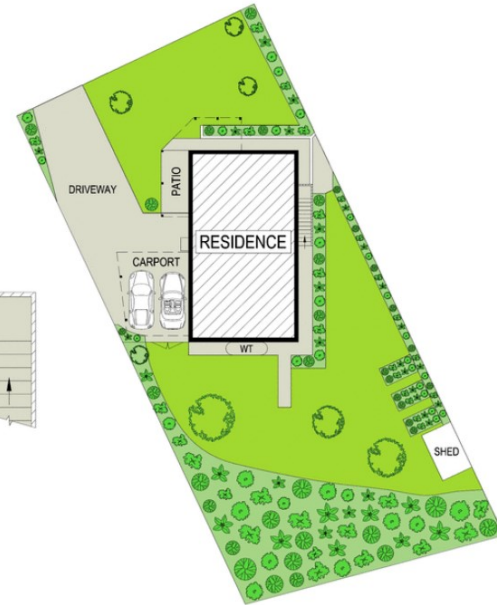

APPROX. INT: 229m²
APPROX. EXT: 750m²
LAND: 862m²



Sandra Liebenberg // 0437081639

sandra@slpropertiesgc.com.au // www.slpropertiesgc.com.au