

FOR LEASE

5  | 3  | 2 

58 PLATEAU CRESCENT, CARRARA, QLD, 4211



SANDRA LIEBENBERG
PROPERTIES GOLD COAST

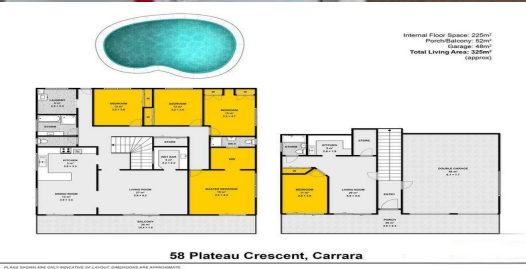

STUNNING FAMILY HOME

Elevated off the highly sorted after Plateau crescent is this incredibly spacious family home. Situated on an impressive block of approximately 715m² and boasting a total of no less than five bedrooms, three bathrooms, two kitchens, low maintenance garden with pool & pizza oven and one oversized auto double lock up garage this property is an ideal solution for anyone looking for a home with dual living potential.

Featuring:

- * Spacious Living upstairs with private bar and sizeable balcony off the upstairs living and dining areas
- * Open Plan Kitchen/dining with dishwasher to kitchen, ceiling fans, air conditioning
- * Five generous bedrooms with air conditioned master featuring a walk through robe and ensuite
- * Huge second living space downstairs featuring a second kitchen, renovated bathroom and air conditioned bedroom
- * Low maintenance rear garden perfect for entertaining with pool and pizza oven
- * Modern bathrooms and separate laundry
- * Stunning entrance hall with extra wide staircase
- * Oversized auto double lock up garage providing internal access to the home and additional off road parking

Located within very close proximity to Emmanuel College, Metricon Stadium and the local convenience store. Positioning providing exceptionally quick access to the M1 for those needing

PRICE:
\$675 per week

OPEN FOR INSPECTION:
N/A

Sandra Liebenberg // 0437081639

sandra@slpropertiesgc.com.au // www.slpropertiesgc.com.au

