

# FOR LEASE

3  | 2  | 2 

1/33 EMERSON DRIVE, BONOGIN, QLD, 4213



**SANDRA LIEBENBERG**  
PROPERTIES GOLD COAST

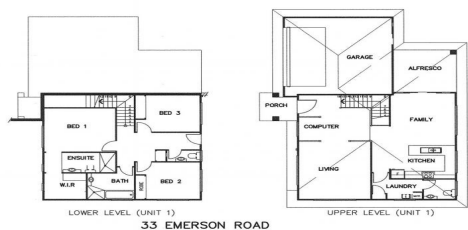

## NEAR NEW IMMACULATE 3 BED HOUSE

Located in the highly sought after "The Aspect" is this recently built two story 3 bedroom house perfect for everyone!

Featuring

- 3 Spacious bedrooms all with Built ins
- Master bedroom with huge ensuite, walk in robe and Air-conditioning
- Open Plan Kitchen/Family room leading onto the undercover Alfresco area
- Stainless steel appliances and dishwasher to Kitchen
- Separate Lounge and computer nook with air-conditioning and overlooking the Bonogin Hills
- Family Bathroom and separate Laundry
- Double lock up garage
- Equipped with ceiling fans, high speed cable internet and no expense spared to fixtures and fittings throughout.

Situated towards the end of a quiet street just a short drive to all the local schools including Somerset, Kings & Clover Hill, all the major shops, sporting fields, parklands, playgrounds as well as easy access to the M1 this property has something to suit everybody!

Call to inspect today as this property wont last long! 0755305255

\* Rent - \$535.00

**PRICE:**

**\$535 per week**

**OPEN FOR INSPECTION:**

**N/A**

# Sandra Liebenberg // 0437081639

sandra@slpropertiesgc.com.au // [www.slpropertiesgc.com.au](http://www.slpropertiesgc.com.au)

