

OPPORTUNITY KNOCKS!

A limited release of 9 prime level building sites, are available for a select few. Home & Land packages from \$495,000



Inspection by appointment.

Contact Lester Drew

on 0459 124 428

email: lesterdrew@atrealty.com



Tristania Street Cornubia homesites

FOR SALE

IN A QUIET RESIDENTIAL AREA

This elevated level corner allotment will sell quickly located in Cornubia a suburb of Logan City, situated 30 kilometres south-east of Brisbane. The nearest largest landmark is the Logan Hyperdome shopping centre - one of the largest undercover shopping malls in Queensland. Cornubia is also close to first class educational institutions John Paul College, Calvary Christian College.

Cornubia is part of the Koala Coast and is home to hundreds of Australian native animals including koalas, wallabies, goannas and various species of birds.

A protected nature conservation area is located in the north-west of the suburb, the 196-hectare (480-acre) nature refuge consists of the former Cornubia Forest Park to the south and land known as the Cornubia Escarpment in the north. It is managed as part of Australia's National Reserve System with objectives that include both conservation of flora and fauna, and recreation such as bushwalking and mountain bike riding. The refuge is also managed under a Koala Nature Refuge Agreement with the state government.

Cornubia Park Sports Centre located at 146 Bryants Road, Shailer Park, constructed in 1998, was Logan City's first indoor sports centre. Over the years, Cornubia Park has become a well established name throughout Logan City and the sporting community. Cornubia Park continues to be an ideal sport, recreation and leisure centre to a large range of groups, organisations, and community members.

Cornubia Park features the following facilities:

- Four international standard courts
- Health and fitness centre - operated by Lifestyle Health Club
- Air-conditioned meeting room
- Café

Host to Logan City Council's award winning Logan McDonald's* School Holiday Sports Program.

Cornubia Park is a part of the Cornubia Park Sports Precinct. Neighbouring the indoor sports centre are soccer fields operated by Loganholme FC, home to the Loganholme Lightning. The netball courts behind Cornubia Park Sports Centre are operated by Shailer Park Netball Association.

0 BED | 0 BATH | 0 CAR

PRICE:

Sold by Lester Drew

OPEN FOR INSPECTION:

N/A



Lester Drew

0459124428

lesterdrew@atrealty.com.au

www.atrealty.com.au

Tristania Street Cornubia

A golden opportunity for early birds.

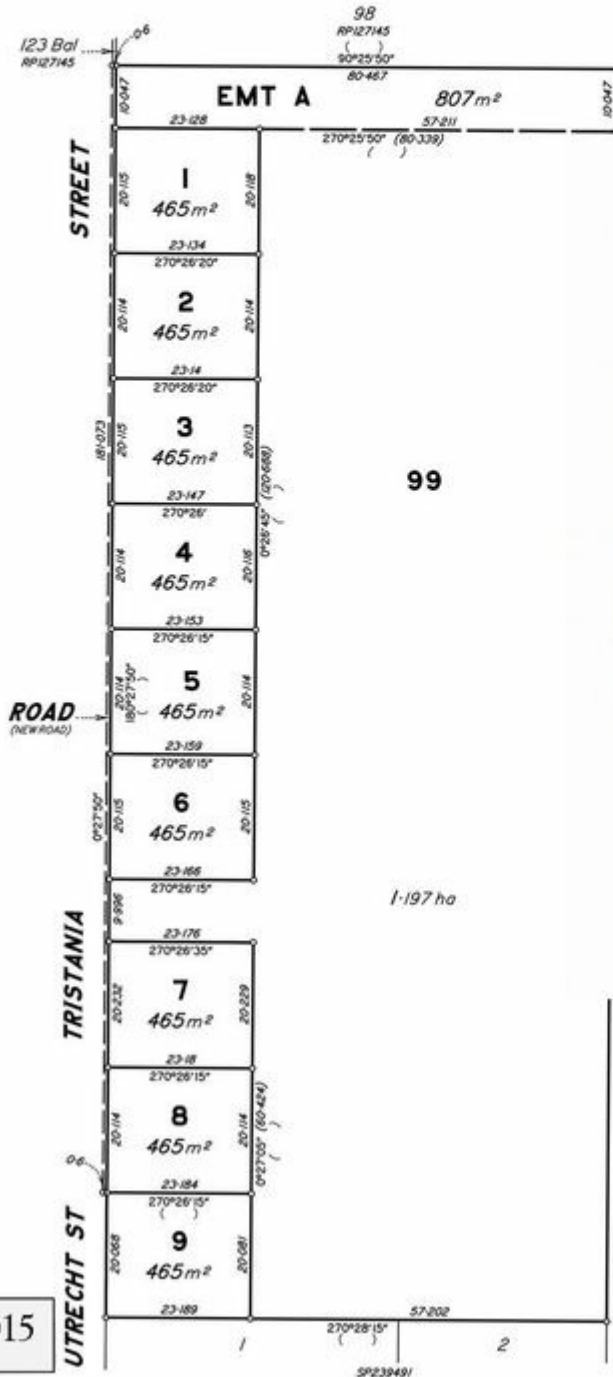

Site Plan



Contact

GAILES Lester Drew
0459 124 428

email

lesterdrew@atrealty.com.au

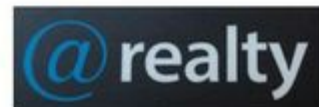

28.08.2015

Disclaimer: Please note this floor plan is for marketing purposes and is to be used as a guide only. All dimensions are estimates only and may not be exact measurements.