



SOLD

INSTANTLY APPEALING, PERFECTLY POSITIONED

Whether you're looking to downsize in style, a bullet-proof investment or your first home, this single-level home could be the answer! Light-filled and neutral tones, a open tropical design; stylish kitchen featuring central island stone bench, appointed quality De'Longhi appliances including gas stove, oven and dishwasher.

Accommodation includes four comfortable robed bedrooms, master with large walk in wardrobe and ensuite, main bathroom with a separate toilet. Complemented outdoors with covered patio and established gardens. Highlights include 60cm porcelain tiles, new carpet, split system air conditioning, security screens, fans, double remote lock up garage, fully fenced yard with space for a pool.

This coveted street is moments away from James Cook University, Smithfield Shopping Centre and Smithfield State High School.

Rental appraisal \$590 per week aprox

4 BED | 2 BATH | 2 CAR

PRICE:
\$550,000

OPEN FOR INSPECTION:
N/A



Zoe Wicks
0477114778
zoewicks@atrealty.com.au
www.atrealty.com.au

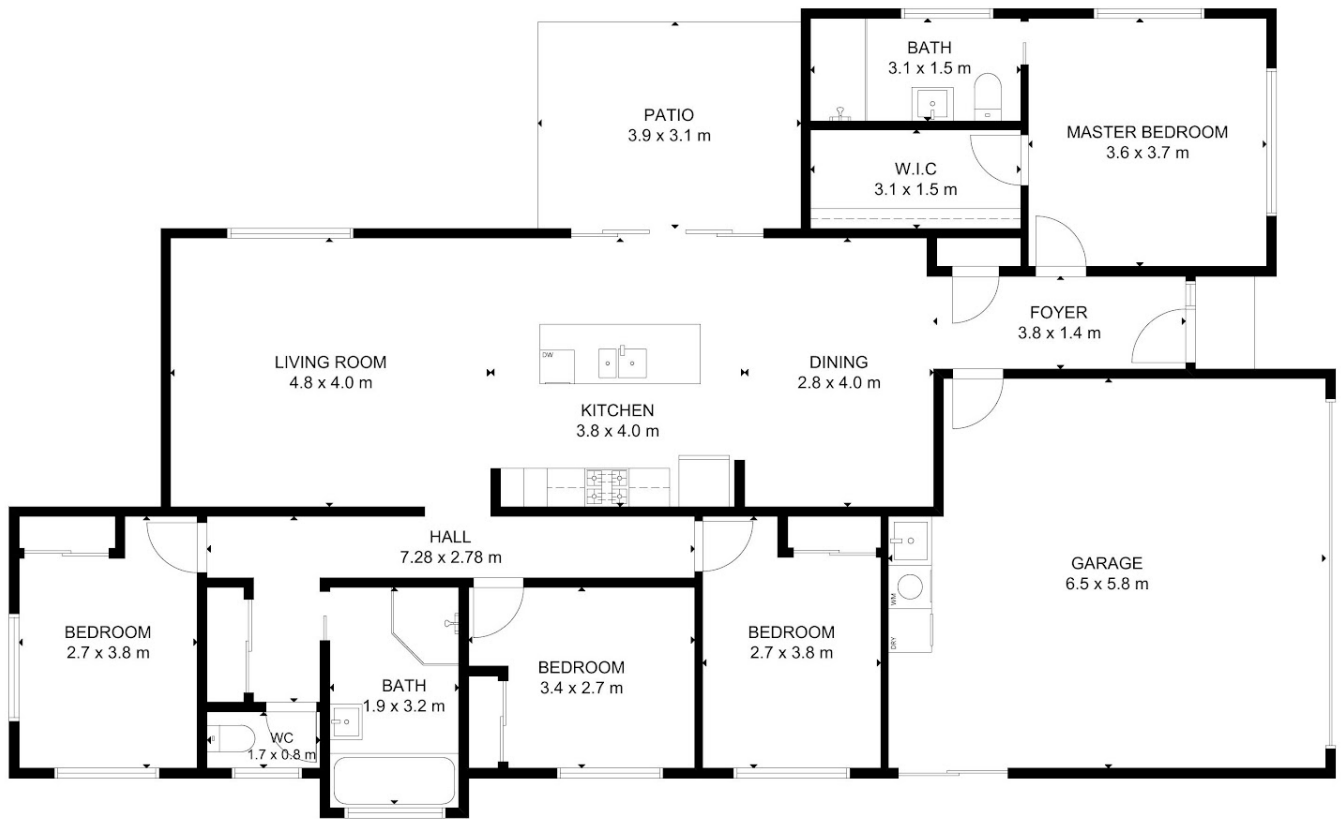

FLOOR 1

GROSS INTERNAL AREA
 TOTAL: 127 m²
 FLOOR 1: 127 m²
 EXCLUDED AREA: GARAGE: 36 m², PATIO: 12 m²
 SIZE AND DIMENSIONS ARE APPROXIMATE, ACTUAL MAY VARY.

Zoe Wicks | @realty
 Real Estate

Disclaimer: Please note this floor plan is for marketing purposes and is to be used as a guide only. All dimensions are estimates only and may not be exact measurements.

Zoe Wicks
 0477114778
 zoewicks@atrealty.com.au
 www.atrealty.com.au

