



**SOLD**

## SOLD! GREAT HOME, QUIET LOCATION + BIG SHED!

SOLD!

Ladies and gentlemen, we are excited to present to you this superb lifestyle and investment opportunity!

Situated on a 607m<sup>2</sup> block at the end of a quiet cul-de-sac is this solid, low-set 3 bedroom brick home.

The kitchen is central to lounge and dining areas and is handy to the private outdoor entertainment area.

There is full side access to the large, grassy, low-maintenance back yard and a double shed out the back.

There's also a solar power system on the shed roof and a full double carport in front of the single garage.

Walk to local schools, shops, parks, bus. Only 30 minutes to Brisbane CBD and 45 minutes to Gold Coast.

Capalaba Park and Central are 4 minutes away and the property is only 10 minutes to Bayside's beaches!

This home is ideal for first-time buyers, investors or renovators, and homes at this price are selling FAST!

So don't miss out folks! Call now, buy today and enjoy your future! Contact Ben Tafolo for a price guide.

**3 BED | 1 BATH | 5 CAR**

**PRICE:**  
\$640,000

**OPEN FOR INSPECTION:**  
N/A



**Ben Tafolo**  
**0419260719**  
tafolo@atrealty.com.au  
[tafolorealty.com.au](http://tafolorealty.com.au)

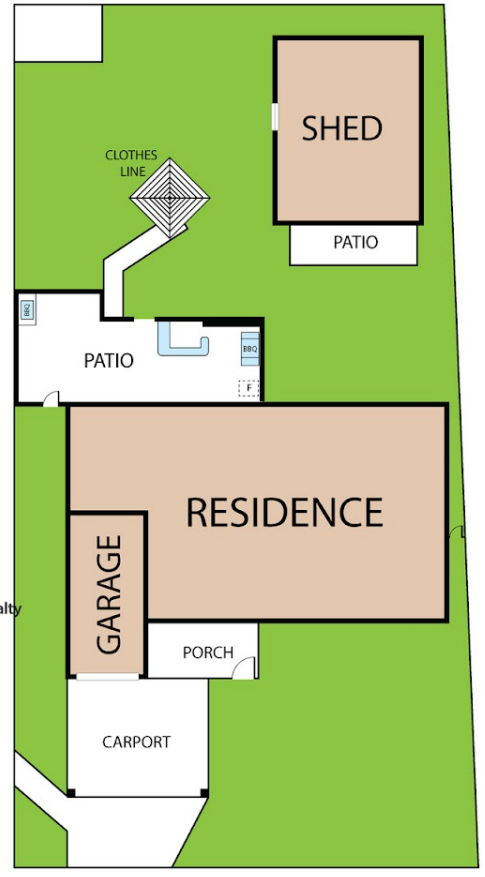

2 Diana Street, Capalaba 4157

Whilst every attempt has been made to ensure the accuracy of the floor plan contained here, measurements of doors, windows, rooms and any other items are approximate and no responsibility is taken for any error, omission, or misstatement. This plan is for illustrative purposes only and should be used as such by any prospective purchaser.

Disclaimer: Please note this floor plan is for marketing purposes and is to be used as a guide only. All dimensions are estimates only and may not be exact measurements.

**Ben Tafolo**  
0419260719  
tafolo@atrealty.com.au  
tafolorealty.com.au

