



FOR SALE

SHOW STOPPER !!

Contact your local Agent Tricia 0457 314 206

What an exciting unique opportunity to purchase this truly delightful expansive home.

Set on a corner block with a double carport on one side and additional side access to a large garage / workshop for those extra vehicles.

Freshly painted throughout with beautiful new floorboards and carpet this property has the WOW factor. On Entry you will be impressed with the gorgeous, spacious, open plan sunken living and dining room with high ceilings. The Modern kitchen is centrally located with breakfast bar and a second meals area and offers plenty of storage and bench space with a walk-in pantry and dishwasher for the keen cook. Down the hallway and you will find more storage and 3 generous light filled bedrooms with large picture windows, new carpet and built-in robes. The fourth bedroom is positioned at the opposite end of the home and has a multitude of options with a private entry. A home office is a bonus with another entrance or utilize the space for the kids to play.

A large, updated bathroom, with bath, separate shower and toilet is on offer. A bonus 2nd toilet is a must for convenience.

Through the separate laundry to an expansive outdoor under cover area for year-round entertaining.

With a friendly fence you can utilize the front yard as well. Sit under the shady tree and watch the kids play or garden in the raised veggie patch.

Heating and cooling and ceiling fans is just some of the many extras on offer.

A great location with the freeway access only a moments' drive. The local Southgate Shopping Centre has all the necessary shops and facilities. Public and private schools and transport all close by and the beautiful southern beaches only a 5-minute drive you will feel like everything is just at your fingertips.

06

RLA 271071 RLA 269823

4 BED | 1 BATH | 3 CAR

PRICE:

590,000-640,000

OPEN FOR INSPECTION:

N/A



Tricia Kernahan

0457314206

tricia@atrealty.com.au

tfkrealestate.com.au

RLA: 269823

Approximate Area SQM
LIVING AREA: 180 SQM

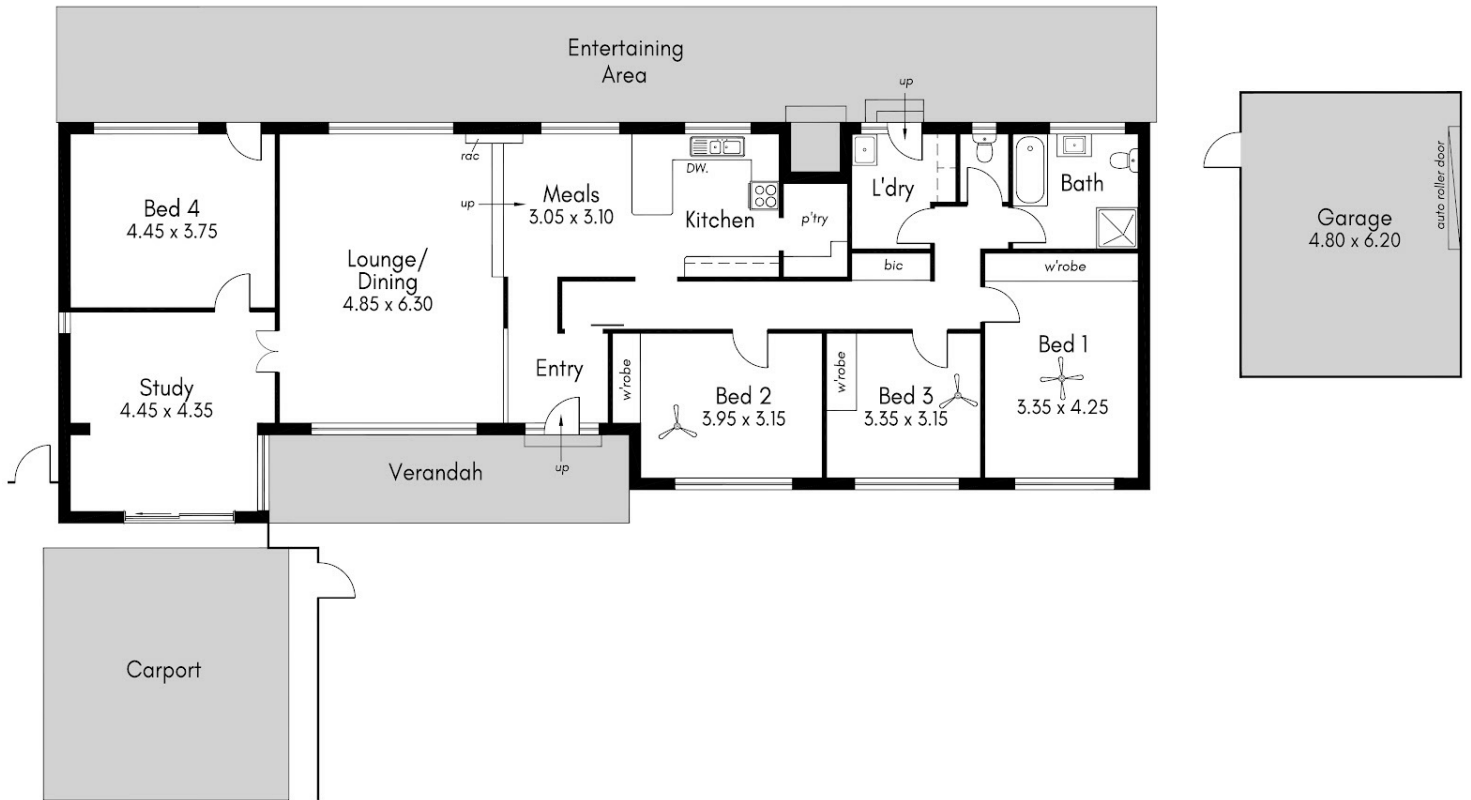

10 Acre Avenue, Morphett Vale

DISCLAIMER

This drawing is for illustration purposes only. The information contained is NOT intended to be part of any contract. All measurements are approximate and details intended to be relied upon should be independently verified. While every effort has been made to verify the correct details in this drawing, neither the agent, vendor or illustrator accept responsibility for any errors, omissions, or wrongful inclusions. Exterior objects may not be in position.

Disclaimer: Please note this floor plan is for marketing purposes and is to be used as a guide only. All dimensions are estimates only and may not be exact measurements.