

**SOLD**

## REFRESHED FAMILY HOME WITH ROOM TO GROW

We invite you to inspect this recently renovated family home proudly positioned in the semi-rural, family friendly town of Tahmoor. Catering to a growing family, it offers expansive living spaces that spread over a generously proportioned floor plan. The use of space has been maximised to combine comfort and practicality, accompanied by its newly refreshed interiors & quality features that cleverly compliment the home's calming neutral tones all while encompassing its superb setting on a fantastic sized block.

### Features Include:

- Four generously proportioned bedrooms all with built in robes
- The master suite is equipped with a walk in robe & an ensuite
- Formal living room
- Open plan family, kitchen & dining room with a study nook
- Well appointed kitchen with ample cupboard & bench space
- Gas cooking
- Stainless steel appliances including a dishwasher
- Pantry
- Island bench includes a breakfast bar overlooking the dining area
- Bright & airy bathroom is equipped with a bathtub
- Newly installed flooring throughout
- Newly installed blinds throughout
- Freshly painted throughout
- Spacious laundry includes a built in linen closet
- Split system air conditioning
- Entertaining paved area
- Fantastic sized backyard
- Double lock up garage
- 626.7sqm block

This tastefully designed home is located in the semi rural town of Tahmoor, a growing suburb that is known for its family friendly community, nestled away from the hustle & bustle of busy city life & is rich in its history with the old railway station is close by, a family favourite with the kids or any train enthusiast who admires the old steam trains! Also within close proximity are the shopping complexes where you will find all your needs, restaurants, cafes, local schools & child

4 BED | 2 BATH | 2 CAR

PRICE:  
\$835,000

OPEN FOR INSPECTION:  
N/A



**Bobby Reynolds**

**0432173566**

[bobby.reynolds@atrealty.com.au](mailto:bobby.reynolds@atrealty.com.au)

[agencycentralwilton.com.au](http://agencycentralwilton.com.au)

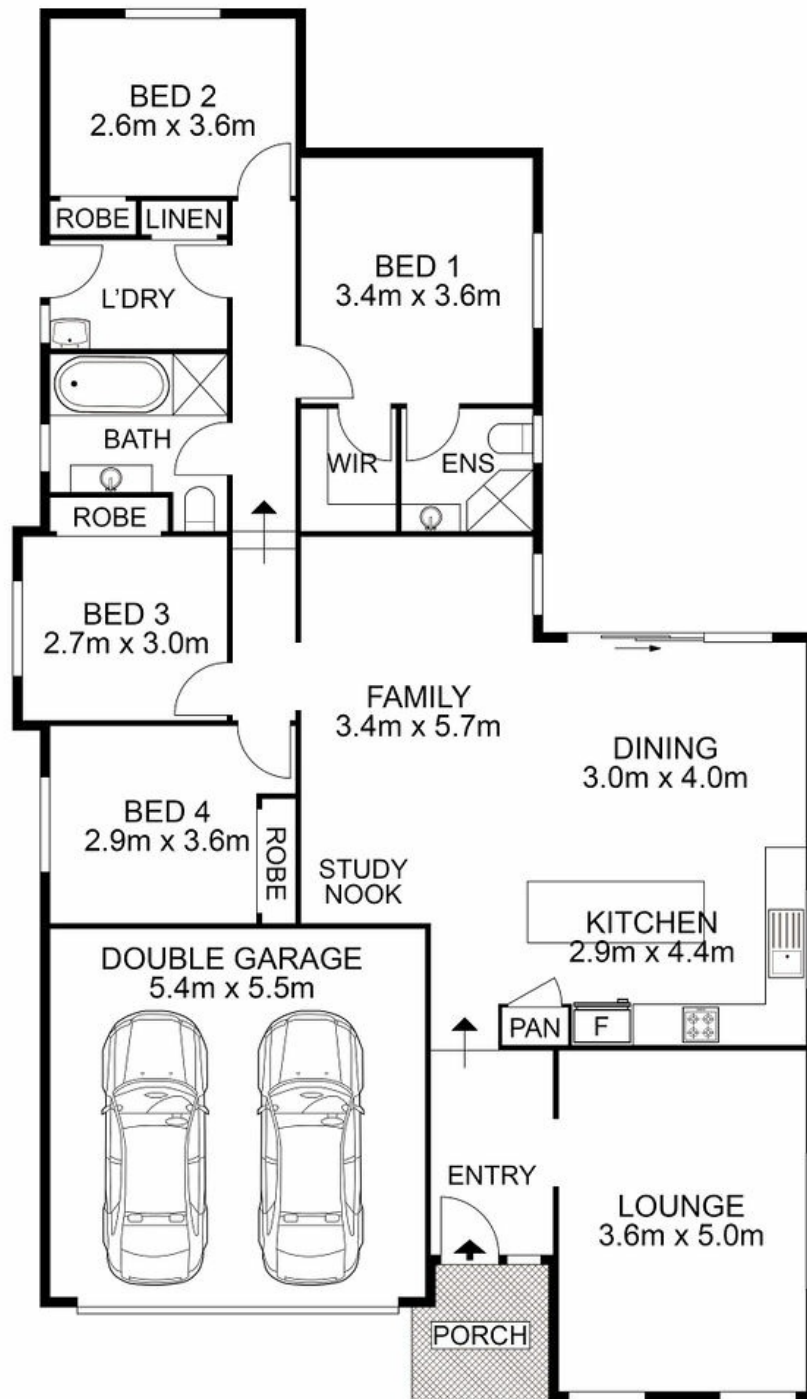

 AGENCY

Disclaimer: Please note this floor plan is for marketing purposes and is to be used as a guide only. All dimensions are estimates only and may not be exact measurements.

55B Moorland Road, Tahmoor

**Bobby Reynolds** All measurements are approximate • Drawn for marketing purposes only

0432173566

bobby.reynolds@atrealty.com.au

agencycentralwilton.com.au

