



FOR LEASE

BRIGHT AND BEAUTIFUL TOWN HOUSE.

This freshly refreshed and beautifully presented double storey townhouse is waiting to be seen or to be called your home.

Featuring

- two good sized bedrooms with built-ins to both
- large combined lounge and dining areas
- neat and tidy bathroom
- updated kitchen with ample storage and glass splashback
- an internal laundry
- a private and gated front courtyard with low maintenance grassed area
- tiling downstairs and floorboard throughout upstairs and stairs
- split system air conditioning
- off-street parking to a secure carport

ONLINE inquiry policy -

All email & online inquiries received from this website will not be attended to if contact numbers & email addresses are not provided.

To be able to view the property we require you to register. We also encourage you to complete a T-app application prior to viewing.

APPLY NOW BY ENTERING THIS LINK INTO YOUR BROWSER:

<https://t-app.com.au/wish>

Disclaimer: The information presented has been furnished from sources we deem to be reliable. We have not verified whether or not the information is accurate and do not accept any responsibility to any person and do no more than pass it on. All interested parties should rely on their own inquiries in order to determine the accuracy of this information.

2  | 1  | 1 

PRICE:
\$380



Prajwal Bhattarai
0423743157

prajwal@propticonnect.com.au
propticonnect.com.au

FIRST FLOOR

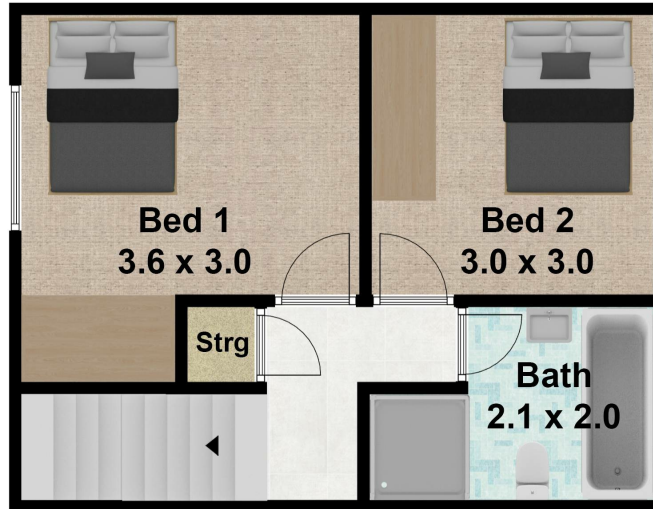

GROUND FLOOR

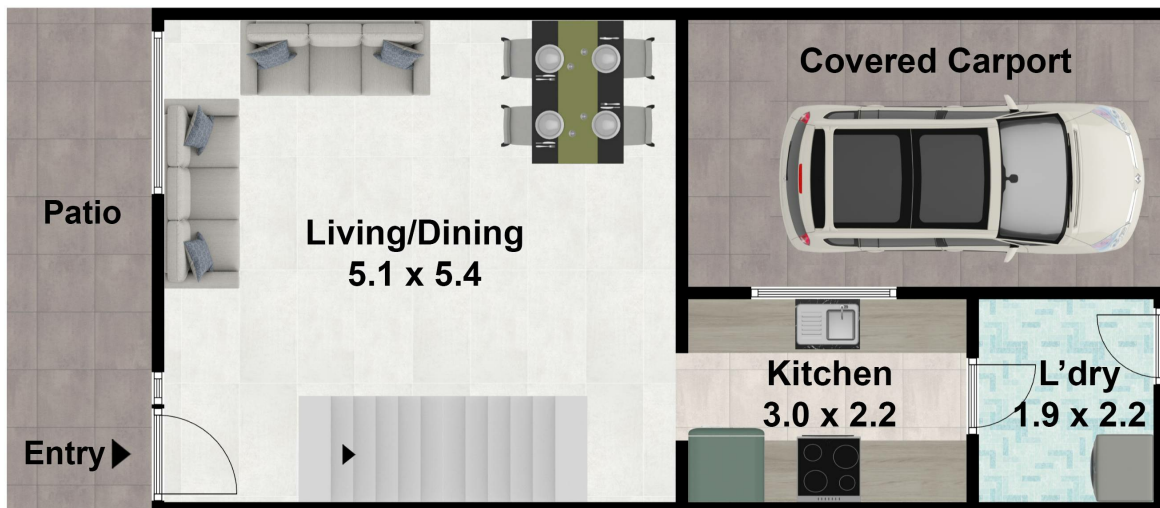

4/4-6 Cumberland Road Ingleburn, NSW 2565

DISCLAIMER: THIS IS FOR ILLUSTRATIVE PURPOSES ONLY. ALL DIMENSIONS ARE APPROXIMATE AND IT DO NOT CONSTITUTE PART OF ANY LEGAL DOCUMENT.
All dimensions are approximate. Actual dimensions may vary. Floor plan prepared by uploadit.com.au 61401957996

