

ADDRESS UPON REQUEST



SOLD

AFFORDABLE 'FRONT ROW' MOOLOOLABA WITH PANORAMIC VIEWS

As they say: Location Location Location! Enjoy the spectacular panoramic views from inside this fully furnished 8th level apartment in the award winning 'Landmark' building perfectly positioned directly opposite Mooloolaba's iconic main beach ... night-light views are a bonus.

The price tag is sure to appeal & though not large in size the apartment is fully self contained complete with exclusive car parking & separate laundry whilst featuring granite bench tops, ducted A/C & marble flooring to add further appeal. Currently holiday let the apartment generates excellent returns given its views & the building's unsurpassable location.

With a fully equipped gymnasium, sauna room, rock pool & spa plus rooftop viewing entertainment area incl. BBQ's & outdoor hot tub, Landmark Mooloolaba offers fantastic facilities for both guests & live-in owners.

Contact Michael anytime to arrange a private inspection pending availability.

1 BED | 1 BATH | 1 CAR

PRICE:
\$395,000

OPEN FOR INSPECTION:
N/A



Michael Cornilsen
0414233026
michaelc@atrealty.com.au
www.atrealty.com.au

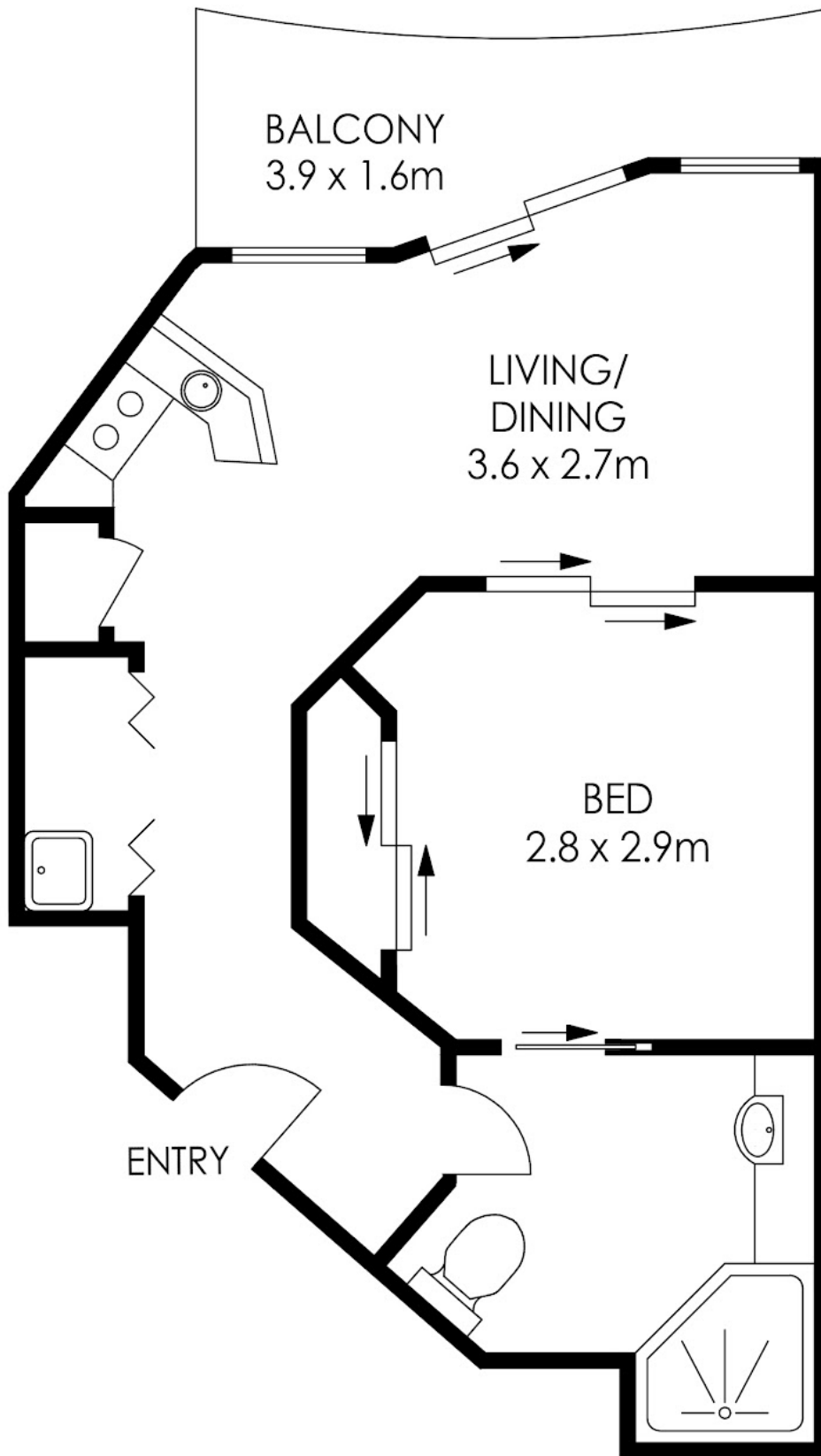

Disclaimer: Please note this floor plan is for marketing purposes and is to be used as a guide only. All dimensions are estimates only and may not be exact measurements.

ARTIST IMPRESSION ONLY: While every attempt has been made to ensure the accuracy of this floor plan's areas and measurements of doors, windows, rooms and all other items are approximate and no responsibility is taken for any inaccuracy or omission. This plan is for illustrative purposes only and should only be used as such by any prospective purchaser. www.fratterphoto.com

Michael Cornilsen
0414233026

michaelc@atrealty.com.au

www.atrealty.com.au

INTERNAL : 38m²
EXTERNAL : 5m²
TOTAL : 43m²

