



SOLD

RURAL LIVING AT IT'S FINEST...ON 1600M2

This magnificent home is established on a double residential block amounting to over 1600m2 of land providing you and your family ample room to grow and entertain family and friends.

- * 4 bedrooms with BIR, master with WIR
- * 2 bathrooms
- * Walk in linen cupboard / storage room
- * Stunning new Kitchen, all new appliances, plenty of storage and large bench space
- * Wood fire heating plus two split systems
- * Undercover, entertaining, Bbq deck area
- * Kids playground
- * Double garage with extra work room
- * Carport for the extra cars, caravan or trailers
- * Wood shed, Veggie garden and fruit trees

Features-

Solar panels for low energy costs. New flooring throughout the home. Room for the kids and dogs to run and play.

A short drive to the blue rock lake- take in the serenity, perfect for a spot of fishing or a swim. Its newly built all abilities playground with barbeques and picnic tables for you to enjoy the views and take in all Willow Grove has on offer. Furthermore, Willow Grove Primary is only a 2-minute walk from home.

Big day at work and don't feel like cooking? Well, no problem as The Irish is within walking distance for your convenience, enjoy a full menu and a refreshing beverage.

This home continues to impress, so come see it for yourself while its still available, call @realty Property Sales Gippsland to book an inspection today.

The information about this property has been supplied to us by the property owner, while we have no cause to doubt its accuracy, we provide no guarantee. We cannot attest to the functionality of any fixtures, fittings, or inclusions to the property. Land and apartment dimensions and floor/site plans are supplied by third parties. Typing mistakes and omissions transposing can occur, we provide to assist but make no representation. Buyers must carry out their own due diligence.

4 BED | 2 BATH | 4 CAR

PRICE:
\$650,000

OPEN FOR INSPECTION:
N/A



Mel Ahearn
0409183763

mahearn@atrealty.com.au

atrealtypropertysalesgippsland.com.au

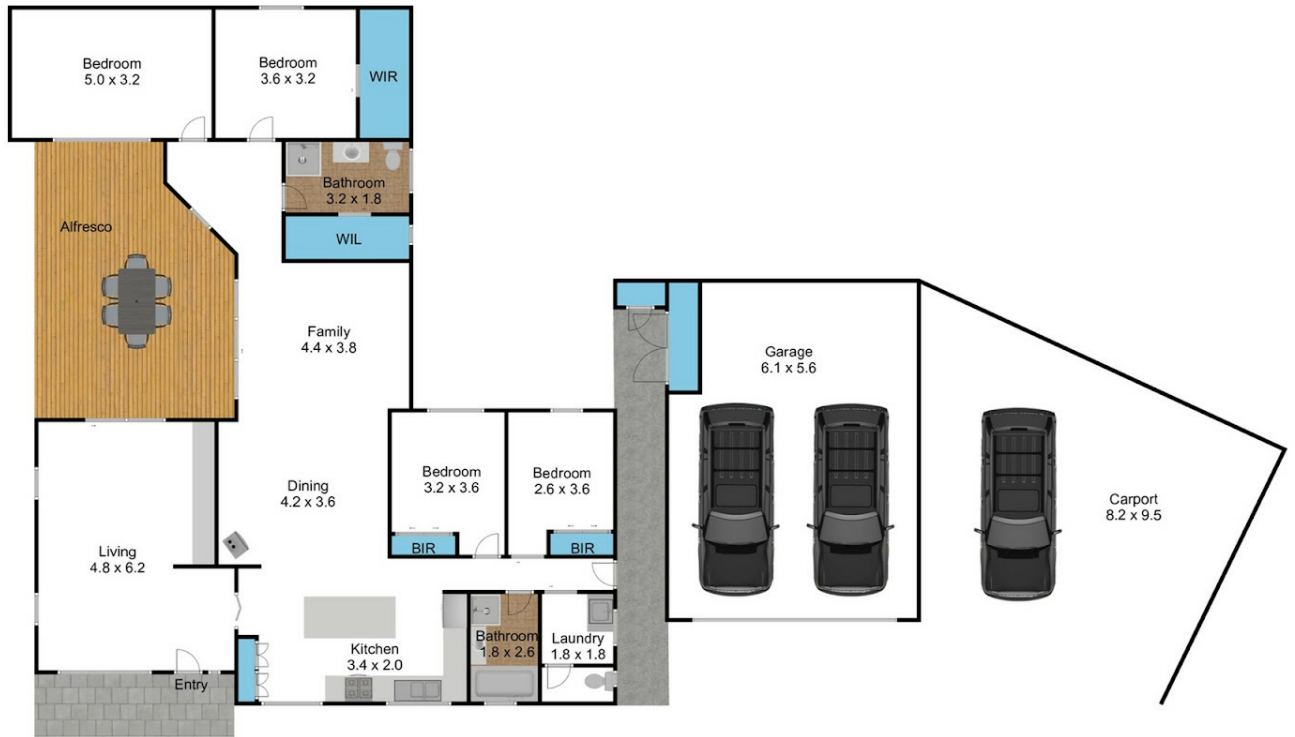

11-13 Moe-Willow Grove Road - Willow Grove



Disclaimer: Please note this floor plan is for marketing purposes and is to be used as a guide only. All dimensions are estimates only and may not be exact measurements.