



SOLD

**SOLD BY MEL @REALTY PROPERTY SALES
GIPPSLAND**

No need to wait to build, move into your new home NOW....

Set on a 680m2 in the new popular Mitchell Grove Estate, this stunning new build home is ready for you to unpack and move in.

The home draped with quality offers 4 spacious bedrooms, 2 separate living zones, fantastic outdoor living and garage.

The stylish central kitchen features island bench with stone benchtops, 900mm wide stainless steel freestanding oven and cooktop, large walk in pantry with water to fridge. The master bedroom has a walk in robe, and ensuite. Three good-sized bedrooms all with BIR and are serviced by the central bathroom. Outdoor living is easy with the undercover alfresco, large, low maintenance lawns and gardens, and with plenty room for the kids to play safely. An Oversized double garage that includes direct home access, remote roller doors and rear access via single car roller door, excellent for caravan/boat storage. Keep comfortable all year round with the ducted gas heating and ducted evaporative cooling.

Everything is done for you! Comes with builder's warranty and you may be eligible for the First Home Owners Grant.

The information about this property has been supplied to us by the property owner, while we have no cause to doubt its accuracy, we provide no guarantee. We cannot attest to the functionality of any fixtures, fittings, or inclusions to the property. Land and apartment dimensions and floor/site plans are supplied by third parties. Typing mistakes and omissions transposing can occur, we provide to assist but make no representation. Buyers must carry out their own due diligence.

4 BED | 2 BATH | 2 CAR

PRICE:
\$600,000

OPEN FOR INSPECTION:
N/A



Mel Ahearn
0409183763

mahearn@atrealty.com.au

atrealtypropertysalesgippsland.com.au

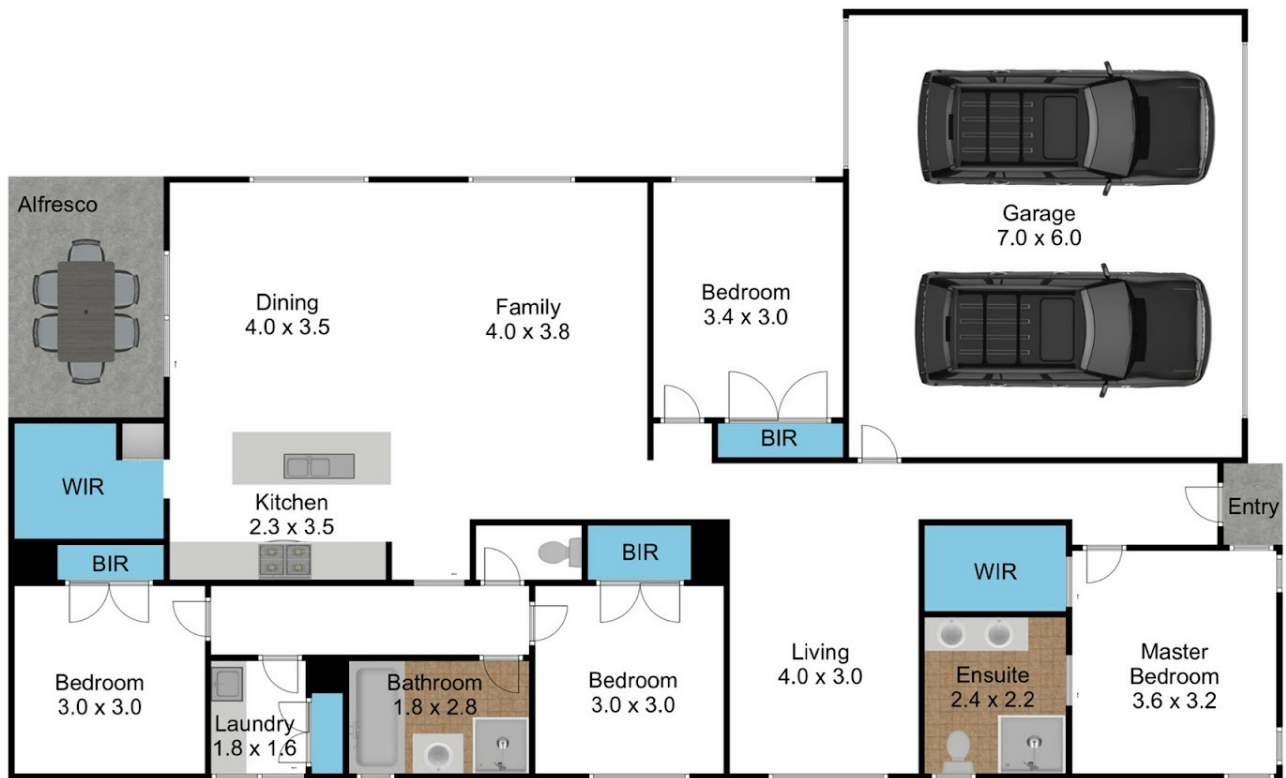

11 Grampians Drive - Moe



Disclaimer: Please note this floor plan is for marketing purposes and is to be used as a guide only. All dimensions are estimates only and may not be exact measurements.