



SOLD

HIDDEN RETREAT

Are you looking for a relaxing and quiet getaway from our busy lifestyle? This inviting natural bush landscape comprising 53 acres is approximately 10 minutes from the Batchelor General Store. So private- with no one else in sight! There are only a few neighbors not to be seen.

A natural boundary is the road and surrounding fire breaks.
This 6x11 shed is a home to the residents, combining an open area to enjoy.
Access is via a door and a large side roller door to assist.
Power is via a generator – for lights and fans.
The shed has an attached front verandah cover to protect the house and act as an outdoor entertainment area.
Water from the water tanks is sufficient - for the overhead outdoor shower.
Bedrooms can be placed where the next buyer sees fit.
There is a kitchen area to the rear of the shed.
Furniture would stay with the property.
There is a portaloo to assist.

So if you are looking for some land and some privacy - this block would be ideal. It is definitely worthy of a viewing- close to amenities but hidden away. Ring to make an appointment.

0 BED | 0 BATH | 0 CAR

PRICE:
\$197,000

OPEN FOR INSPECTION:
N/A



Nicole Wheeler
0417508800
nicolewheeler@atrealty.com.au
www.atrealty.com.au

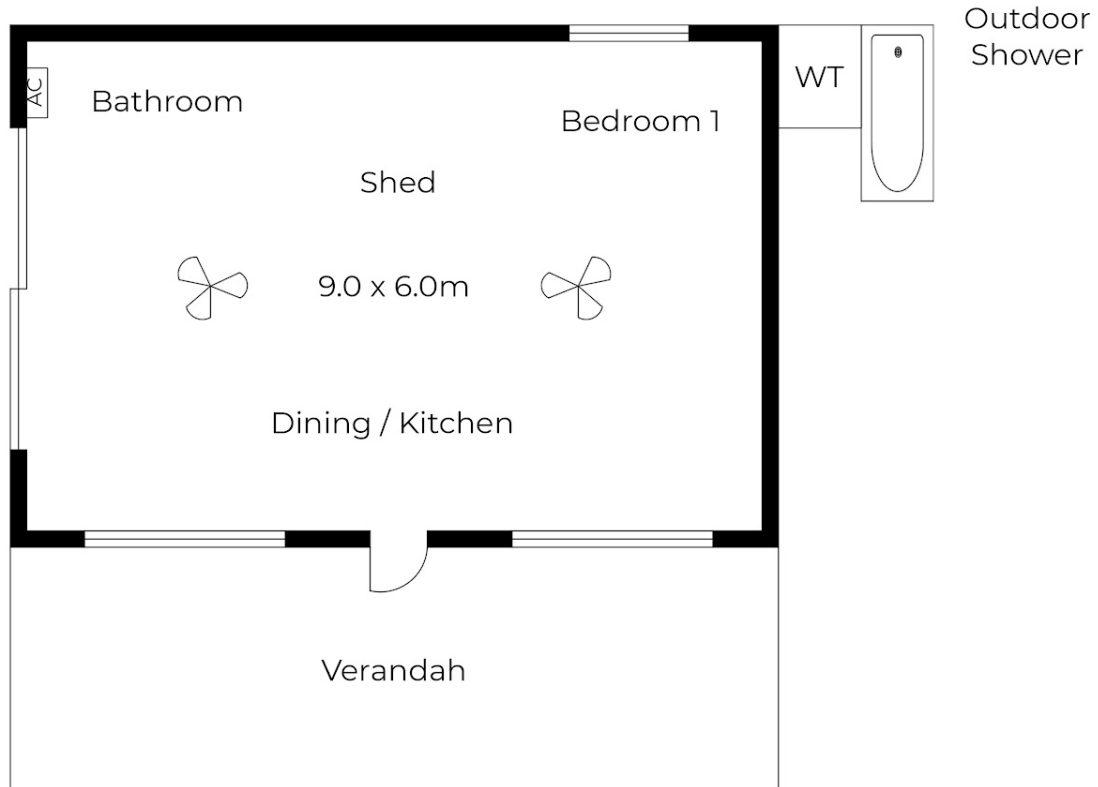

Lot 12, Chin Road, Batchelor

Floor plans and site plans are for illustrative purposes only. They are not part of any legal document or title and are subject to errors, omission, and inaccuracies. Whilst every attempt has been made to ensure the accuracy of this plan, measurements of doors, windows, rooms, cupboards etc are approximate only.

Living Floor Area : 54 m²
Total Floor Area : 82 m²

Disclaimer: Please note this floor plan is for marketing purposes and is to be used as a guide only. All dimensions are estimates only and may not be exact measurements.