



SOLD

FAMILY HOME, HEATED POOL, MASSIVE SHED AND PRIVACY!

Presenting to the market this impressive lowset Four bedroom family home with separate study on an elevated 1,250m2 level block. Positioned in the tightly held Greenwoods Estate featuring a north easterly aspect, overlooking the treetops, this property offers it all... side drive access to a massive three bay shed with workshop and plumbing, an inground heated Bionizer swimming pool and room enough for the children and fur babies to still tire themselves out in the yard.

Come inside and be prepared to be just as impressed by the expansive 300+m2 under roof floor plan including multiple living areas. Upon entering you are greeted with modern flooring. To your left is the home office perfectly located at the front of the home and to the right is a lovely quiet carpeted lounge room/parents retreat this could be easily converted to a media room! Further down the hall you arrive at the open plan living/dining - hub of the home, full of natural light with many sliding doors leading you to the outdoors. Once outside you will lose your partner/husband/wife to THE SHED, it's impressive and if there's a gardener amongst you, you're also going to love being out here nurturing your very own mango, citrus, avocado, gooseberries, pomegranates, mulberries, dragon fruit, pineapples and pumpkins!

Entertaining is a given, with a bushland backdrop, large covered alfresco area right by the pool, family games room and hub of the home, this property has been cleverly designed to induce family harmony while also providing great separation of living and entertaining, this beautiful abode has something for everyone.

The bedrooms of the home are secluded from the living areas and hub with the Master Suite occupying the end of the hallway, with a large fitted out walk-in robe, infinity fan, and ensuite complete with double vanity, large shower and rainwater shower head and stone bench tops, this is a peaceful space looking out to the sparkling inground pool. The other three bedrooms are generous in size all with built in robes and ceiling fans.

This property is a must see and includes lots of extras, we know this one won't last long so... Don't delay call Natalie today on 0419 689 309.

At a Glance:
Fully Fenced Level 1,250m2 Block

4 BED | 2 BATH | 5 CAR

PRICE:
\$1,190,000

OPEN FOR INSPECTION:
N/A



Natalie Johnston
0419689309
natalie@atrealty.com.au
[Natalieatrealty](#)

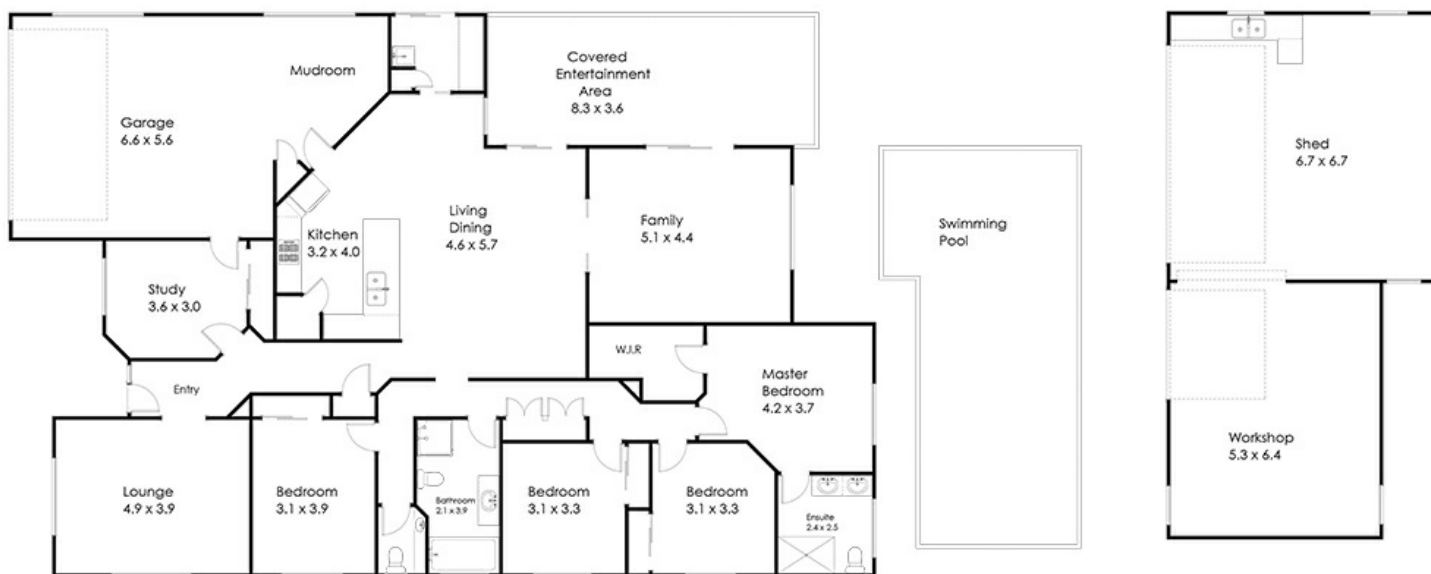

Total Living area including garage: 246 sqm

7 Heron Close Cashmere 4500

Whilst every attempt has been made to ensure the accuracy of the floor plan contained here, measurements of doors, windows rooms and any other items and structures are approximate and no responsibility is taken for any error, omission or mis-statement. Bathroom and Kitchen fittings, cupboards and door types and laundry appliances and windows are tokens and approximate the actual fitting installed.

This plan is for illustrative purposes and should be used as such by any prospective buyer. Plan drawn by Eagle Eye Photography Service, www.eagleeyenq.com.au Copyright 2021. All rights reserved. No reproduction without license, contact photographer for more information.

@realty

Disclaimer: Please note this floor plan is for marketing purposes and is to be used as a guide only. All dimensions are estimates only and may not be exact measurements.