

14 ANNIVERSARY PLACE, COFFS HARBOUR, NSW, 2450



**SOLD**

## NORTH FACING 4 BEDROOM HOME WITH A POOL AND CITY VIEWS OUT TO THE OCEAN

This 4 bedroom home is set in a commanding elevated position with a north easterly aspect and far-reaching district views that stretch right out to the ocean.

Sit out on the Veranda in the evening and watch the twinkling lights of the city and catch those summer breezes.

There are 4 bedrooms all with fans and new mirrored robes. The main bedroom features a luxury ensuite, whilst the other 3 bedrooms share the main bathroom which is brand-new with Italian feature tiles.

The home offers multiple living areas and alfresco spaces to accommodate the largest of families. Enjoy entertaining in the high-end kitchen with Bosch appliances, gas cooktop, high-gloss finish cabinetry and Caesar Stone Bench-tops. Go through the glass doors where the alfresco area flows seamlessly to connect the outside living area. This deck is 75 m<sup>2</sup> in size and features brand-new Stringybark hardwood.

The kids will enjoy the outdoor spaces that lovingly wrap around the tranquil gardens around the pool. The pool is salt water and has a brand-new fence that has been recently completed.

This home has so much to offer new ducted air conditioning 2021, all energy efficient downlights, solar electricity, and all new balustrading, tiled entry, and even wheelchair access and much more.

On the first level there's a double garage with remote access. The property features loads of storage including a man-cave for the handyman with plenty of shelving and a concrete floor. If you are wanting the complete package call Cheryl Donaldson today 0466 037 468 for your private inspection through this entertainers haven.

**4 BED | 2 BATH | 2 CAR**

**PRICE:**  
\$965,000

**OPEN FOR INSPECTION:**  
N/A



**Cheryl Donaldson**  
**0466037468**  
cheryl@atrealty.com.au  
[www.atrealty.com.au](http://www.atrealty.com.au)

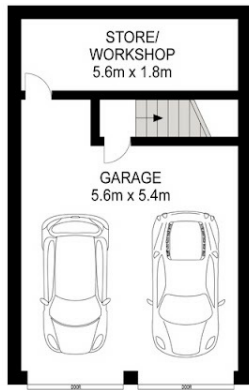

LOWER LEVEL



UPPER LEVEL



Scale in metres. Indicative only. Dimensions are approximate. All information contained herein is gathered from sources we believe to be reliable. However, we cannot guarantee its accuracy and interested persons should rely on their own enquiries.

INT: 240 m<sup>2</sup>  
EXT: 58 m<sup>2</sup>

14 Anniversary Place, Coffs Harbour



Disclaimer: Please note this floor plan is for marketing purposes and is to be used as a guide only. All dimensions are estimates only and may not be exact measurements.