



**SOLD**

## THE WAIT IS OVER

4 BEDROOM AS NEW

Gainsborough Green is a Mirvac community that lies in the heart of one of South-East Queensland's fastest growing corridors of Pimpama.

Situated towards the end of a Cul-de-Sac and nestled within the highly sought-after exclusive and prestigious Gainsborough Greens estate, a single-story boutique designed home offers nothing but peace and quiet with quality inclusions. There are no body corporate fees in this location of Gainsborough Green. For the golf enthusiast you have the golf course and club house around 5 minutes from your home! Gainsborough Greens is in an ideal location with close proximity to the shopping centres including the large Westfield Coomera Town Centre, Pimpama Junction and Pimpama City Shopping Centres.

Relatively new primary and secondary schooling minutes away, conveniently positioned half way between the Gold Coast and Brisbane with public transport only a short distance away including the new Pimpama train station (under construction). All this and a short drive to the beautiful broad water at Jacobs Well for access to the wide range of waterways and marine activities.

Residents of Gainsborough Green will enjoy close proximity to everything from transport with the soon to be completed Pimpama Railway Station with ample bus services through to three supermarkets and retail shopping, childcare, parks, private and public schools as well as clubs all within a five minute drive.

This beautiful home is built on a large lifestyle block of 480 square metres. The home has been sited on the block to give a very valuable side entrance to the house lot which gives possibility for an extension, a swimming pool or a place to park your caravan / boat / Jet Ski or possibly rent out the space to a caravan / boat owner! Beautifully constructed and well maintained custom 3-bedroom ensuite home with large open plan living as well as a huge media room or can be used as a 4-bedroom ensuite home due to photoelectric smoke detectors placed in all bedrooms, living and media areas. The home has been fitted out with Blanco & SMEG quality inclusions that will make your decision to purchase this property the best investment you will ever make. A plumbed outlet is available in the kitchen for a large refrigerator with ice making facility!

4 BED | 2 BATH | 2 CAR

PRICE:  
\$900,000

OPEN FOR INSPECTION:  
N/A



**Tony Brown**  
**0418961500**  
tonybrown@atrealty.com.au  
[www.atrealty.com.au](http://www.atrealty.com.au)

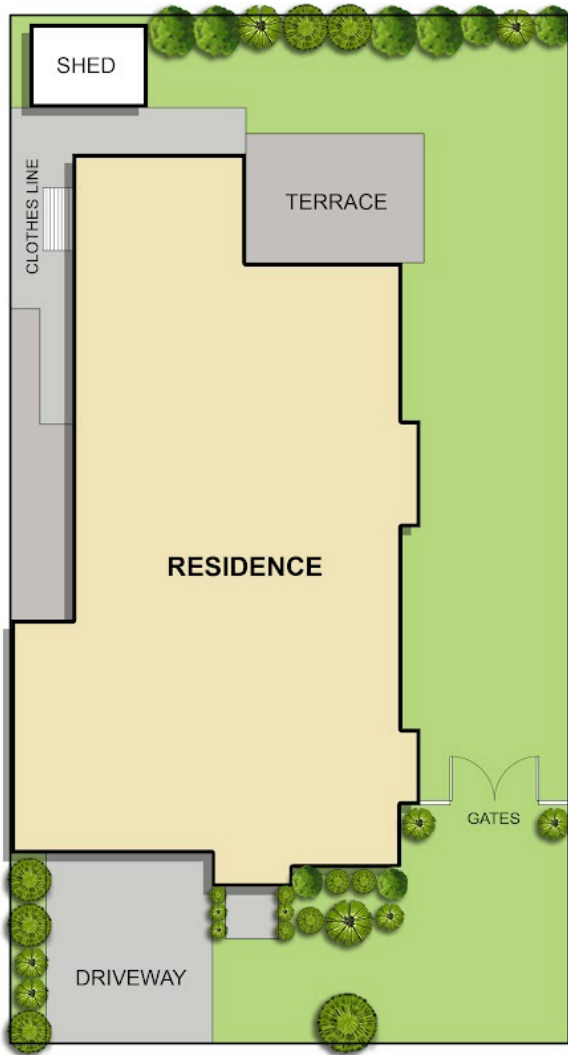

S I T E P L A N



F L O O R P L A N

Disclaimer: Please note this floor plan is for marketing purposes and is to be used as a guide only. All dimensions are estimates only and may not be exact measurements.

This floor plan including furniture, fixture measurements and dimensions are approximate and for illustrative purposes only. BoxBrownie.com gives no guarantee, warranty or representation as to the accuracy and layout. All enquiries must be directed to the agent, vendor or party representing this floor plan.