

8 INTERVALE DRIVE, WYNDHAM VALE, VIC, 3024



**SOLD**

## FAMILY LIVING AT ITS FINEST!

With an immaculate presentation from front to back and on a great sized 553sqm2 (approx.) allotment, this stunning home is sure to impress the fussiest of buyers. Located in a highly desirable pocket of Wyndham Vale, the property that you have been waiting for has finally arrived. Comprising of three spacious bedrooms all with built in robes, main with walk in robe, a central bathroom which compliments all bedrooms. A spectacular kitchen which includes quality stainless steel appliances, dishwasher, ample cupboard and bench space, all overlooking the spacious meals/family area. Outside shows off an amazing oversized pergola for family gathering and entertaining. To top things off heaps of off street parking, enormous garage/workshop just perfect for an abundance of storage, the tinkerer or tradesman! Added extras include evaporative cooling, ducted heading, downlights throughout, water tank and so much more. All of this and extra is situated walking distance to Iramoo Primary School, Wyndham Vale Primary School, public transport, gorgeous parklands and much more! Avoid disappointment and inspect this standout property today!

**3 BED | 1 BATH | 6 CAR**

**PRICE:**  
**\$520,000**

**OPEN FOR INSPECTION:**  
**N/A**



**Joseph Hanna**  
**0423966320**  
joseph@atrealty.com.au  
[www.atrealty.com.au](http://www.atrealty.com.au)

## Floor Plan

## Site Plan

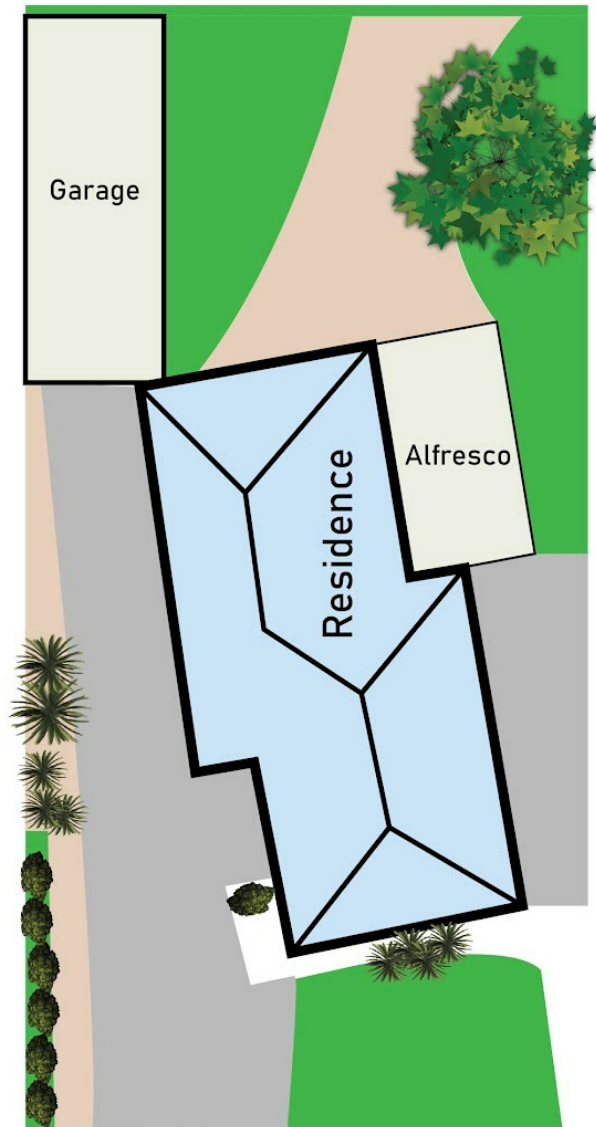
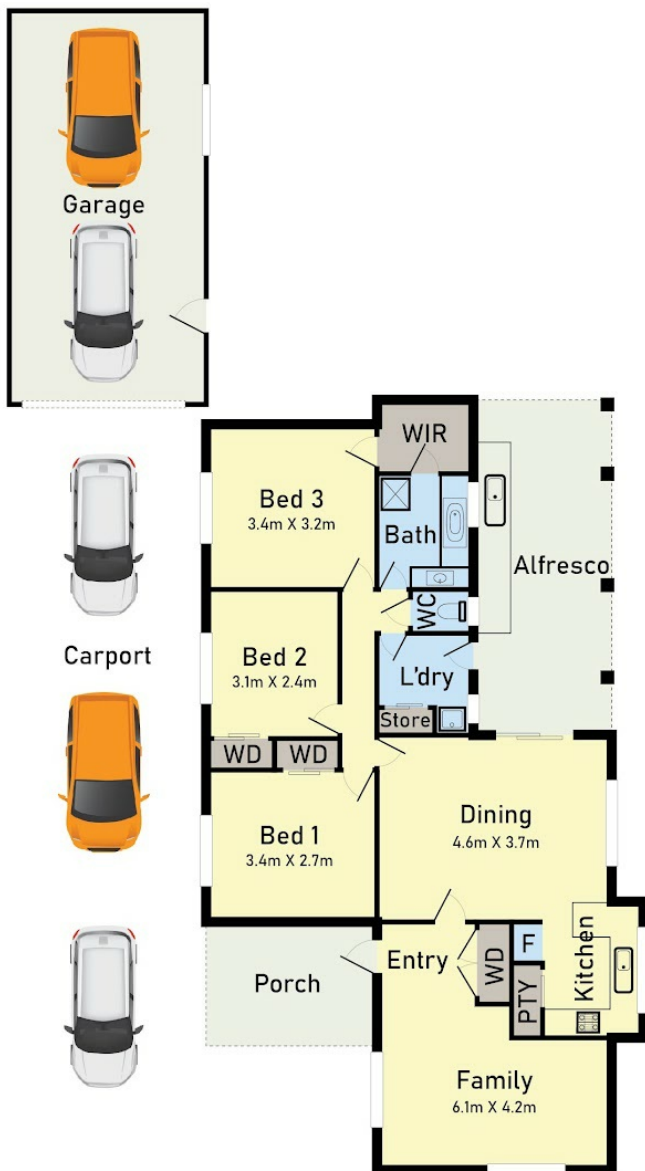

## 8 Intervale Drive Wyndham Vale

\* Dimensions are approximate and for illustrative purposes only

Disclaimer: Please note this floor plan is for marketing purposes and is to be used as a guide only. All dimensions are estimates only and may not be exact measurements.