



FOR SALE

UNIQUE STAND ALONE UNIT

Folks, make no mistake - this beautiful solid single level 2 bedroom standalone unit in Carina Heights will not be on the market for long. They just don't make them like this anymore!

This conveniently located Unit has so many advantages, it will be snapped up by the discerning owner occupier or the astute investor very quickly.

Perfect for the first home buyer, young professional couple or retirees this unit is close to shops, parks, schools, public transport, sporting complexes and shopping centres.

Benefits include:

- Totally standalone meaning no shared walls
- Very low body corp of just \$485.40 per Qtr
- Small Pet friendly complex of only 3 units
- At the rear of the complex - very quiet!
- Huge private courtyard with side access
- Remote garage with internal access
- Air Conditioned
- Separate toilet
- Handy windup / down awnings
- In the preferred Whites Hill State College catchment
- Just 7km's from the city
- Minutes to the Gateway Motorway and Westfield Carindale Shopping Centre

Meet Adrian onsite this Saturday the 3rd of October sometime between 1:15 to 1:45 at its first 'Open for Inspection' and don't forget your checkbook.

2 BED | 1 BATH | 2 CAR

PRICE:

Offers Over \$399,000

OPEN FOR INSPECTION:

N/A



Adrian Matthews

0403171644

adrianmatthews@atrealty.com.au

www.atrealty.com.au

3/89 Cambridge Street, Carina Heights

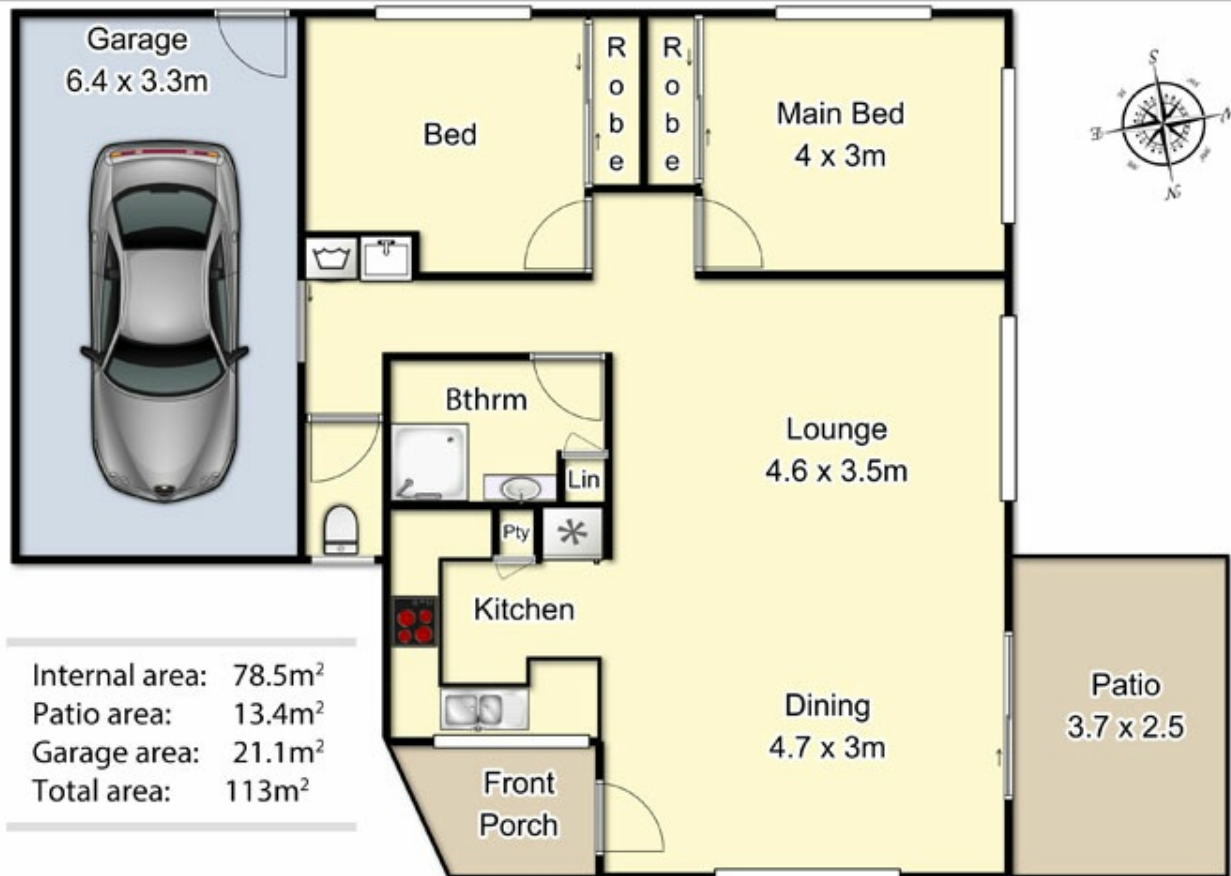

Whilst every attempt has been made to ensure the accuracy of the floor plan contained here, measurements of doors, windows, rooms and any other items are approximate and no responsibility is taken for any error, omission, or mis-statement. This plan is for illustrative purposes only and should be used as such by any prospective buyer. Created by www.highshots.com.

Disclaimer: Please note this floor plan is for marketing purposes and is to be used as a guide only. All dimensions are estimates only and may not be exact measurements.