

SOLD

CLOSE TO CITY CENTRAL

- * WELL CARED FOR 2 BEDROOM BRICK & TILE UNIT
 - * BOTH BEDROOMS WITH WALK IN ROBES
 - * GAS HEATED LOUNGE ROOM
 - * BATHROOM WITH BATH & SEPERATE SHOWER
 - * REAR VERANDAH WITH PAVING
 - * GARAGE/CARPORT FOR 2 CARS AND SMALL TRAILER
 - * LOCKABLE STORAGE ROOM
 - * LOW MAINTENANCE REAR YARD
 - * 2 UNITS ON SITE EACH FACING DIFFERENT STREETS
 - * LOCATION/PRICE/CONDITION MAKES THIS UNIT A RARE FIND
 - * CONTACT ALLEN SMITH FOR YOUR PRIVATE INSPECTION - 0419 869 854
 - * \$260,000 - \$280,000
- RLA 114222 RLA 269823

2 BED | 1 BATH | 1 CAR

PRICE:
\$280,000

OPEN FOR INSPECTION:
N/A



Allen Smith
0419869854
allen.smith@atrealty.com.au
www.atrealty.com.au
RLA: 269823

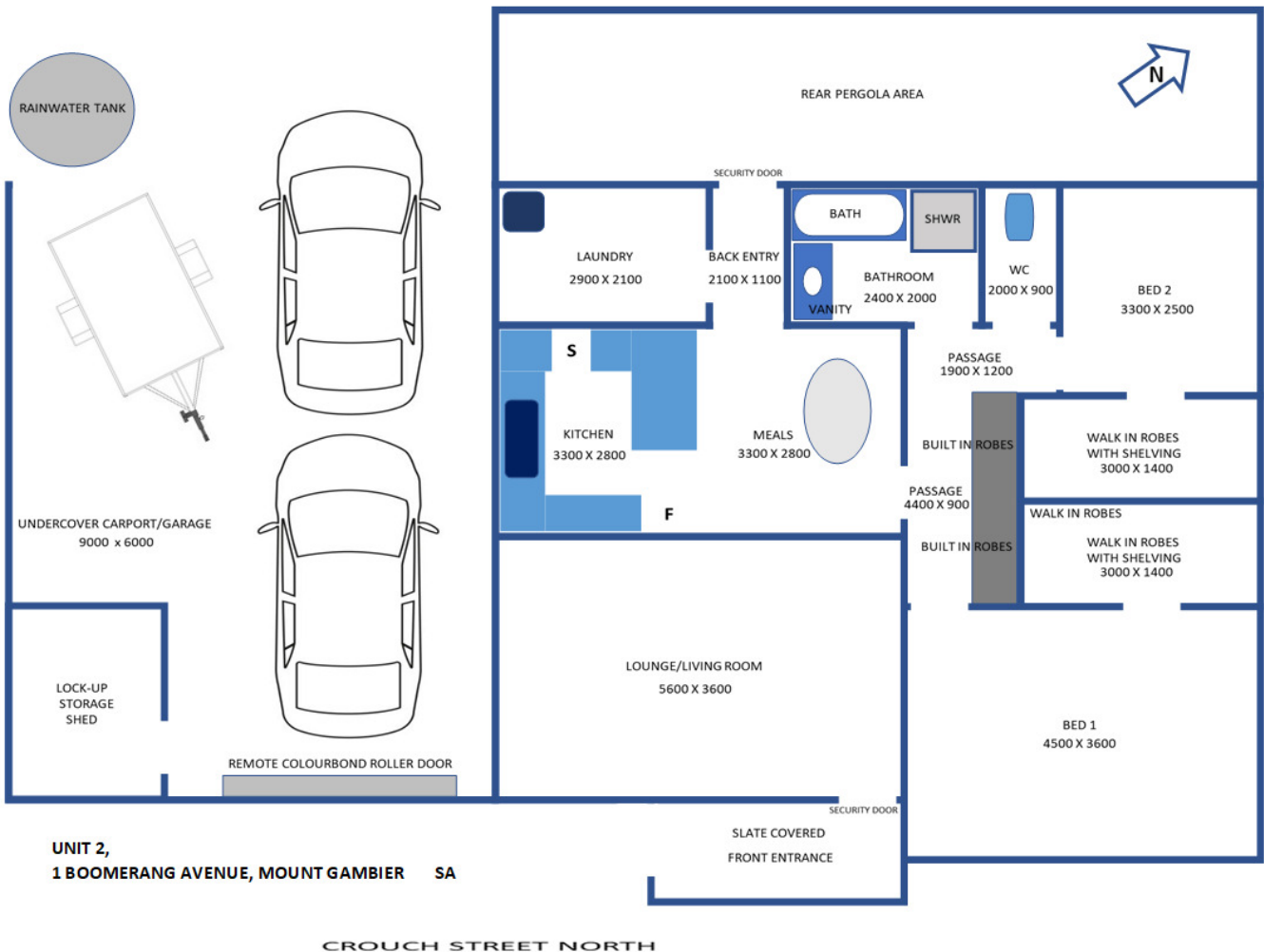

Disclaimer: Please note this floor plan is for marketing purposes and is to be used as a guide only. All dimensions are estimates only and may not be exact measurements.