



SOLD

IMPRESSIVE HOME! IMPRESSIVE LOCATION!

4beds, 3Bath, 3Toilets, 2Living, 2Car, Outdoor Entertaining, 650m2!

On site Auction! Sunday 20/11/2022 at 12.30pm! Unless Sold Prior!
Deposit payable by Electronic Funds Transfer! Settlement 30, 60 days negotiable! Photo identification and/or QR Code entry at all inspections.

This beautifully maintained family size home will impress the most fastidious of home buyers. Boasting 2 Master Bedrooms with full Ensuite bathrooms and walk in robes.

Perfectly located only minutes from Rowville Primary and Secondary Schools, bus transport, Stud Park Shopping Precinct, Rowville Shopping Village, major arterials, medical facilities, sporting grounds, parks, gardens, preschool and the Eastlink Freeway, making life easy and convenient.

Comprising a magnificent modern open plan kitchen with breakfast bar, Stone bench tops, stainless steel appliances, spacious family living and dining area, with an easy ebb and flow via sliding doors to the private outdoor entertaining area taht features a pitch roof veranda and barbeque terrace area.

Other features include. 4 spacious bedrooms, separate loungne / living area, gas ducted heating, gas log fire, 2 split systems air cons, tiled and timber floors, double garage with remote panel lift door, rear yard access via the garage, established gardens, fully fenced rear yard, ample storage and so much more.

This gorgeous home will impress! Hurry! First to see will buy!

Thinking of selling now or in the future? For a free-market appraisal Call Lou 0417-166-668 / Leeanne 0404-261 469 or email lou@atrealty.com.au
Statement of information will be available upon request.

Inspection times and property availability are subject to change without notice. Disclaimer: All information contained herein is gathered from sources we believe to be reliable. We cannot guarantee its accuracy and interested parties should make and rely on their own enquiries.

4 BED | 3 BATH | 2 CAR

PRICE:
\$925,000

OPEN FOR INSPECTION:
N/A



Lou Rinnovasi
0417166668
lou@atrealty.com.au
www.atrealty.com.au

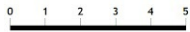
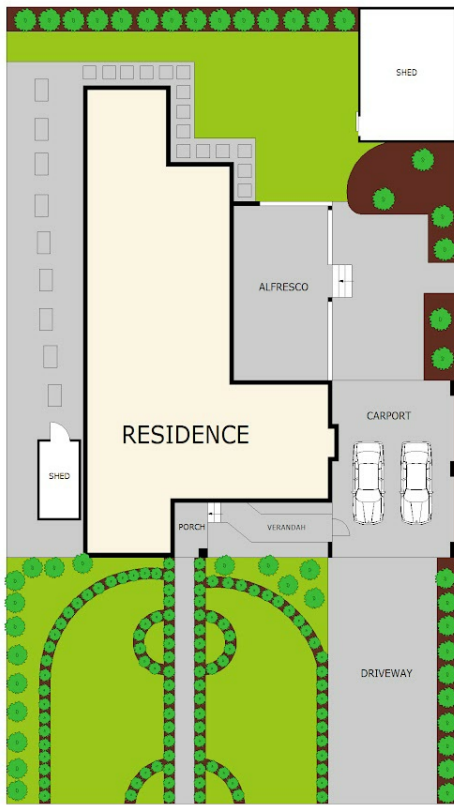

SITE PLAN



Residence	- 145 m ²
Alfresco	- 36 m ²
Verandah	- 7 m ²
Shed	- 32 m ²
Carport	- 44 m ²
Porch	- 4 m ²
Total	- 268 m ²



Scale in metres. Indicative only. Dimensions are approximate. All information contained herein is gathered from sources we believe to be reliable. However we cannot guarantee its accuracy and interested parties should rely on their own enquiries.

48 Goulburn Drive, Rowville

Disclaimer: Please note this floor plan is for marketing purposes and is to be used as a guide only. All dimensions are estimates only and may not be exact measurements.