



SOLD

4.5 ACRE PROPERTY WITH IMMACULATE IMPROVEMENTS AND BREATH TAKING VIEWS OF THE CROWS NEST HINTERLAND

This well maintained and beautifully presented property is ready for the new owner to move in, all of the hard work has been done. The Property is a one minute drive to Crows Nest's CBD. The low maintenance garden has been professionally landscaped; with freshly mulched garden beds and all have automated irrigation systems, with rain sensors and solar lighting throughout the garden. A fish pond with netting for safety, lighting, and a feature fountain.

A permanent creek runs along the boundary that provides fresh water all year round for the horses.

From the large timber deck, one can enjoy uninterrupted views over the neighbouring cattle property, and in the distance the rolling hills of the Crow Nest Hinterland.

The land is divided into 3 paddocks, with a slight elevation up to the home, sheds and stables. Convenient horse facilities include; stable, tack/feed room (power connected), stock water tank and trough, wash bay and a small holding yard.

FEATURES OF THE HOME.

- * Insulated walls, ceiling and under the floor, smart wiring throughout.
- * Kitchen has a large walk-in pantry with automatic light. Pantry has many shelves and ample room to fit a secondary fridge.
- * L.E.D down lights, granite benchtops, 2-PAC paint cupboards and draws. Corner cupboard has revolving shelves, and under sink water filter, under cupboard lighting, 5 burner gas cook top, electric wall oven, storage cupboard under the breakfast bar, large built in fridge space (1040mm wide), new dishwasher.
- * Open plan kitchen and dining with lovely rural views out over the deck to the SW.
- * Dining room sliding doors open onto a large entertainment deck. Through the dining room is an Media room with French doors, which can be closed for privacy. TV antenna, reverse cycle split system.
- * Large spacious formal lounge, integrated sound system (throughout the home and outside deck, can be isolated to specific rooms), reverse cycle split-system, tinted windows and blinds.
- * L.E.D down lights throughout the home and ceiling fans.
- * 2 Queen size bedrooms, carpeted with built in robes.
- * King size Master bedroom, spacious walk-in robe , luxurious en-suite with a spa bath, heated towel racks, vanity unit , large shower recess and separate toilet.

4 BED | 2 BATH | 6 CAR

PRICE:
\$880,000

OPEN FOR INSPECTION:
N/A



Yvonne Bradley
0408181146

yvonne@atrealty.com.au
www.atrealty.com.au

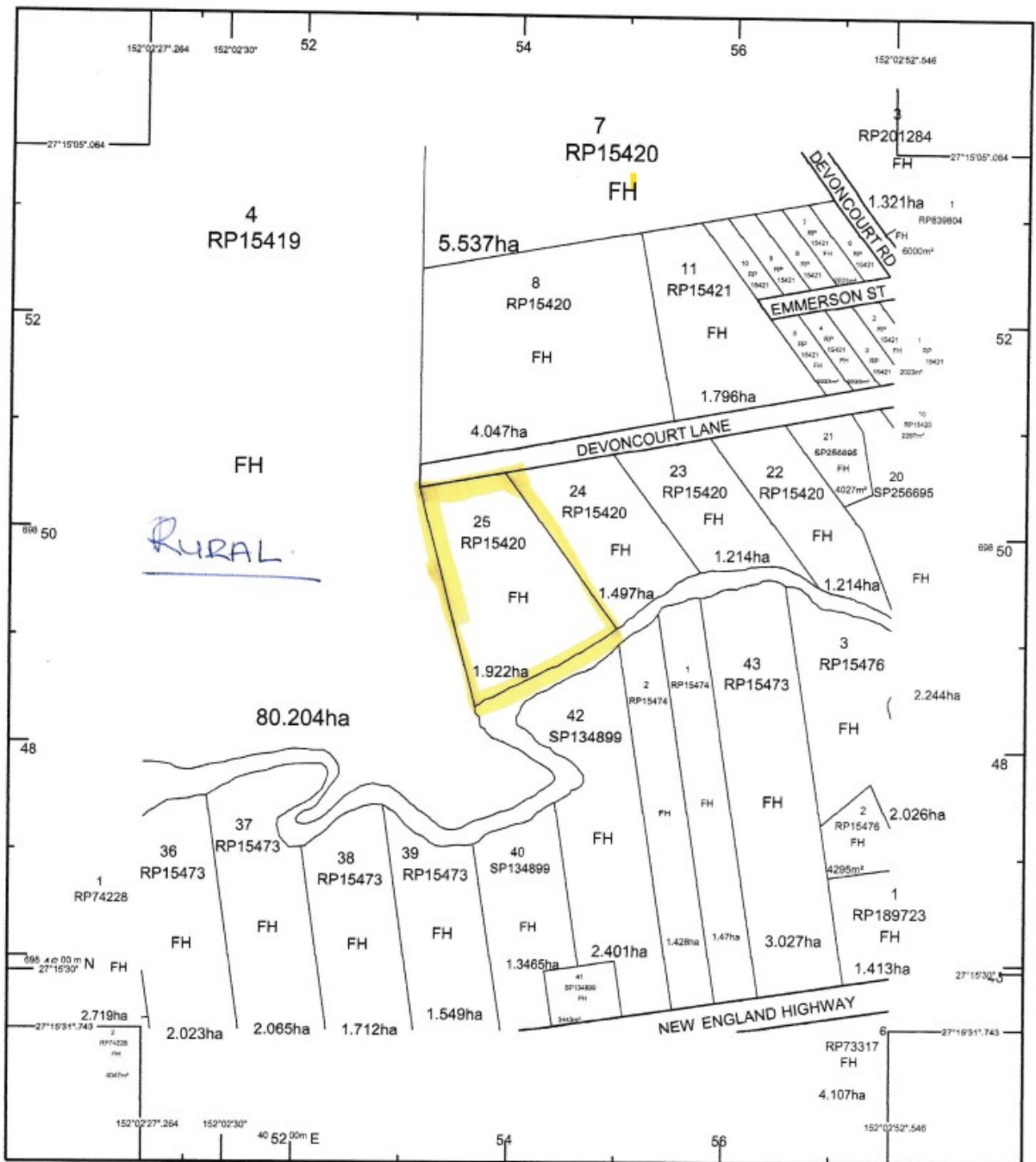

STANDARD MAP NUMBER
9343-34414



SmartMap
An External Product of
SmartMap Information Services

Disclaimer: Please note this floor plan is for marketing purposes and is to be used as a guide only. All dimensions are estimates only and may not be exact measurements.

Yvonne Bradley
0408181146
yvonne@atrealty.com.au
www.atrealty.com.au

