

14 DEBENHAM AVENUE LEUMEAH



# FOR SALE

## LOVE AT FIRST SIGHT

### Features Include:

- Immaculate presentation with vibrant interiors
- Impressive foyer entrance
- Boasting four generously proportioned bedrooms with built in robes to two
- Cleverly designed kitchen with soft close cupboards, waterfall benchtops, built in sink, dishwasher, stainless steel appliances & pantry
- Expansive Living room with feature timber framing
- Bright & airy modern bathroom with freestanding bathtub & floor to ceiling tiling
- Exposed timber design features throughout
- Plantation shutters
- Down lights & feature pendants
- 3 x split system air conditioners
- Alarm
- LPG gas heating point
- Exquisite undercover timber decking with built in kitchen and outdoor power supply
- Large fully enclosed manicured backyard
- Double gates for side access
- Single garage with spacious workshop area
- Rendered home with established & manicured front yard
- 661.7 sqm Block

Located in the family friendly suburb of Leumeah, this stunning abode is conveniently within close proximity to both the local primary & high schools, train stations, local shops as well as Campbelltown's CBD & if you love the outdoors, you are only minutes away from the spectacular walking tracks at Kentlyn where you can let the winding nature trails carry you effortlessly while taking in all the sounds & lush greenery that surrounds you. This home is one to put at the top of your inspection list.

Agency Central believes that all the information contained herein is true & correct to the best of our ability however we encourage all interested parties to carry out their own enquiries.

4 BED | 1 BATH | 1 CAR

### PRICE:

Just Listed

### OPEN FOR INSPECTION:

N/A



**Huss Al Salemi**

**0411699419**

[huss@atrealty.com.au](mailto:huss@atrealty.com.au)

[www.agencycentral.com.au](http://www.agencycentral.com.au)

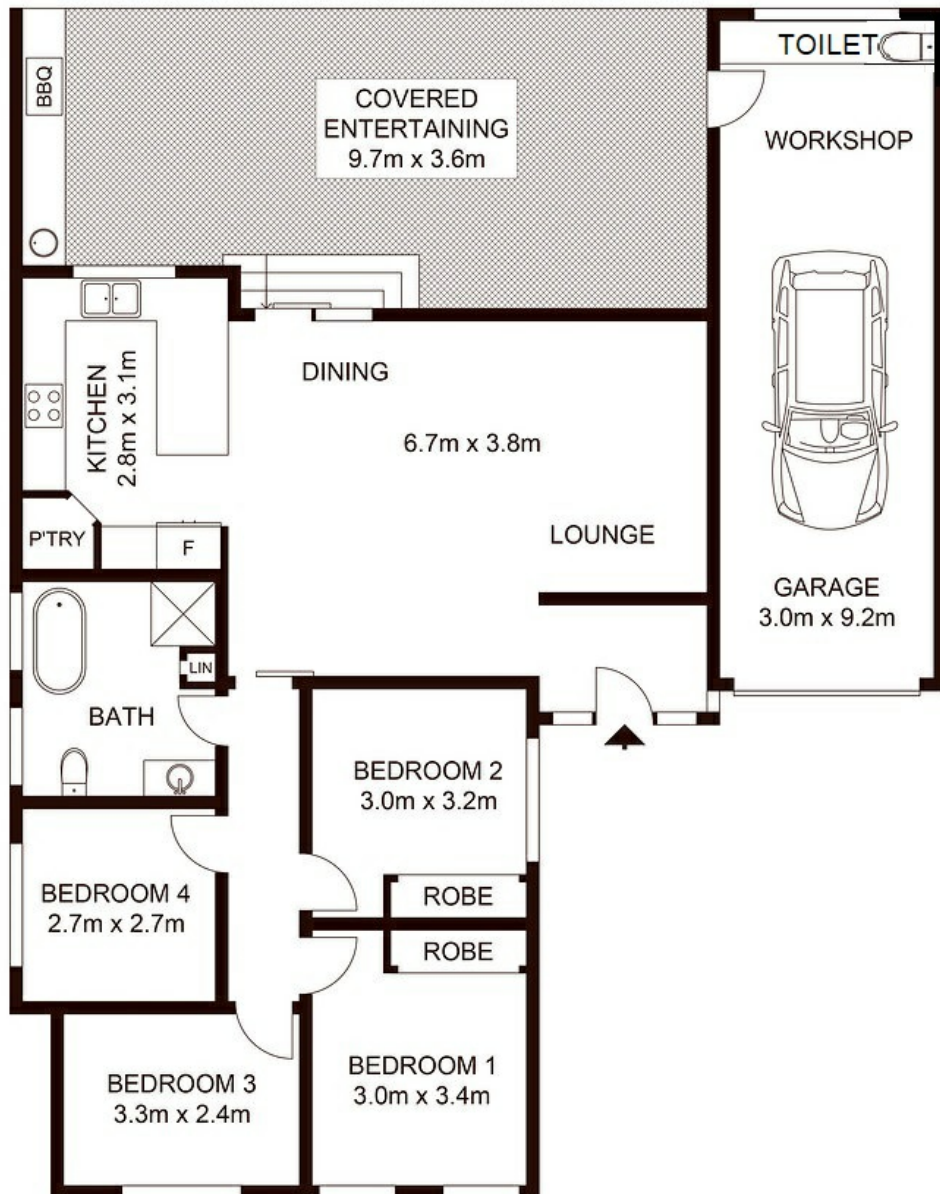

Disclaimer: Please note this floor plan is for marketing purposes and is to be used as a guide only. All dimensions are estimates only and may not be exact measurements.

14 Debenham Avenue, LEUMEAH

Huss Al Salemi • All measurements are approximate • Drawn for marketing purposes only

0411699419

[huss@atrealty.com.au](mailto:huss@atrealty.com.au)

[www.agencycentral.com.au](http://www.agencycentral.com.au)

