



**SOLD**

## STUDIO APARTMENT, WALK TO THE WATER.

Perfect for the simple life, portfolio top up or first investment.

Unit 3 Edward Place, Biggera Waters is a truly unique find. Small in stature, big on features. Compacted into three rooms you have all the necessities for simple living, combined bathroom/Laundry, living/dining/kitchen and of course a bedroom, and all located with a very short walk of the the Gold Coast Broadwater. Your unit also comes with an undercover car space only accessible through the security gate. Pedestrian entry to the complex is also by way of security gates.

A low body corporate of around \$30 per week and with current units in the complex earning \$360 per week rental income, this unit is hard to look past as an investment property.

### Features

- Well looked after complex.
- Low body corporate
- Others in the complex earning \$360 per week
- Security gates for pedestrian and vehicle access to the complex, intercom access for guests
- Compact with very good use of space and storage

### Location has so much

- Walk to the Broadwater and local swimming hole
- Walk to restaurants, cafe's and the famous Grand Hotel
- Biggera Waters shopping centre a short drive or leisurely stroll
- Near Brisbane Road sending you to Surfers one way and Brisbane the other

Book an appointment or watch for open home times, if it lasts that long.

1 BED | 1 BATH | 1 CAR

PRICE:  
\$290,000

OPEN FOR INSPECTION:  
N/A



**Tony Brown**  
**0418961500**  
tonybrown@atrealty.com.au  
[www.atrealty.com.au](http://www.atrealty.com.au)

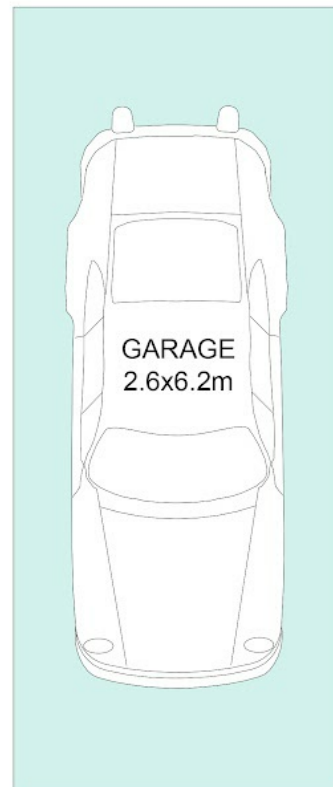
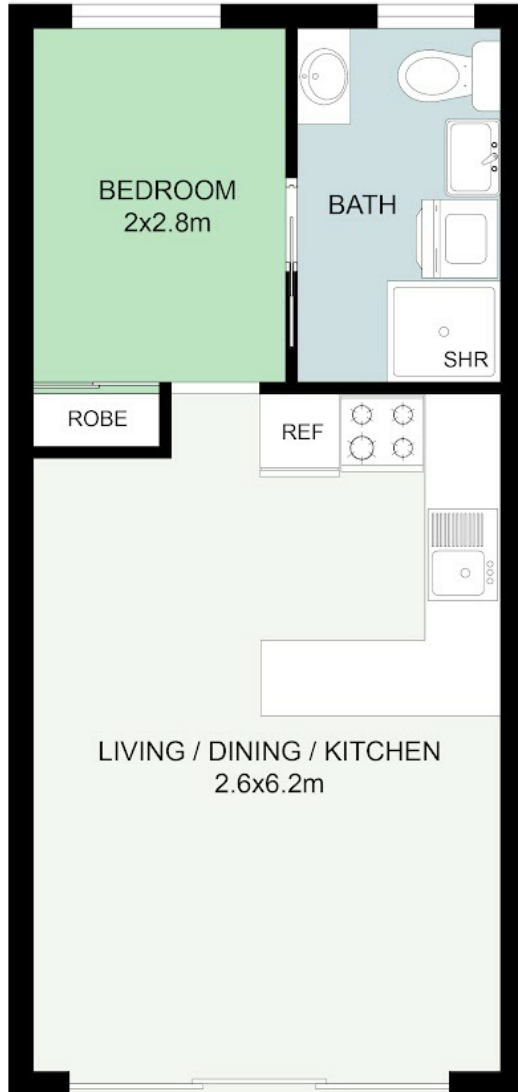

## FLOOR PLAN

Disclaimer: Please note this floor plan is for marketing purposes and is to be used as a guide only. All dimensions are estimates only and may not be exact measurements.

This floor plan including furniture, fixture measurements and dimensions are approximate and for illustrative purposes only. BoxBrownie.com gives no guarantee, warranty or representation as to the accuracy and layout. All enquiries must be directed to the agent, vendor or party representing this floor plan.