



SOLD

DREAM HOME NEAR THE BEACH !!! FUN, RELAXING, ENJOYABLE.

You are invited in owning this lovely park like setting property with lots of privacy close to the beach.

Imagine the sounds of the ocean waves, the breezes of the trees, the abundance of wildlife.

Welcome to 215 Sylvan Drive, Moore Park Beach

When owning this property, get ready to be placed in a peaceful environment with many walking trails set close to the beach.

How to find the beach ?

A walk from your driveway, to the other side of the road, up the track, to the beach you go.

(See photos of actual property road frontage with sidewalk plus beach photos with trail to beach).

The 4,001 square metre property receives visits from local residents as possums, birds & kangaroos. Approx. 1 Acre

There are abundance of entertainment areas to entertain your guest, such as:

- > a large three bay shed
- > three bay carport with a large side patio
- > fire pit area
- > natural wildlife land corridor next door.
- > garden settings
- > large verandah

The property includes a beautiful well built four bedroom, two bath, lounge/media room, lounge/family room home.

4 BED | 2 BATH | 6 CAR

PRICE:
\$880,000

OPEN FOR INSPECTION:
N/A



Rodney Williams

0434023067

rodneymwilliams@atrealty.com.au

www.atrealty.com.au

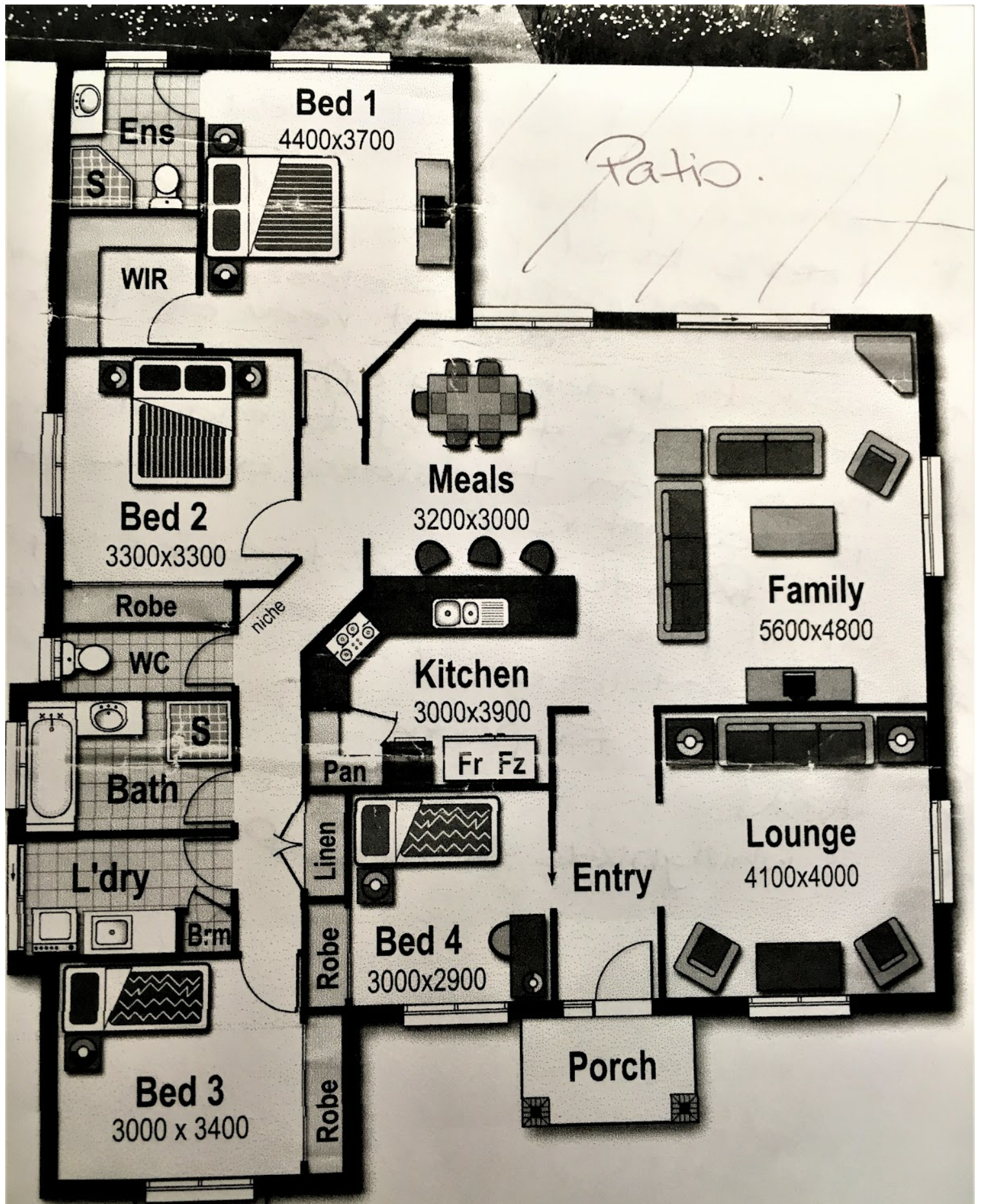

Disclaimer: Please note this floor plan is for marketing purposes and is to be used as a guide only. All dimensions are estimates only and may not be exact measurements.