



SOLD

FAMILY LIVING IN A CENTRAL LOCATION!

This beautifully maintained 4-bedroom brick veneer property on 552m2 allotment is ready and waiting for its new owner in the highly sought-after Courtenay Gardens Estate. Ideal for the first home buyer or the astute investor this property is within proximity of all the family-friendly amenities Cranbourne North has to offer.

Well-presented four-bedroom home that includes master bedroom with ensuite and walk in robe. Two living areas, the other three bedrooms serviced by a centrally located family bathroom and separate toilet. Kitchen/dining area leading out to undercover pergola/decked area. The secure and large backyard area provides lots of room for kids and pets. The front yard is also huge with side access that can be used for additional parking of boat/caravan. The property has a double car carport under the same roofline.

Other features include Gas Ducted heating, Evaporative cooling, dishwasher, garden shed, security doors, manicured gardens etc

Holding the key to family success, the home rests within proximity to parks, buses & trains, within walking distance to Courtenay Gardens Primary School, Cranbourne Carlisle Primary, Lyndhurst Secondary, Springhill Shopping Centre, local childcare centres, medical centres, Thompson Parkway Shopping Centre, Homebuyer Centre and Cranbourne Park Shopping Centre, with the South Gippsland Hwy providing easy access to Monash Freeway.

For further details, or to arrange an inspection, please contact Leon on 0415 205 032

4 BED | 2 BATH | 2 CAR

PRICE:
\$611,000

OPEN FOR INSPECTION:
N/A



Leon D'Penha
0415205032
leon.dpenha@atrealty.com.au
www.atrealty.com.au

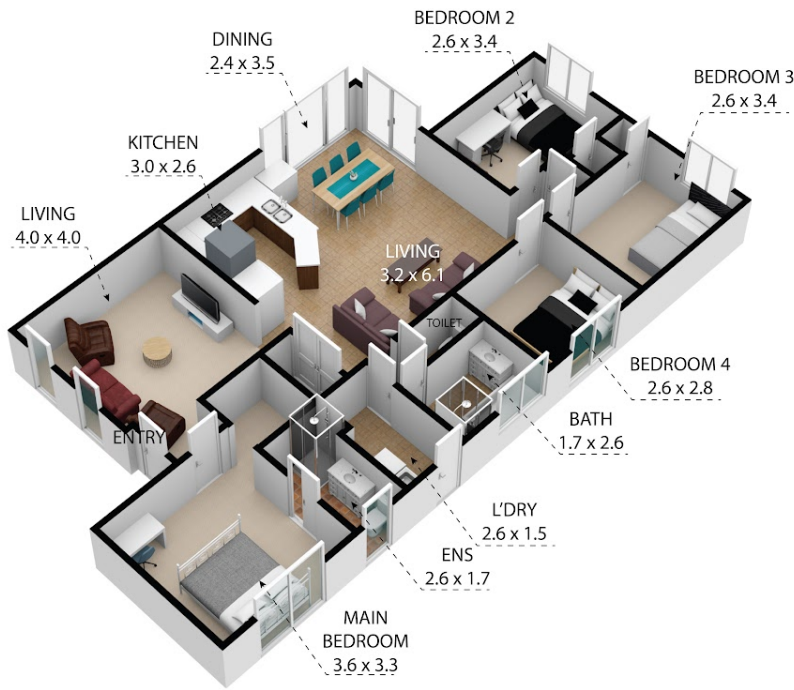

15 Norford Court, Cranbourne North 3977
TOTAL APPROX. FLOOR AREA 117 SQ.M

Whilst every attempt has been made to ensure the accuracy of the floor plan contained here, measurements of doors, windows, rooms and any other items are approximate and no responsibility is taken for any error, omission, or misstatement. This plan is for illustrative purposes only and should be used as such by any prospective purchaser.

Photography and Floorplans by
VISUAL IMPRESSIONS

Disclaimer: Please note this floor plan is for marketing purposes and is to be used as a guide only. All dimensions are estimates only and may not be exact measurements.

Leon D'Penha
0415205032
leon.dpenha@atrealty.com.au
www.atrealty.com.au

