

FOR SALE

GARDEN GATE ONTO COASTAL DUNES | ELEVATED, PRIVATE, OCEAN VIEWS | CONTEMPORARY 5X3, LAP POOL

GARDEN GATE INTO COASTAL DUNES
ELEVATED, PRIVATE, OCEAN VIEWS
CONTEMPORARY 5X3, LAP POOL

Under | Offer

A once-in-a-generation buying opportunity.

There are only around 250 homes, oceanside of West Coast Highway in the sought-after coastal hamlet of South City Beach. Within, there are a finite 27 oceanfront homes on "The Branksome Strip" with rear garden gates onto the dunes.

This is at the tightly held, far-northern end, footsteps to the Groyne and Café Precinct. In my opinion, it is the 4th best block of the 27 (with 1st, 2nd and 3rd going to the 3 lots which have their long boundaries facing the ocean). This is the best of the 24 with their short boundaries facing the ocean.

By way of explanation, all others have walk path, park, playground or carpark in front of them. This is the only property where the dunes come all the way to your back fence and there is an incredible ocean view - providing a coastal panorama that showcases an intimacy and romance with the seascape like no other I have seen. The majestic Indian Ocean and the Bay of Islands (Rotto, Garden and Carnac) in all its glory!

At majority land value, this amazing 2007 built 5x3 family home with lap pool almost comes for free!

Fall in love with this wonderful coastal architecture of limestone, timber, and glass. So convenient to everything in the ever so sought-after Groyne and Café Precinct of South City Beach. With an aspect so remote you will feel like you are on the west end or Rottneest.

5 BED | 3 BATH | 2 CAR

PRICE:
Under | Offer

OPEN FOR INSPECTION:
N/A



Scott Swingler
0448172307

scott@shore-property.com.au
Shore Property

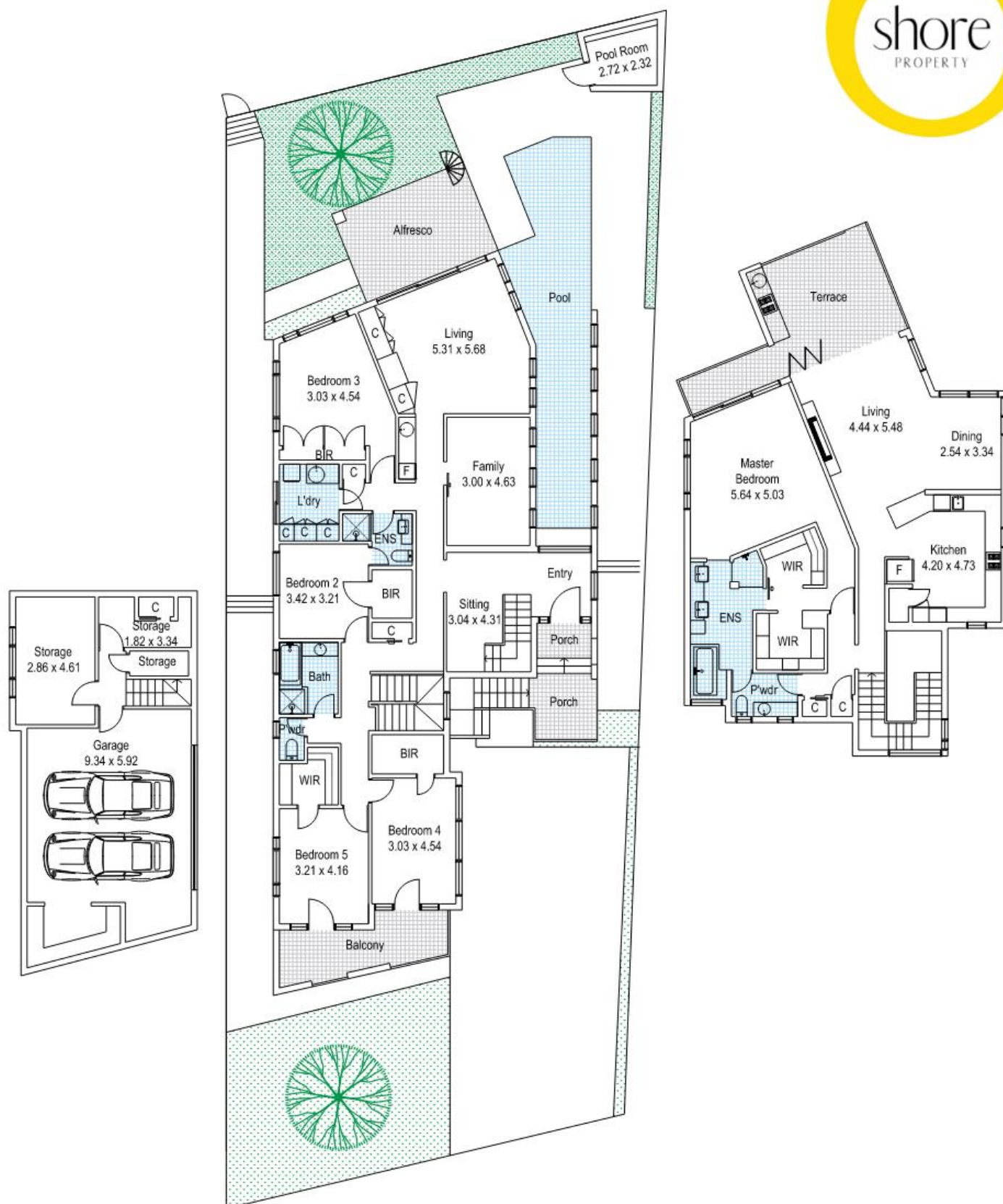

APPROXIMATE AREA:
Ground Floor: 196m²

Disclaimer: Please note this floor plan is for marketing purposes and is to be used as a guide only. All dimensions are estimates only and may not be exact measurements.

Balcony: 13m²
Terrace: 26m²

Total: 490m²



BRANKSOME GARDENS
CITY BEACH

Whilst every attempt has been made to ensure the accuracy of this floor plan, all measurements, and any other data shown are an approximate interpretation. Finesse Photography will not be held liable or responsible for any error, omission, misstatement or use of any data shown on the final floor plan.



Scott Swingler
0448172307

scott@shore-property.com.au
Shore Property