



SOLD

BURSTING WITH OPPORTUNITY

This property is bursting with potential and waiting for you to bring it to life. Situated high on the hill on a spacious 702m² block, this property retains its original charm and character despite its need for extensive renovations. The home is in its original condition and features 3 large bedrooms, high ceilings, original period built-ins, central open lounge area, large kitchen, opening out onto a covered timber deck overlooking the fenced backyard with plenty of room for the kids to run and play.

With a little hard work and a good imagination, this property has the incredible potential to be transformed into a spacious and comfortable family home or potential to become a fantastic investment. It should be noted some cracks need to be fixed due to foundation movement and settling. This presents a fantastic opportunity for those who are handy or have a keen eye for renovation projects. Conveniently located near public transportation, and shopping centers, and is within walking distance to Lismore Golf Club. Contact me today to schedule a viewing!

3 BED | 2 BATH | 1 CAR

PRICE:
\$350,000

OPEN FOR INSPECTION:
N/A



Chris Williams
0428333447
chrisw@atrealty.com.au
www.atrealty.com.au

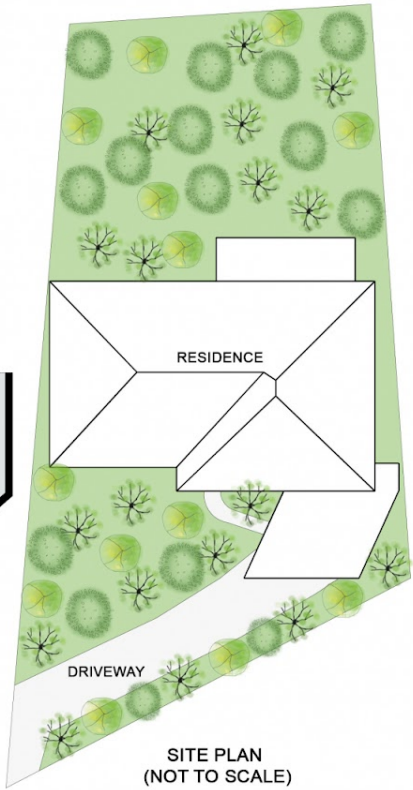
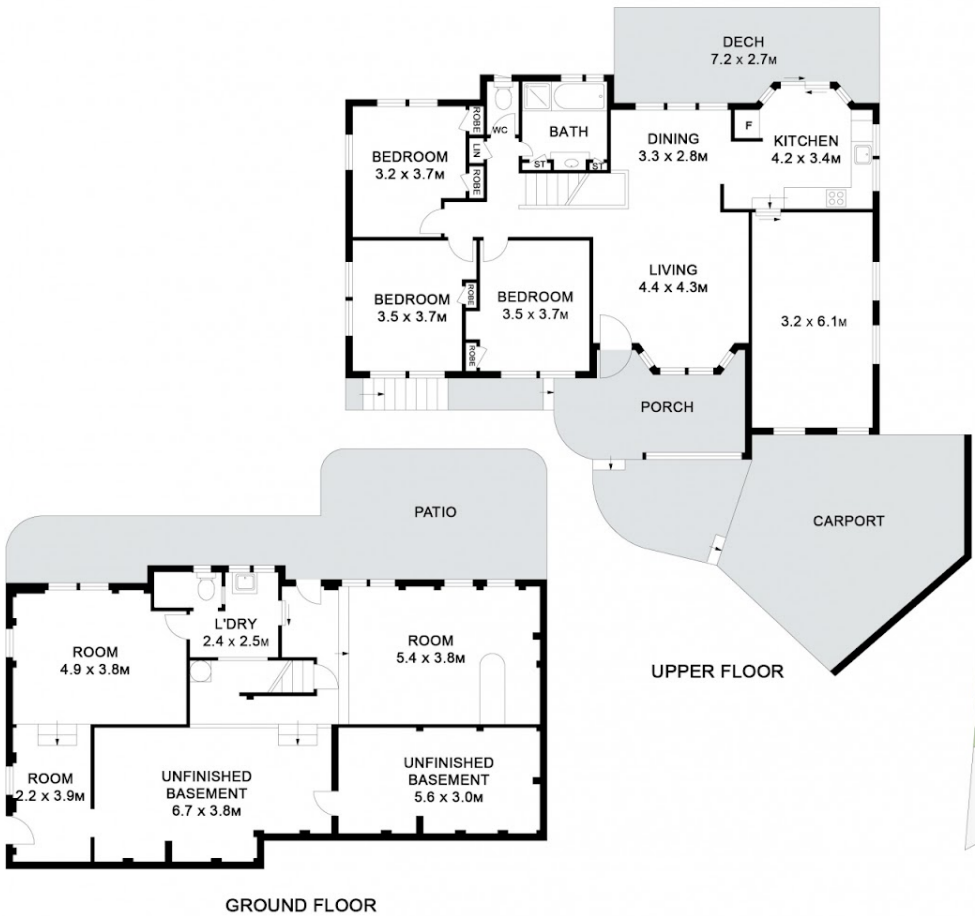

SITE PLAN (NOT TO SCALE)

GROUND FLOOR

50 Barham St, East Lismore

Floor Plan Disclaimer: Media Drive (MD) floor plans / site plans are intended as an approximate guide only. No representations or warranties of any nature are given or intended and any person using this information other than as a guide should always rely on their own enquiries. Media Drive property marketing services / 0413979054 / Photography, Floor plans, Video, Aerial photography / www.mediadrive.com.au

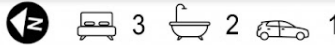

APPROXIMATE AREAS @realty	
INTERNAL FLOOR SPACE	- 183m ²
EXTERNAL FLOOR SPACE	- 114m ²
GARAGE	- m ²

Disclaimer: Please note this floor plan is for marketing purposes and is to be used as a guide only. All dimensions are estimates only and may not be exact measurements.