

7 BEAGLE CLOSE, BENTLEY PARK, QLD, 4869



SOLD

TROPICAL INSPIRED OASIS IN A PRIME LOCATION THIS HOME WILL NOT LAST LONG!

This beautifully presented well maintained family home is located in the heart of the popular suburb of Bentley Park. Sitting on a flat and usable 776m² block while nestled away in a quiet Cul-de-sac..... this home is sure to tick all the boxes.

On entry, you will discover a spacious lounge room flowing through to the kitchen and living area. The kitchen has an ample of bench & storage space with plenty of lighting. The spacious open plan kitchen and living area flow effortlessly from the kitchen to the bedrooms and overlook the back yard making it easy to keep an eye on young ones.

The home overall comprises of four bedrooms, The master bedroom suite has a large built-in robe and a modern en-suite. The remaining 3 bedrooms are all generous in size with built in robes, air conditioning and ceiling fans.

Upon stepping outdoors, keeping you out of the north Queensland sun the large full length entertaining area perfect for your guests & Family to enjoy. The large and level yard is fully fenced and has plenty of room for children and pets to play safely and in complete privacy. There is access to the rear of the yard from the garage for all your toys..... parking will not be a problem.

- Master bedroom with Built in robe and en-suite
- Remaining 3 bedrooms all with built in's,
- Air-conditioned & Ceiling fans throughout
- Separate toilet from main bathroom
- 2 Car garage and plenty of more parking spaces
- Freshly vinyl floors in bedrooms
- Security System
- Security screens & doors.
- Outdoor security lights
- Garden shed
- Easy care gardens are perfect for those with busy lifestyles
- Rates Approx. \$2760 / year

This well-established property is the perfect set up for making many happy memories as you

4 BED | 2 BATH | 2 CAR

PRICE:
\$465,000

OPEN FOR INSPECTION:
N/A



Chris Derbyshire
0403385177
chrisderbyshire@atrealty.com.au
www.atrealty.com.au

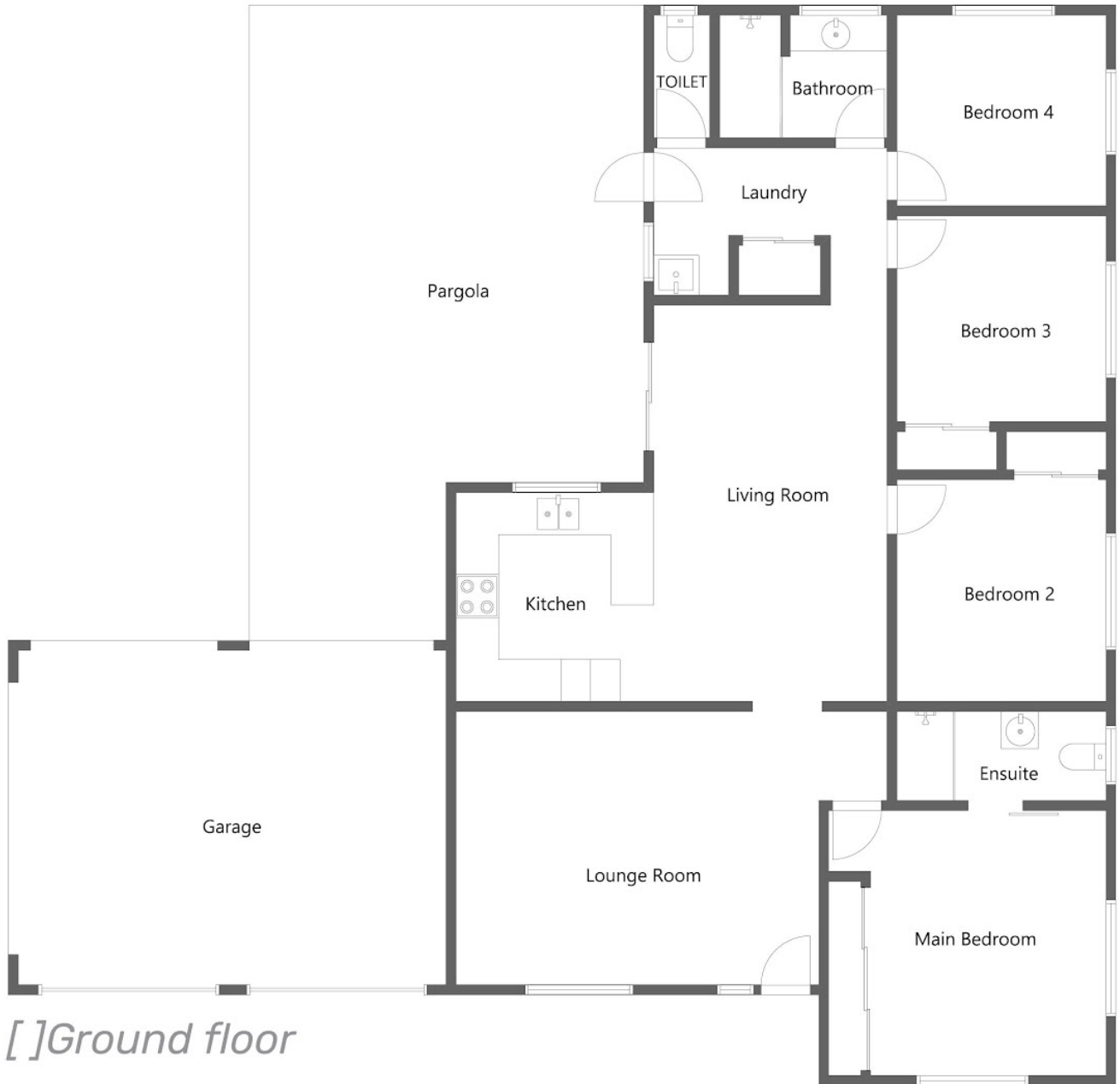

7 Beagle Cl,

Floor plan is provided as indicative layout only. Measurements are not available. floor plan is not to scale. No guarantees



Disclaimer: Please note this floor plan is for marketing purposes and is to be used as a guide only. All dimensions are estimates only and may not be exact measurements.

Chris Derbyshire
 0403385177
 chrisderbyshire@atrealty.com.au
www.atrealty.com.au

