

1095 HEATHERTON ROAD, NOBLE PARK, VIC, 3174



SOLD

WONDERFUL 3 BED, 1 BATH HOME WITH 618 SQM AND ALL AMENITIES IN NOBLE PARK!

Land size 618 m2 Approx.

Owner & Director of VIET HA Selling Expert Property Group - Viet Ha is proud to present this lovely house, which will appeal to both first-time buyers, investors or own business. This is your chance to own an impeccable, turn-key house in Noble Park. Every imaginable inclusion has been considered to guarantee that this home gives an easy and comfortable lifestyle

THE GOOD BITS

This brick veneer home set on a block of approximately 618 m2 Approx. Delivers perennial appeal inside and plenty of space outside. Boasting three good size bedrooms with built wardrobes, private living room, timber floor, a fresh coat of paint, NBN. The kitchen features stainless steel gas cooking appliances and evaporative cooling throughout.

WHAT YOU'LL LOVE

Outside a covered deck overlooks the generous backyard, giving additional living space for outdoor entertaining. Carport mean flexibility for storage and parking options. The low maintenance outdoor entertaining spaces ensures appeal for discerning owner occupiers and investors

Property features include:

- Modern double kitchen, s/steel 600mm ovens and gas stoves, range hoods, electric oven, gas cooktop
- Tiled/Timber flooring in open areas
- Ground floor 2.75m high ceiling
- Chic designer floor to ceiling tiled bathrooms
- One bathroom, 1 toilet, 1 living room, 3 Cars
- Three spacious bedrooms with timber and robes
- Tiling in all wet areas
- Low-maintenance yard, veggie patch, off-street parking
- Additional parking space

3 BED | 1 BATH | 1 CAR

PRICE:
\$790,000

OPEN FOR INSPECTION:
N/A



Viet Ha
0406246384
viet@vietha.com.au
vietha.com.au

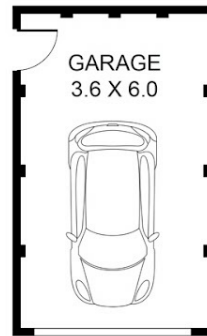
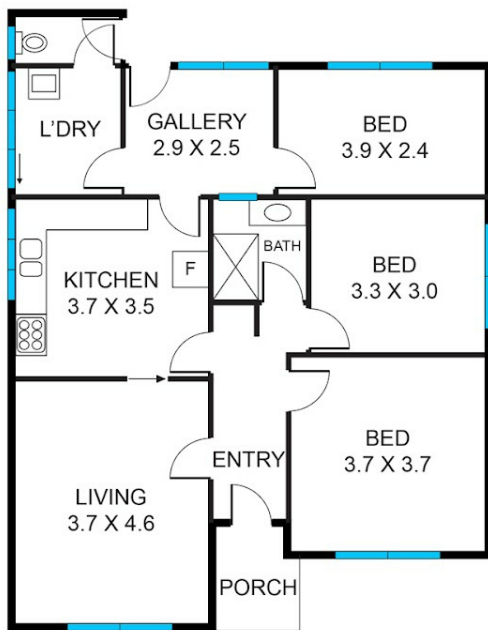

(NOT IN POSITION)

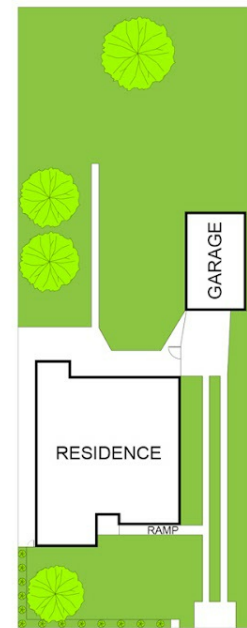

1095 Heatherton Road, Noble Park

Disclaimer: This floorplan is for illustration purposes only and no warranty is given to its accuracy. Purchasers are advised to carry out their investigations.

Disclaimer: Please note this floor plan is for marketing purposes and is to be used as a guide only. All dimensions are estimates only and may not be exact measurements.