

SOLD

GREAT LOCATION.....MAKE AN OFFER!!

CHECK OUT THE REAL VIDEO - NOT A SLIDE SHOW

Nestled away, this beautiful home really took me by surprise! Located in a quiet street, you will be impressed by this gorgeous family home with multiple living areas, four great size bedrooms, ensuite and walk-in robe plus a huge study/movie room/extra living space/extra bedroom. The garage is a double and can fit two cars whilst acting as a handy place for extra storage. As you walk in, the home opens up with the entrance leading into the lounge. It's definitely big enough to fit everyone around the TV for film night, or to put the kids whilst you escape in the open plan kitchen/dining/living area. Opening out to the covered alfresco area, the garden is littered with sub-tropical plants and trees, which sets the tone to a relaxing Sunday with a glass of wine. . It's here, I would probably spend most of my time! Definitely an ideal place to escape! The bedrooms are a good size, and due to the layout of the home, the accommodation can be revised to suit your lifestyle

The location in a quiet cul de sac opposite Mueller College means it is a great place for the kids to ride their bikes or play out the front of your home, which is great because you can still keep your eyes on them! While you are only 2 minutes' walk from school!

Want more? Location, Location, Location this property has it all, within a few minutes' drive you have access to 4 Shopping centres (The Zone Rothwell, Westfield North Lakes, Peninsular Fair and Deception Bay Shopping Centre), 4 Private schools (Grace Lutheran College, Mueller College, St Benedict's Primary, The Lakes College), 2 New Train Stations coming in 2016 (Rothwell, Kippa-ring), Motorway access, and the Redcliffe Peninsula!

4 BED | 2 BATH | 2 CAR

PRICE:
\$455,000

OPEN FOR INSPECTION:
N/A



Bob Christie
bobchristie@atrealty.com.au
www.atrealty.com.au

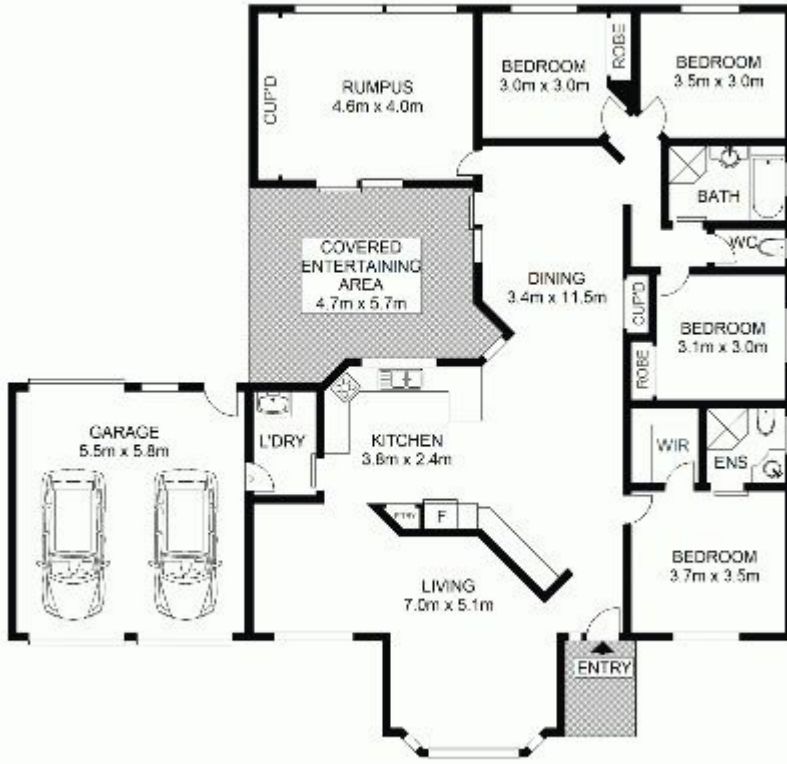

Disclaimer: Please note this floor plan is for marketing purposes and is to be used as a guide only. All dimensions are estimates only and may not be exact measurements.