



SOLD

SPACIOUS NORTH FACING HOME WITH DUAL LIVING FOR EXTENDED FAMILIES

Wanting a home with dual living potential? Then you must see this gorgeous home built around 2017 by Superior Homes on a large 927sqm block in the beautiful golf course estate. Within a short stroll to the Pacific Harbour Golf and Country Club, this is the ideal location. Membership of the Golf & Country Club is included in the purchase and provides access to the pool, tennis court, restaurant & gym.

The home has five bedrooms, open plan kitchen/living/dining, study, games room with kitchenette, multi-purpose room, three bathrooms and double garage. It is the ideal home for extended families as the games room with kitchenette, bathroom, bedroom and study could be used separately.

Flowing out through sliding doors from the living area is the North facing covered outdoor alfresco area overlooking the manicured golf course. A great place to relax after a hard day at golf or work. Look at these additional features:

- Modern spacious kitchen with 900mm gas cooktop, electric oven and walk-in pantry
- Three living areas including open plan kitchen/dining/living, games room and multi-purpose room
- Master bedroom with parent's retreat, walk-in robe and en-suite and four other bedrooms with built-in robes
- Air conditioning to main living area and ceiling fans
- 5 kws solar panels (approx.)
- Large double garage

Don't miss out on this great opportunity. Call Ross Hincksman (your Local Agent) today on 0417 687 379 to arrange your private inspection.

5 BED | 3 BATH | 2 CAR

PRICE:
\$1,370,000

OPEN FOR INSPECTION:
N/A



Geoff and Rose Tutt
0414230130
geoff@atrealty.com.au
www.atrealty.com.au

Door to WC to have hinge pins removable from outside.
Written dimensions take preference over scaled measurements
BUILDER TO CONFIRM ALL DIMENSIONS PRIOR TO CONSTRUCTION

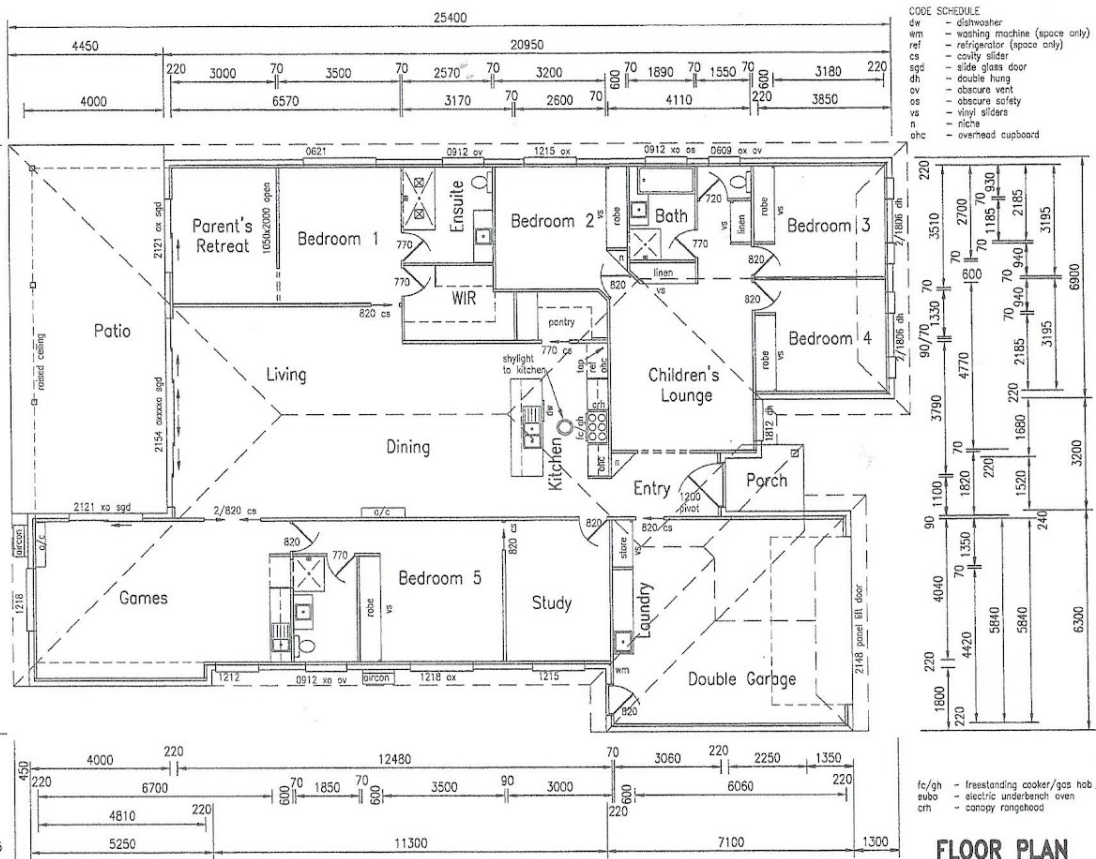
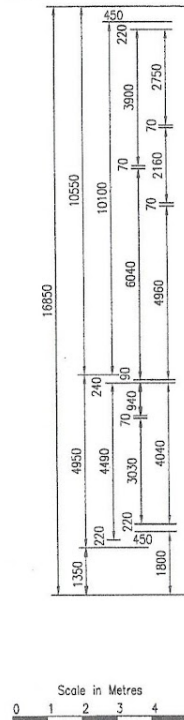

- CODE SCHEDULE
- dw - dishwasher
 - wm - washing machine (space only)
 - ref - refrigerator (space only)
 - cs - cavity slider
 - sgd - slide glass door
 - dh - double hung
 - ov - obscure vent
 - cs - obscure safety
 - vs - vinyl sliders
 - n - niche
 - shc - overhead cupboard

- fc/gh - freestanding cooker/gas hob
- subo - electric underbench oven
- cm - canopy rangehood



FLOOR PLAN

Drawn by Gary Kelly Lic. No. 65688 © Copyright	Project New Dwelling - ID Location Lot 42 Vanillalily Close Banksia Beach Client	Scales 1:100 Sheet 2 of Date 7/2016 Client 1617-008/2	SUPERIOR HOMES Builders of Distinction	15 Telford Place Morayfield 4505 Phone: 0419 632 302 Ph/Fax: (07) 5497 8851 QBSA License No. 080 266 A.B.N. 85 081 194 158
---	---	--	--	---

Disclaimer: Please note this floor plan is for marketing purposes and is to be used as a guide only. All dimensions are estimates only and may not be exact measurements.

Geoff and Rose Tutt
0414230130
geoff@atrealty.com.au
www.atrealty.com.au

