



SOLD

LARGE FAMILY ACREAGE HOME

Looking forward to escaping the suburbs for an acreage lifestyle, now is the time. Available is this executive home which has style and space for all the family.

This large single-level federation-designed home stands out as a shining example of what can be achieved when combining country living with today's modern family living requirements.

The property is located in the Spring Mountain Estate in Greenbank situated in a cul-de-sac with two road access (front and rear access), positioned on 4,345sqm (over 1 acre) of fully fenced land. The magnificent residence is an individually designed and built double brick (cavity brick) framed home sitting on a full concrete slab with screw pier foundations. The home has open plan living spaces, 9 foot ceilings providing great height space and 2 metre wide bullnose verandahs surrounding the home. All rooms, with the exception of the TV area, open out onto the verandah.

Features of the home:

- Four bedrooms, two living/family areas, plus an extra room which can be used as a study, nursery, or quiet reading room
- A separate office
- TV/recreation area
- Enclosed verandah area facing east for morning sun
- Master bedroom with ensuite, walk-in robe, spa bath, large shower area, separate toilet, and its own hot water heater, no sharing hot water
- Three other bedrooms all have built-in wardrobes
- The kitchen includes 2 Pac cupboards and granite bench tops, dishwasher, pyrolytic oven, 90cm ceramic cooktop, walk-in pantry plus a stainless-steel double door fridge with direct water to the fridge
- Main bathroom
- Large laundry
- Large covered alfresco entertainment area overlooking the backyard
- Air conditioning in the main bedroom, lounge and TV area
- Solar Electricity 3.4kw - Fronius 4KW Primo Inverter with monitoring
- Ceiling fans in most rooms
- Wood burning heater in the second living area
- Timber joinery
- 'Crimesafe' doors

4 BED | 2 BATH | 2 CAR

PRICE:
\$1,019

OPEN FOR INSPECTION:
N/A



Lynne Wenban
0409008272
lynnewenban@atrealty.com.au
www.atrealty.com.au

18-20 Echidna Court, Greenbank

 x 4
  x 2
  x 2



Floor Plan
Ground Floor

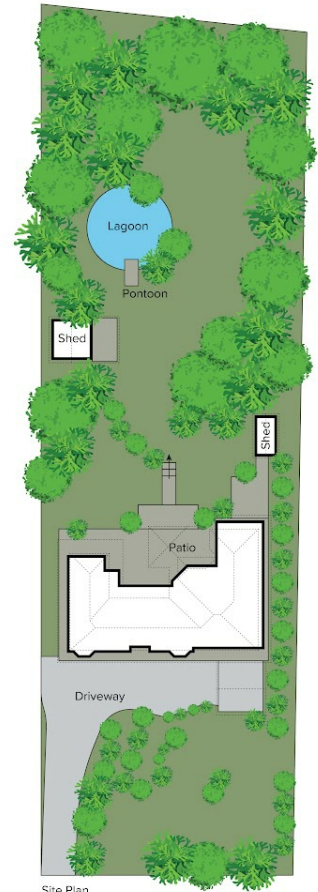

Site Plan
4345m²

Internal: 287m²
 External: 223m²
Total: 510m²

Conditions of use: All floor plan measurements, positions and angles are approximate and for illustrative purposes only. Hausable makes no guarantee as to the accuracy of any measurements, symbols or fixtures as the intent of this floor plan is to indicate the approximate layout of the property only, and must not be relied upon for any other purpose, whatsoever. While every attempt at accuracy is made, potential buyers must seek their own independent professional measurements to determine the homes suitability before purchase. Hausable accepts no responsibility or liability for any loss, however arising, from the use of this floorplan. This floor plan must not be reused, or resold for any reason without prior written consent from Hausable Pty Ltd.

Disclaimer: Please note this floor plan is for marketing purposes and is to be used as a guide only. All dimensions are estimates only and may not be exact measurements.

Lynne Wenban
 0409008272
 lynnewenban@atrealty.com.au
www.atrealty.com.au

