

25 SURREY STREET, HYDE PARK, QLD, 4812

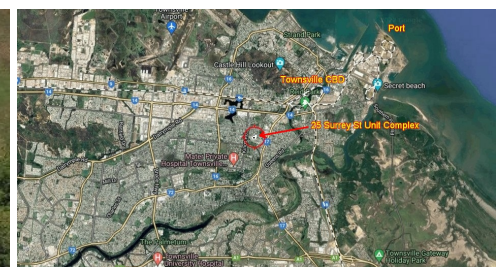

# FOR SALE

## UNIT COMPLEX IN THE HEART OF TOWNSVILLE

Exciting investment opportunity to purchase your very own Unit Complex.

25 Surrey Street Hyde Park consists of 7 x 3 bedroom 2 bathroom Units all with single car accommodation and plenty of safe visitor parking right in the heart of Townsville. Close to major sporting grounds, hospitals, shopping center's and of cause our wonderful Strand these units will always be well sort after and easy to find those great tenants. All properties also have solar and are all fully tenanted if you would like more information on the above property email or call for the full Information memorandum.

0 BED | 0 BATH | 0 CAR

**PRICE:**  
Expressions of Interest

**OPEN FOR INSPECTION:**  
N/A



**Ken Entriken**  
**0419689498**  
kenentriken@atrealty.com.au  
[www.atrealty.com.au](http://www.atrealty.com.au)

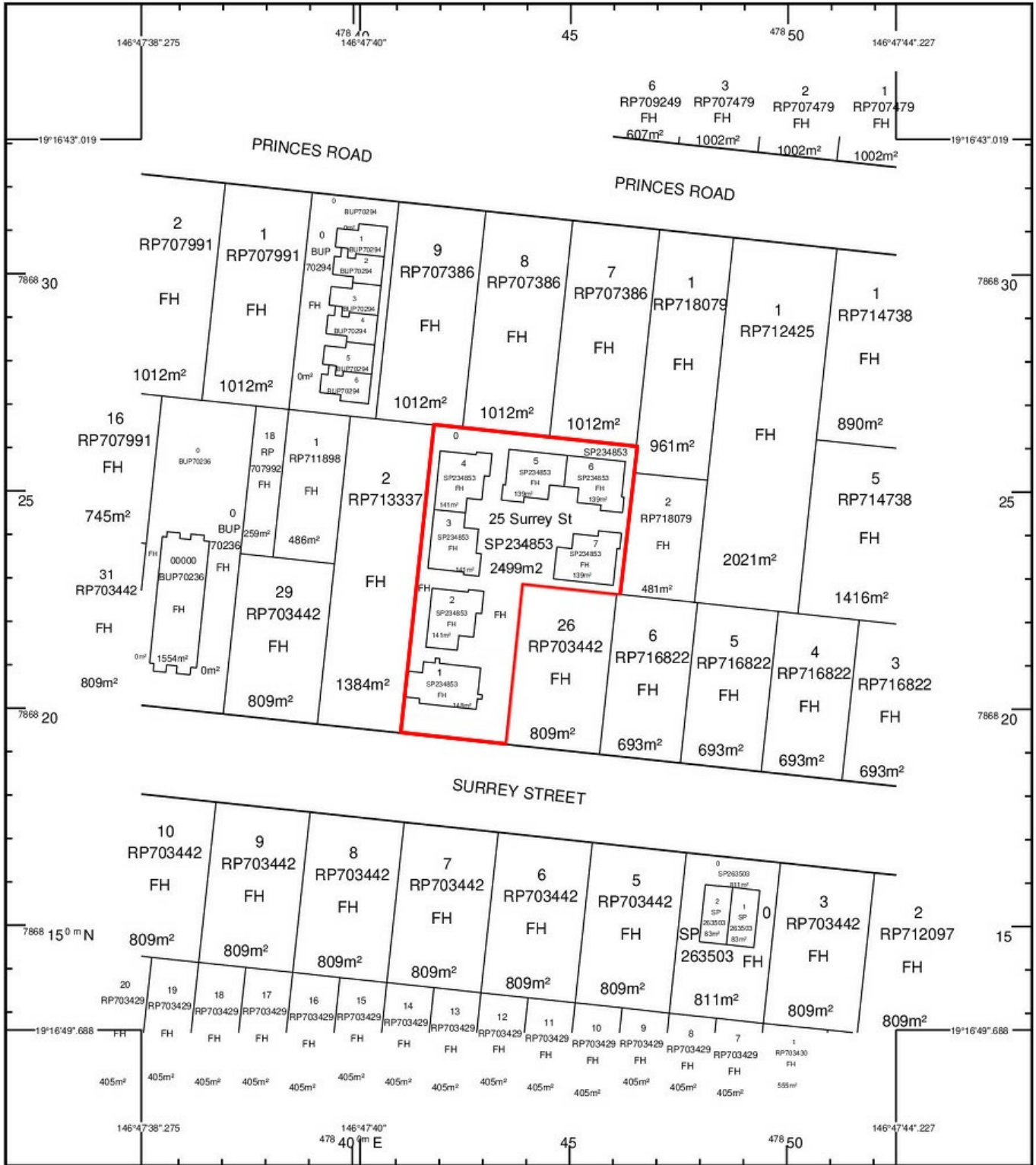

STANDARD MAP NUMBER  
8259-24413



**SmartMap**

An External Product of  
SmartMap Information Services  
Based upon an extraction from the  
Digital Cadastral Data Base

MAP WINDOW POSITION &  
NEAREST LOCATION

146°47'11".251  
19°16'43".354  
HYDE PARK  
0.23 KM

SUBJECT PARCEL DESCRIPTION

DCDB  
Lot/Plan 0/SP234853  
Area/Volume 2499m²

CLIENT SERVICE STANDARDS

PRINTED 16/11/2022

Disclaimer: Please note this floor plan is for marketing purposes and is to be used as a guide only. All dimensions are estimates only and may not be exact measurements.

  
Ken Triken  
0419689498  
kenentriken@atrealty.com.au  
www.atrealty.com.au

Despite Department of Resources best efforts, RESOURCES makes no representations or warranties in relation to the Information, and, to the extent permitted by law, exclude or limit all warranties relating to correctness, accuracy, reliability, completeness or currency and all liability for any direct, indirect and consequential costs, losses, damages and expenses incurred in any way (including but not limited to that arising from negligence) in connection with any use of or reliance on the Information  
For further information on SmartMap products visit  
<https://www.qld.gov.au/housing/buying-owning-home/property-land-valuations/smartmaps>

Queensland  
Government  
(c) The State of Queensland,  
(Department of Resources) 2022.  
