



SOLD

A TRUE BEAUTY

If you're looking for the perfect place to call home, then look no further than this fantastic three bedroom north facing home on a 500m² allotment in a very convenient location.

As soon as you enter the home you will see the excellent presentation on offer. With a great sized formal lounge with access to the garage, three spacious robed bedrooms (the master with ensuite & walk in robe), a hostess kitchen with dishwasher & plenty of bench space, overlooking a large meals/family area. With two separate living areas there is plenty of room to move.

Outside you will find a huge concrete area, the perfect place for a BBQ or to relax with friends over a drink. As you exit into the fully secured back yard, you will find lots of space for the kids to play.

To complete the package the home is finished with quality fixtures and fittings the list goes on with gas ducted heating, split system cooling, ceiling fan, led lights and rear roller door access from the double garage.

The Brindalee Estate is in a fantastic central location. Having its own childcare facility, being close to Medical Centres, also adjoining the Hunt Club Estate which offers numerous parks, Wetlands, walking and bicycle paths as well as a complete range of childcare, primary and secondary schools, Hunt Club Shopping Centre, Cranbourne railway station.

Profitable and move-in ready, this is a great investment or quality family home. Don't delay, let's talk today!

3 BED | 2 BATH | 2 CAR

PRICE:
\$617,000

OPEN FOR INSPECTION:
N/A



Leon D'Penha
0415205032
leon.dpenha@atrealty.com.au
www.atrealty.com.au

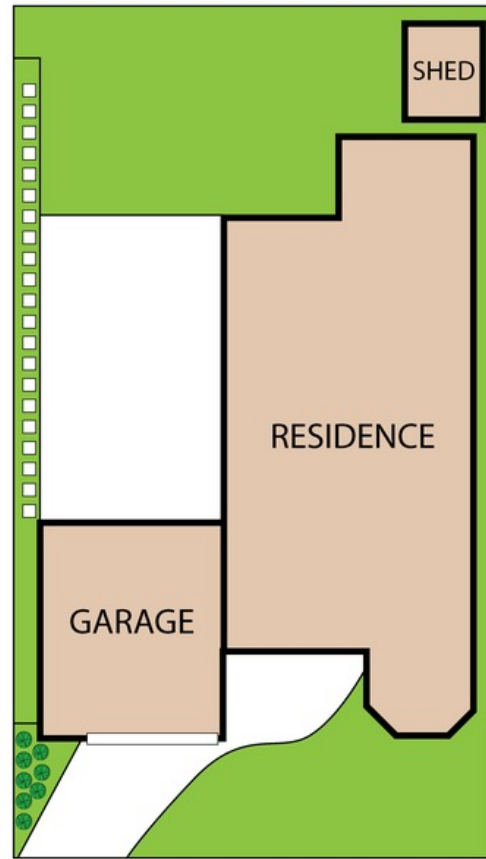
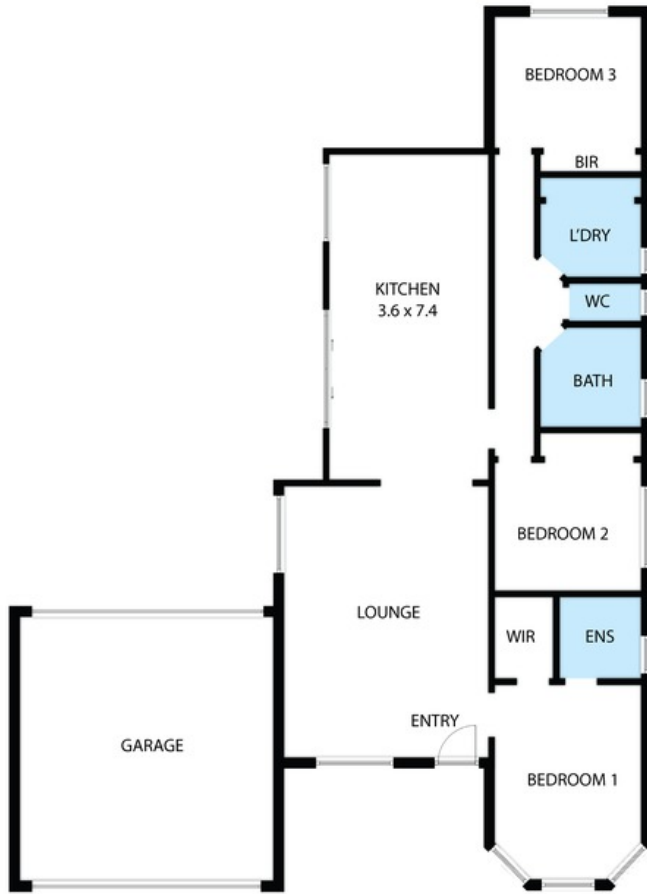

5 Chatham Close, Cranbourne East 3977
TOTAL APPROX. FLOOR AREA 252 SQ.M

Whilst every attempt has been made to ensure the accuracy of the floor plan contained here, measurements of doors, windows, rooms and any other items are approximate and no responsibility is taken for any error, omission, or misstatement. This plan is for illustrative purposes only and should be used as such by any prospective purchaser.

Photography and Floorplans by
VISUAL IMPRESSIONS

Disclaimer: Please note this floor plan is for marketing purposes and is to be used as a guide only. All dimensions are estimates only and may not be exact measurements.

Leon D'Penha
0415205032
leon.dpenha@atrealty.com.au
www.atrealty.com.au

