

34/28 SEDGEMOOR STREET, CARSELDINE, QLD, 4034



SOLD

SOLD BY JOE HAWES - BRISBANE PROPERTY PARTNERS

IF YOU REQUIRE MORE INFORMATION INCLUDING PRICE GUIDE, PLEASE COMPLETE THE ENQUIRY FORM ON THIS LISTING

Located within the tranquil and desirable Limestone Place estate at Carseldine, this very stylish double storey residence is instantly appealing. Standing proudly with an elevated and sunny northerly aspect, and boasting contemporary style with a spacious open-plan layout plus an expansive yard area, this immaculate home assures comfort and practicality for years to come for owner-occupiers, or a solid potential rental yield for astute investors. Only 6 years old, the property's convenient location puts residents within a few minutes' drive of Carseldine train station, major local shopping centres, schools, parks, amenities and transport corridors.

UPSTAIRS

- * Spacious and bright high-set open-plan living with separate dining
- * Smart flowing design opening to a large, covered entertainment deck
- * Elevated district outlook provides a sunny, breezy and private living space
- * Gourmet gas kitchen, island meals counter, stone bench tops, dishwasher
- * Quality faux timber floors, modern decor, air conditioning, ceiling fans
- * Study nook, powder room (third toilet), ample storage
- * Master suite with air conditioning, bathroom with double shower head
- * Extra-large fully fitted mirrored wardrobe

DOWNSTAIRS

- * Three bedrooms, ceiling fans, access to courtyard
- * 2 bedrooms offer fully fitted wardrobes
- * 1 bedroom/office is air conditioned, with separate external access
- * Internal laundry; quality main bathroom with bath
- * Remote lock-up garage with internal access
- * Quality finishes throughout

OUTSIDE

- * Fully fenced, expansive rear/side courtyard, garden, side access
- * Covered single carport plus 3rd car space on the lot

4 BED | 2 BATH | 3 CAR

PRICE:
\$671,000

OPEN FOR INSPECTION:
N/A



Joe Hawes
0405045381
brisbanep@atrealty.com.au
www.atrealty.com.au

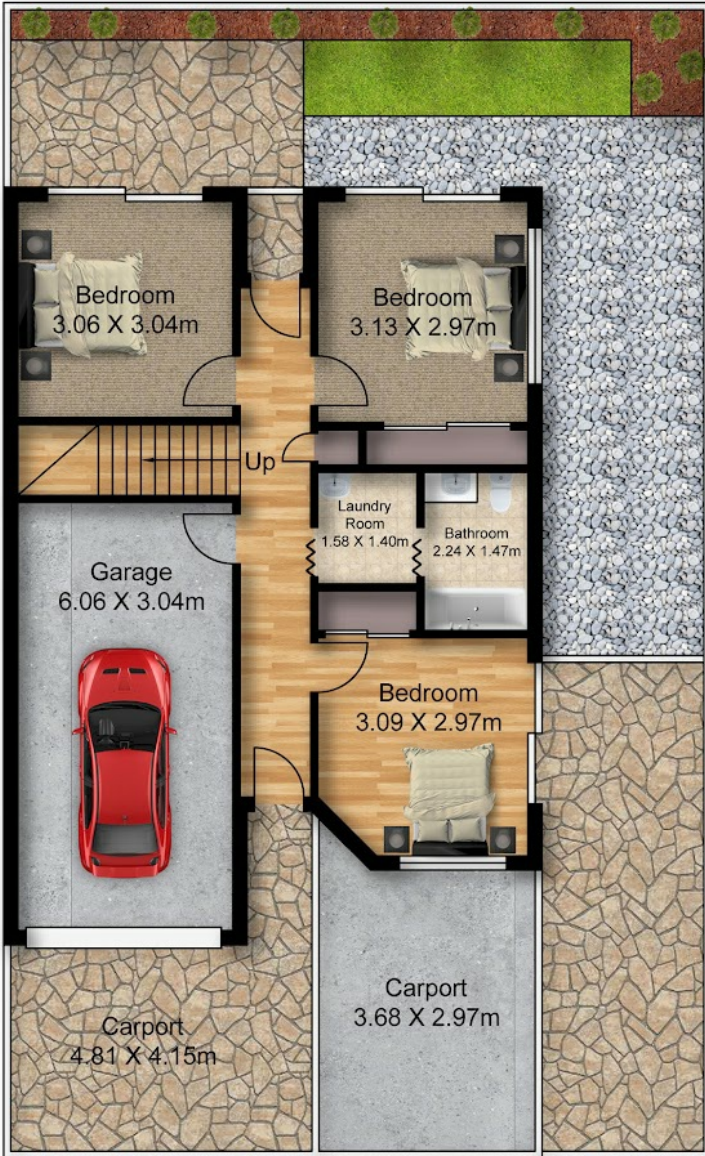

Ground Floor



First Floor

Disclaimer: Please note this floor plan is for marketing purposes and is to be used as a guide only. All dimensions are estimates only and may not be exact measurements.

Approx. Gross Internal Floor Area 1694.24 SQ FT / 157.40 SQM



N